

DATE SUBMITTED: 11-27-90

PERMIT # 37550

FEE \$5.00

# SIGN PERMIT ✓

GRAND JUNCTION PLANNING DEPARTMENT

BUSINESS NAME: All Pets Center

BUSINESS ADDRESS: 429 South 5th Street  
2945-143-40-008

STREET FRONTAGE: FRONT 50 FT. SIDE 125 FT.

BUILDING FRONTAGE: FRONT 50 FT. SIDE 125 FT.

TRAFFIC LANE: FRONT \_\_\_\_\_ FT. SIDE \_\_\_\_\_ FT.

HEIGHT OF SIGN: 8" FT. CLEARANCE TO GRADE: \_\_\_\_\_ FT.

AREA OF SIGN: 6 SQ. FT. AREA OF EXISTING SIGNS: 24 SQ. FT.

TOTAL ALLOWED AREA: FRONT 100 SQ. FT. SIDE \_\_\_\_\_ SQ. FT.

### TYPE OF SIGN

- |  |                                      |
|--|--------------------------------------|
| <input checked="" type="checkbox"/> ON PREMISE | <input type="checkbox"/> ROOF        |
| <input type="checkbox"/> OFF PREMISE           | <input type="checkbox"/> FLUSH WALL  |
| <input type="checkbox"/> FREE STANDING         | <input type="checkbox"/> ILLUMINATED |
| <input checked="" type="checkbox"/> PROJECTING | <input type="checkbox"/> OTHER       |

COMMENTS Painted on fabric  
8" letters

\*SKETCH South Ave

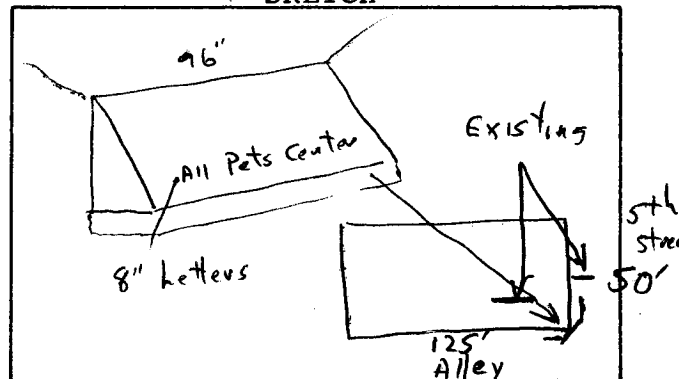

\*Include: Streets, Property Lines, Proposed Sign Location.

PROPERTY OWNER: John C. Heideman

ADDRESS: 3012 Poppy Court

CONTRACTOR: Canvas Products Co

ADDRESS: 588 25 Road GS

PHONE: 242-1453

[Signature]  
Signature

APPROVED BY: [Signature]

DATE APPROVED: NOV. 27, 1990

- FINAL PERMIT
- WILL REQUIRE SEPARATE PERMIT

Cannex Products Company  
588 25 Road  
Grand Junction, Colo 81505  
Tom Ogata  
242-1953

Bill Pele Center  
424 South 5th Street  
Grand Junction, Co 81501  
241-1976

(5 Each)

Fabric  
Sumbrella - pochey Red

