

DATE SUBMITTED: 4/13/90

PERMIT # _____

TAX SCHEDULE #: _____

FEE 25.00

SIGN PERMIT ✓

GRAND JUNCTION PLANNING DEPARTMENT

2945-033-07-027

BUSINESS NAME: GRAND JUNCTION VALLEY AGENCY, INC.

BUSINESS ADDRESS: 604-25 ROAD

(25-ROAD)

(F-ROAD)

STREET FRONTAGE: FRONT 140 FT. SIDE 250 FT.

BUILDING FRONTAGE: FRONT 0 FT. SIDE 0 FT.

TRAFFIC LANE: FRONT 2 FT. SIDE 4 FT.

HEIGHT OF SIGN: 25 FT. CLEARANCE TO GRADE: 15 FT.

AREA OF SIGN: 300 SQ. FT. AREA OF EXISTING SIGNS: _____ SQ. FT.

TOTAL ALLOWED AREA: FRONT _____ SQ. FT. SIDE _____ SQ. FT.

TYPE OF SIGN

- | | |
|---|---|
| <input type="checkbox"/> ON PREMISE | <input type="checkbox"/> ROOF |
| <input checked="" type="checkbox"/> OFF PREMISE | <input type="checkbox"/> FLUSH WALL |
| <input type="checkbox"/> FREE STANDING | <input checked="" type="checkbox"/> ILLUMINATED |
| <input type="checkbox"/> PROJECTING | <input type="checkbox"/> OTHER |

COMMENTS _____

1/4 mile + 90 nearest other signs

*SKETCH

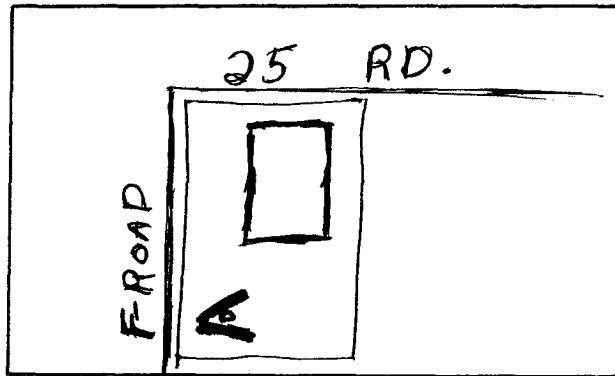

*Include: Streets, Property Lines, Proposed Sign Location.

PROPERTY OWNER: Alco Building Co., Inc.

ADDRESS: 599-25 Road

CONTRACTOR: Western Neon Co.

ADDRESS: 2483 Commerce Blvd.

PHONE: 242-7843

Jim Cook
Signature

APPROVED BY: Hank Metzger

DATE APPROVED: 4/19/90

- FINAL PERMIT
- WILL REQUIRE SEPARATE PERMIT