

DATE SUBMITTED: 10-19-90

PERMIT # \_\_\_\_\_

TAX SCHEDULE #: 2945114-18-012

FEE 10.00

# SIGN PERMIT ✓

GRAND JUNCTION PLANNING DEPARTMENT

BUSINESS NAME: DOROTHY'S DINER

BUSINESS ADDRESS: 710 NORTH AVE.

STREET FRONTAGE: North Ave FRONT 145' FT. SIDE 130' FT.

BUILDING FRONTAGE: FRONT 50' FT. SIDE 75' FT.

TRAFFIC LANE: FRONT 4 FT. SIDE 4 FT.

HEIGHT OF SIGN: 25' FT. CLEARANCE TO GRADE: 13'-0" FT.

AREA OF SIGN: 144 SQ. FT. AREA OF EXISTING SIGNS: ~~144~~ SQ. FT.

TOTAL ALLOWED AREA: FRONT 217.5 SQ. FT. SIDE 195 SQ. FT.

### TYPE OF SIGN

- |   |   |
|---|---|
| <input checked="" type="checkbox"/> ON PREMISE    | <input type="checkbox"/> ROOF                   |
| <input type="checkbox"/> OFF PREMISE              | <input type="checkbox"/> FLUSH WALL             |
| <input checked="" type="checkbox"/> FREE STANDING | <input checked="" type="checkbox"/> ILLUMINATED |
| <input type="checkbox"/> PROJECTING               | <input type="checkbox"/> OTHER                  |

COMMENTS REPAINT FACES IN EXISTING SIGN ONLY.

### \*SKETCH

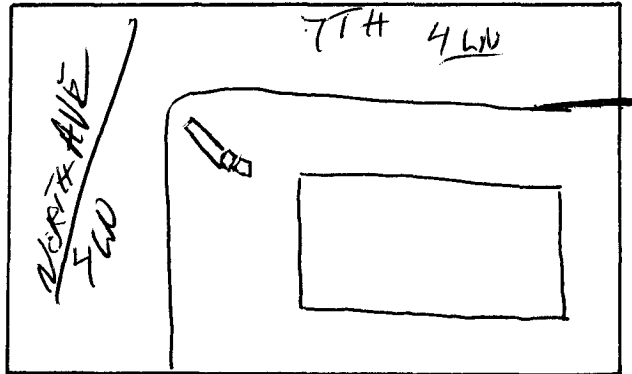

\*Include: Streets, Property Lines, Proposed Sign Location.

PROPERTY OWNER: CONNIE + CHRIS JOUFLAS

ADDRESS: 710 NORTH AVE.

CONTRACTOR: WESTERN NEON SIGNS

ADDRESS: 2495 INDUSTRIAL BLVD.

PHONE: 242-7843

Mark W Smith  
Signature

APPROVED BY: Kathy Poston

DATE APPROVED: 10/19/90

Did not change existing electrical -> repainted face only. Does not require a separate permit as per Bldg Dept.

- |  |
|--|
| <input checked="" type="checkbox"/> FINAL PERMIT                 |
| <input checked="" type="checkbox"/> WILL REQUIRE SEPARATE PERMIT |

25' OVERALL

10'

$$= \begin{array}{r} 120 \text{ 中} \\ 24 \text{ 中} \\ \hline 144 \text{ 中} \end{array}$$

PINK BLUE OF

$$\begin{array}{r} 144 \\ 18 \\ \hline 162 \end{array}$$

4x

$$6' = 24 \text{ 中}$$

Dorothy's  
DINER

there's no place like home

