

DATE SUBMITTED: 1-27-90

PERMIT # _____

FEE \$5⁰⁰

SIGN PERMIT ✓

GRAND JUNCTION PLANNING DEPARTMENT

BUSINESS NAME: PEACH TREE INN

BUSINESS ADDRESS: 1600 North Ave

STREET FRONTAGE: FRONT 160 FT. SIDE 260 FT.

BUILDING FRONTAGE: FRONT 160 FT. SIDE 260 FT.

TRAFFIC LANE: FRONT 4 FT. SIDE 2 FT.

HEIGHT OF SIGN: 11 1/2 FT. CLEARANCE TO GRADE: 8 FT.

AREA OF SIGN: 35 SQ. FT. AREA OF EXISTING SIGNS: 96 SQ. FT.

TOTAL ALLOWED AREA: FRONT 200 SQ. FT. SIDE 390 SQ. FT.

TYPE OF SIGN

- ON PREMISE
- OFF PREMISE
- FREE STANDING
- PROJECTING
- ROOF
- FLUSH WALL
- ILLUMINATED
- OTHER

COMMENTS S/F Plex-illum sign

*SKETCH

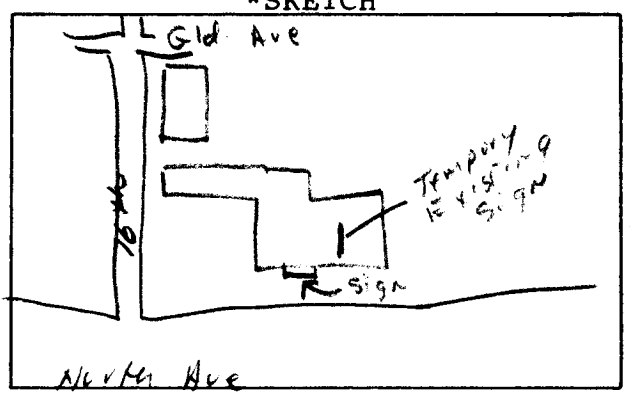

*Include: Streets, Property Lines, Proposed Sign Location.

PROPERTY OWNER: JAN Eitel

ADDRESS: 1600 North Ave

CONTRACTOR: BENTON Sign & Lighting

ADDRESS: 288 I-70 Bus loop

PHONE: 243-8629

[Signature]
Signature

APPROVED BY: Linda Wutzel

DATE APPROVED: 1-29-90

- FINAL PERMIT
- WILL REQUIRE SEPARATE PERMIT