

DATE SUBMITTED: 4-27-90

PERMIT # _____

FEE 10⁰⁰

2945-133-15-020

SIGN PERMIT ✓

GRAND JUNCTION PLANNING DEPARTMENT

BUSINESS NAME: Mountain West Office Products

BUSINESS ADDRESS: 1649 Main Street

STREET FRONTAGE: FRONT ^{17th} 120 FT. SIDE ^{MAIN} ~~80~~ 88 FT.

BUILDING FRONTAGE: FRONT 86 FT. SIDE 50 FT. ¹⁰⁰

TRAFFIC LANE: FRONT _____ FT. SIDE _____ FT.

HEIGHT OF SIGN: 27 FT. CLEARANCE TO GRADE: _____ FT.

AREA OF SIGN: 60 SQ. FT. AREA OF EXISTING SIGNS: 27 SQ. FT.

TOTAL ALLOWED AREA: FRONT 172 SQ. FT. SIDE 100 SQ. FT.

TYPE OF SIGN

- ON PREMISE
- OFF PREMISE
- FREE STANDING
- PROJECTING
- ROOF
- FLUSH WALL
- ILLUMINATED
- OTHER

COMMENTS _____

*SKETCH

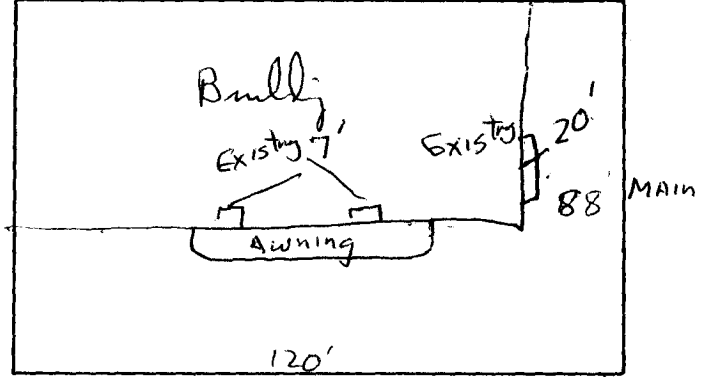

*Include: Streets, Property ^{17th} Lines, Proposed Sign Location.

PROPERTY OWNER: Larry Klausner

ADDRESS: 665 Round Hill

CONTRACTOR: Canvas Products

ADDRESS: 588 25 Rd GJ

PHONE: 292-1953

Jan Oldb
Signature

APPROVED BY: Linda Witzel

DATE APPROVED: 4-27-90

- FINAL PERMIT
- WILL REQUIRE SEPARATE PERMIT

Mountain
West
Pure
Tobacco

COLORS

38 1/2"