

DATE SUBMITTED: 10/10/90

PERMIT # _____

TAX SCHEDULE #: 2945-122-00-156

FEE 10.00

SIGN PERMIT ✓

GRAND JUNCTION PLANNING DEPARTMENT

BUSINESS NAME: Community Professional Plaza

BUSINESS ADDRESS: 2000 N 12th

STREET FRONTAGE: 12th FRONT 96' FT. SIDE 220' FT.

BUILDING FRONTAGE: FRONT ~~60~~ 85' FT. SIDE 126' FT.

TRAFFIC LANE: FRONT 4 LANE FT. SIDE 2 LN FT.

HEIGHT OF SIGN: 14' FT. CLEARANCE TO GRADE: 0 FT.

AREA OF SIGN: 96 SQ. FT. AREA OF EXISTING SIGNS: 0 SQ. FT.

TOTAL ALLOWED AREA: FRONT 144 SQ. FT. SIDE _____ SQ. FT.

TYPE OF SIGN

- | | |
|---|---|
| <input type="checkbox"/> ON PREMISE | <input type="checkbox"/> ROOF |
| <input type="checkbox"/> OFF PREMISE | <input type="checkbox"/> FLUSH WALL |
| <input checked="" type="checkbox"/> FREE STANDING | <input checked="" type="checkbox"/> ILLUMINATED |
| <input type="checkbox"/> PROJECTING | <input type="checkbox"/> OTHER |

COMMENTS _____

*SKETCH

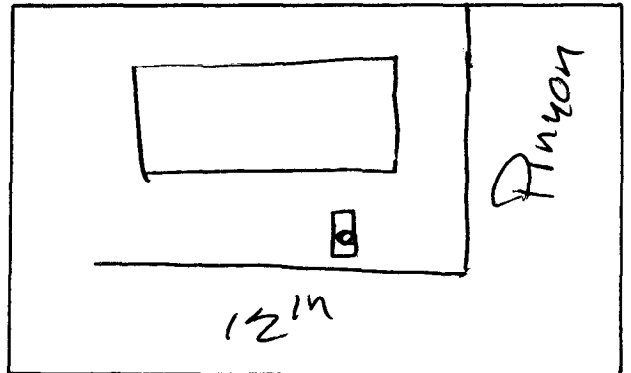

*Include: Streets, Property Lines, Proposed Sign Location.

PROPERTY OWNER: Community Hospital

ADDRESS: ~~200~~ 2021 N. 12th

CONTRACTOR: Sign Designs

ADDRESS: 688 30 RD

PHONE: 434-0939

[Signature]
Signature

APPROVED BY: [Signature]

DATE APPROVED: 10/10/90

- FINAL PERMIT
- WILL REQUIRE SEPARATE PERMIT
check with bldg dept-