

DATE SUBMITTED: 10/26/90
TAX SCHEDULE #: 2945-033-07-030

PERMIT # _____
FEE 5.00

SIGN PERMIT ✓

GRAND JUNCTION PLANNING DEPARTMENT

BUSINESS NAME: United Cable T.V.

BUSINESS ADDRESS: 2502 FORESIGHT Cir

STREET FRONTAGE: FRONT 198 FT. 25th SIDE 273 FT.

BUILDING FRONTAGE: FRONT 100 FT. SIDE 129 FT.

TRAFFIC LANE: FRONT 4 FT. SIDE X 2 FT.

HEIGHT OF SIGN: 3 FT. CLEARANCE TO GRADE: 2 FT.

AREA OF SIGN: 27 SQ. FT. AREA OF EXISTING SIGNS: ~~50.75~~ SQ. FT.

TOTAL ALLOWED AREA: FRONT 297 SQ. FT. SIDE _____ SQ. FT.

TYPE OF SIGN

- | | |
|---|--------------------------------------|
| <input checked="" type="checkbox"/> ON PREMISE | <input type="checkbox"/> ROOF |
| <input type="checkbox"/> OFF PREMISE | <input type="checkbox"/> FLUSH WALL |
| <input checked="" type="checkbox"/> FREE STANDING | <input type="checkbox"/> ILLUMINATED |
| <input type="checkbox"/> PROJECTING | <input type="checkbox"/> OTHER |

COMMENTS ALL EXISTING SIGNAGE
is being removed

*SKETCH

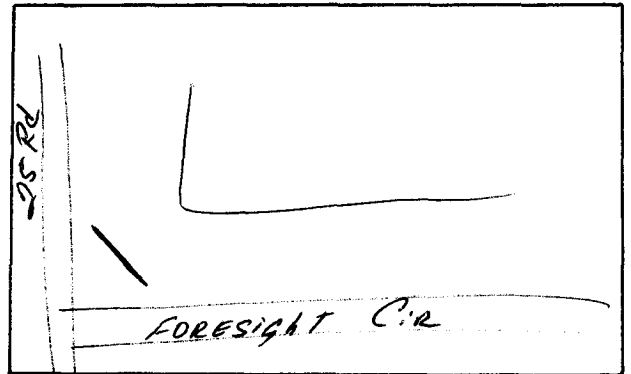

*Include: Streets, Property Lines, Proposed Sign Location.

PROPERTY OWNER: COMTRONICS CABLE
ADDRESS: PO Box 2798 LITTLETON, CO 80161
CONTRACTOR: Grand Jct Co
ADDRESS: 2915 Hill
PHONE: 245-2950

Barbara Paltua
Signature

APPROVED BY: Kathy Paltua
DATE APPROVED: 10/26/90

29-00244

- | | |
|-------------------------------------|------------------------------|
| <input checked="" type="checkbox"/> | FINAL PERMIT |
| <input type="checkbox"/> | WILL REQUIRE SEPARATE PERMIT |

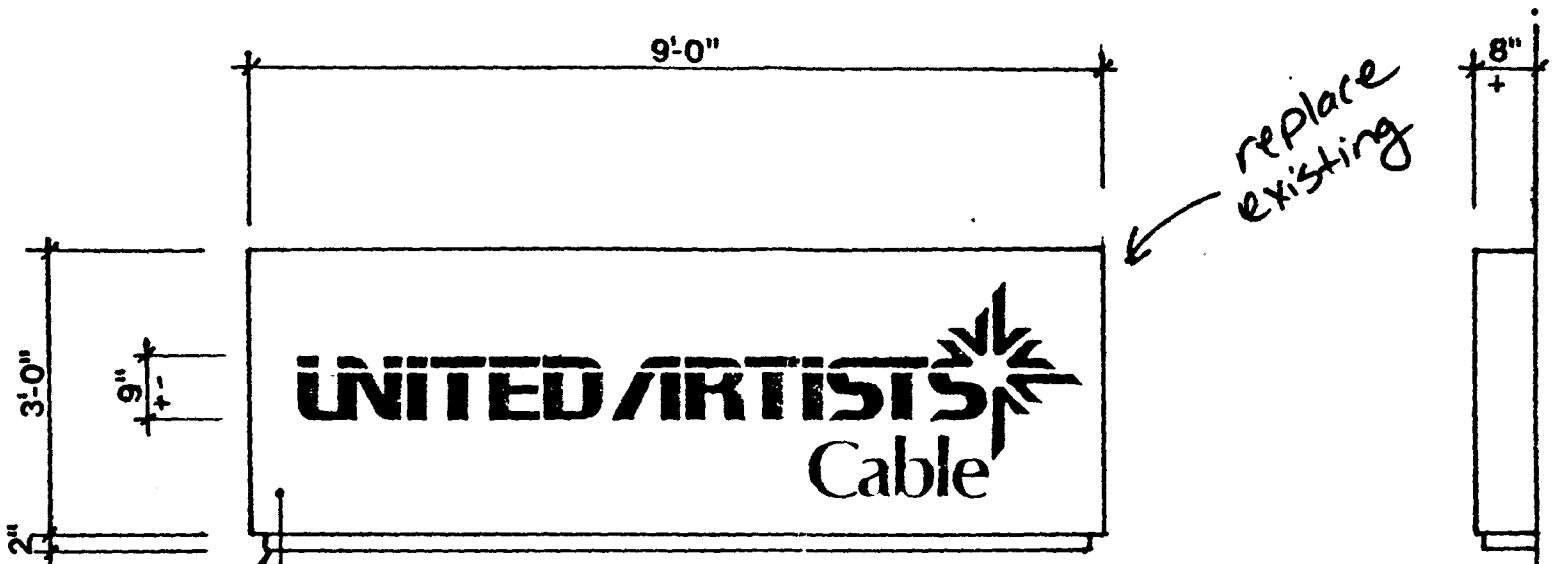

Extruded Aluminum Cabinet with 1/8" Overlay Aluminum Face. Cabinet and Face Painted Black Imron, Satin Finish. Routed Copy and Logo. Back Routed Copy with Bright Gold Anodized Perforated Aluminum. Back Aluminum with White Plexiglas.
 T-12 800 M.A.H.O. Lamp Illumination.
 Face Reveal with Brite Gold Anodized Aluminum.

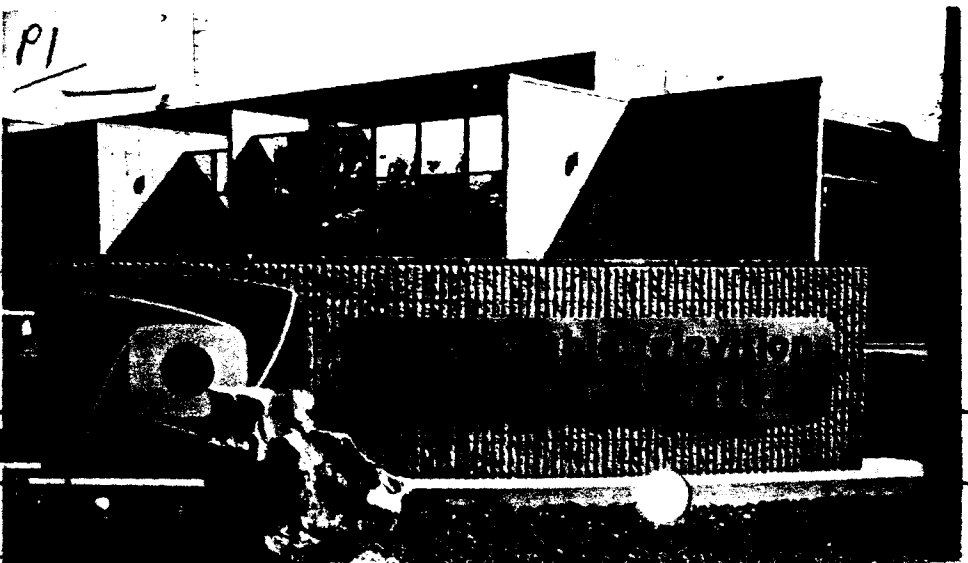

Single Face Ill

Gordon Sign Company