

DATE SUBMITTED: 8-24-90

PERMIT # _____

TAX SCHEDULE #: 2945-141-06-022

FEE \$ 500

SIGN PERMIT ✓

GRAND JUNCTION PLANNING DEPARTMENT

BUSINESS NAME: Miracle Ear

BUSINESS ADDRESS: 1460 N. 12th Grand Junction, Co. 81501

STREET FRONTAGE: FRONT 154 FT. SIDE 206 FT.

BUILDING FRONTAGE: FRONT 102 FT. SIDE 119 FT.

TRAFFIC LANE: FRONT 4 Lane FT. SIDE 2 Lane FT.

HEIGHT OF SIGN: 6' High x 3' wide FT. CLEARANCE TO GRADE: Flush Wall FT.

AREA OF SIGN: 18 SQ. FT. AREA OF EXISTING SIGNS: 6 SQ. FT.

TOTAL ALLOWED AREA: FRONT 204 SQ. FT. SIDE 238 SQ. FT.

TYPE OF SIGN

- ON PREMISE
- OFF PREMISE
- FREE STANDING
- PROJECTING
- ROOF
- FLUSH WALL
- ILLUMINATED
- OTHER

COMMENTS 6' High x 3' wide wall mount sign on southern most wall surface

*SKETCH

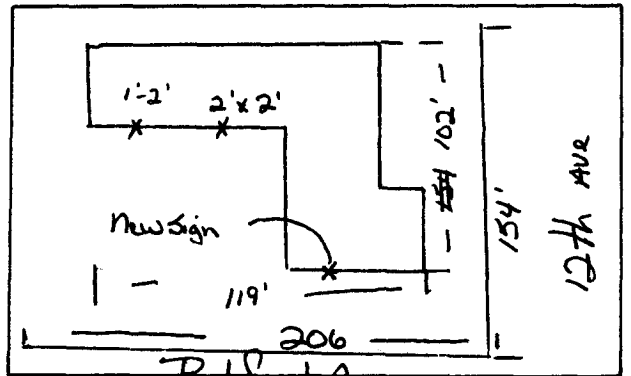

*Include: Streets, Property Lines, Proposed Sign Location.

PROPERTY OWNER: M.J. Benton

ADDRESS: 336 Belair, Grand Junction, Co. 81501

CONTRACTOR: Grand Junction Sign & Neon

ADDRESS: 2915 Hill G.J. Co. 81504

PHONE: 945-2950

[Signature]
Signature

APPROVED BY: [Signature]

DATE APPROVED: Aug 24, 1990

Miracle-Ear

- FINAL PERMIT
- WILL REQUIRE SEPARATE PERMIT