

DATE SUBMITTED: 9-5-90
TAX SCHEDULE #: 2945-103-00-056

PERMIT # _____
FEE 10⁰⁰

SIGN PERMIT ✓

GRAND JUNCTION PLANNING DEPARTMENT

BUSINESS NAME: VALLEY GAS + WELDING SUPPLY
BUSINESS ADDRESS: 2510 1/2 Hwy. 6 + 50

STREET FRONTAGE: FRONT 200 FT. ~~300~~ SIDE 252 FT.
BUILDING FRONTAGE: FRONT 145 FT. ~~290~~ SIDE 42 FT.
TRAFFIC LANE: FRONT _____ FT. SIDE _____ FT.
HEIGHT OF SIGN: ~~35~~ 15 FT. CLEARANCE TO GRADE: ~~35~~ 5 FT.
AREA OF SIGN: 60 SQ. FT. AREA OF EXISTING SIGNS: NONE SQ. FT.
TOTAL ALLOWED AREA: FRONT _____ SQ. FT. SIDE _____ SQ. FT.

TYPE OF SIGN

- | | |
|---|---|
| <input checked="" type="checkbox"/> ON PREMISE | <input type="checkbox"/> ROOF |
| <input type="checkbox"/> OFF PREMISE | <input type="checkbox"/> FLUSH WALL |
| <input checked="" type="checkbox"/> FREE STANDING | <input type="checkbox"/> ILLUMINATED |
| <input type="checkbox"/> PROJECTING | <input checked="" type="checkbox"/> OTHER |

COMMENTS NON-ILLUMINATED
METAL SIGN ON PIPE

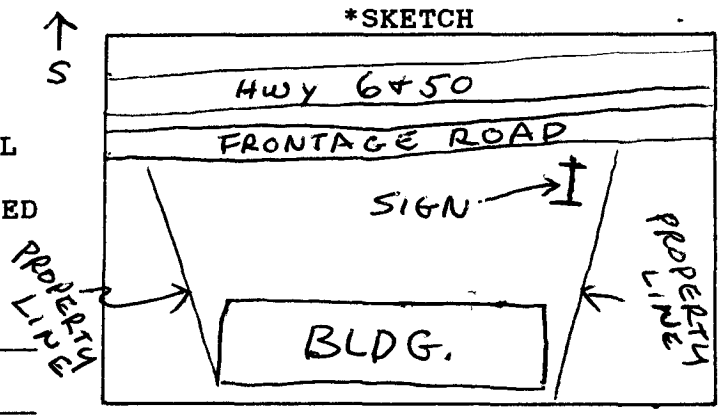

*Include: Streets, Property Lines, Proposed Sign Location.

Karl Jones
Signature

PROPERTY OWNER: VALLEY GAS + WELDING
ADDRESS: 2510 1/2 Hwy. 6 + 50
CONTRACTOR: WESTERN NEON SIGNS
ADDRESS: 2483 COMMERCE BLVD.
PHONE: 242-7843

APPROVED BY: Shirley Wertz
DATE APPROVED: 9-5-90

- FINAL PERMIT
 WILL REQUIRE SEPARATE PERMIT