

DATE SUBMITTED: 11-2-90
TAX SCHEDULE #: 2943-182-00-012

PERMIT # _____
FEE 5⁰⁰

SIGN PERMIT

GRAND JUNCTION PLANNING DEPARTMENT

Elect. Lic #3734
Certified Electrician

BUSINESS NAME: Juggs Lounge

BUSINESS ADDRESS: 2825 North Ave

STREET FRONTAGE: FRONT 96 FT. SIDE ~~313~~ 270 FT.

BUILDING FRONTAGE: FRONT 80 FT. SIDE 63 FT.

TRAFFIC LANE: FRONT 4 FT. SIDE 2 FT.

HEIGHT OF SIGN: 19' FT. CLEARANCE TO GRADE: 16' FT.

AREA OF SIGN: 17 1/2 SQ. FT. AREA OF EXISTING SIGNS: 20 SQ. FT.

TOTAL ALLOWED AREA: FRONT ~~148~~ 144 SQ. FT. SIDE ~~254 3/4~~ 202.5 SQ. FT.

TYPE OF SIGN

- ON PREMISE
- OFF PREMISE
- FREE STANDING
- PROJECTING
- ROOF
- FLUSH WALL
- ILLUMINATED
- OTHER

COMMENTS _____

*SKETCH

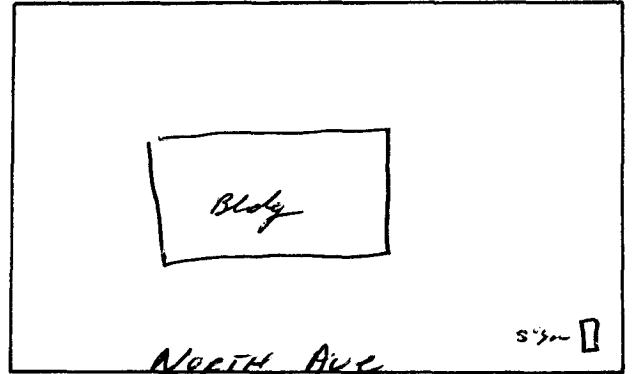

*Include: Streets, Property Lines, Proposed Sign Location.

PROPERTY OWNER: William Anderson
Jim Juggler

ADDRESS: Grand Junction, Colo.

CONTRACTOR: BENTON SIGNS

ADDRESS: 2850 I-70 Bus Loop

PHONE: 243-8629

James L. Bent
Signature

APPROVED BY: Paul [Signature]

DATE APPROVED: 11-3-90

Lic # 2890499

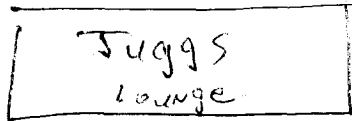

- FINAL PERMIT
- WILL REQUIRE SEPARATE PERMIT