

DATE SUBMITTED: 5/1/90

PERMIT # _____

FEE 5⁰⁰

SIGN PERMIT

GRAND JUNCTION PLANNING DEPARTMENT

BUSINESS NAME: BEST BUY AUTO SALES

BUSINESS ADDRESS: 2906 NORTH AVE.

STREET FRONTAGE: Nth FRONT 216 FT. 29th SIDE 162 FT.

BUILDING FRONTAGE: Nth FRONT 56 FT. 29th SIDE 35 FT.

TRAFFIC LANE: FRONT _____ FT. SIDE _____ FT.

HEIGHT OF SIGN: 12 FT. CLEARANCE TO GRADE: 8 FT.

AREA OF SIGN: 20 SQ. FT. AREA OF EXISTING SIGNS: _____ SQ. FT.

TOTAL ALLOWED AREA: FRONT 324 SQ. FT. SIDE 121.5 SQ. FT.

TYPE OF SIGN

- ON PREMISE
- OFF PREMISE
- FREE STANDING
- PROJECTING
- ROOF
- FLUSH WALL
- ILLUMINATED
- OTHER

COMMENTS SIGNAGE TO BE ON THE FACE OF
LIGHTED AWNING

*SKETCH

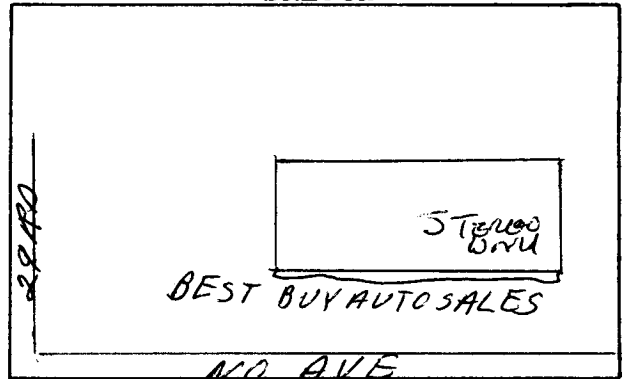

*Include: Streets, Property Lines, Proposed Sign Location.

PROPERTY OWNER: JAMES FLYNN

ADDRESS: 165 WILLOWBROOK

CONTRACTOR: GIFFORD PRODUCTS dba CANVAS SPEC.

ADDRESS: 580 N. WESTGATE

PHONE: 242-8121

[Signature]
Signature

APPROVED BY: Linda Wetzel

DATE APPROVED: 5-1-90

- FINAL PERMIT
- WILL REQUIRE SEPARATE PERMIT