

DATE SUBMITTED: 8-27-90

PERMIT # \_\_\_\_\_

TAX SCHEDULE #: 2943-083-12-001

FEE \$ 500

# SIGN PERMIT

GRAND JUNCTION PLANNING DEPARTMENT

BUSINESS NAME: Stereo Warehouse

BUSINESS ADDRESS: 2906 North Ave G.J. Co. 81504

STREET FRONTAGE: FRONT 125' FT. SIDE 100' FT.

BUILDING FRONTAGE: FRONT 57' FT. SIDE 37' FT.

TRAFFIC LANE: FRONT 4 Lane FT. SIDE 2 Lane FT.

HEIGHT OF SIGN: 18'6" - 12' FT. CLEARANCE TO GRADE: 17' FT.

AREA OF SIGN: 20' SQ. FT. AREA OF EXISTING SIGNS: 61 SQ. FT.

TOTAL ALLOWED AREA: FRONT 187.5 SQ. FT. SIDE 74' SQ. FT.

### TYPE OF SIGN

- ON PREMISE
- OFF PREMISE
- FREE STANDING
- PROJECTING
- ROOF
- FLUSH WALL
- ILLUMINATED
- OTHER

### \*SKETCH

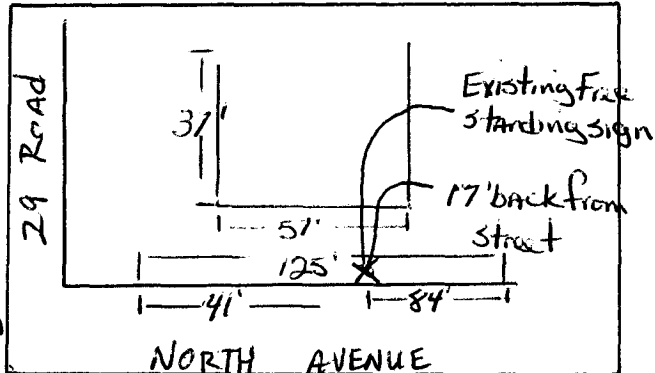

COMMENTS Add 4'x5' to sided sign to existing Free standing sign. Total present Free standing square footage is 25' Sq Ft

\*Include: Streets, Property Lines, Proposed Sign Location.

PROPERTY OWNER: James M. Flynn

ADDRESS: 165 Willowbrook Drive G.J. 81506

CONTRACTOR: Grand Junction Sign & Neon

ADDRESS: 2915 Hill Ave, G.J. Co 81504

PHONE: 245-2950

John O. Abraham  
Signature

APPROVED BY: [Redacted]

DATE APPROVED: Aug. 27, 1990

STEREO WAREHOUSE  
PIONEER CLATION  
PANASONIC

- FINAL PERMIT
- WILL REQUIRE SEPARATE PERMIT