

DATE SUBMITTED: June 20, 91

PERMIT # _____

TAX SCHEDULE #: 2945-123-21-007

FEE \$5.00

SIGN PERMIT

GRAND JUNCTION PLANNING DEPARTMENT

BUSINESS NAME: THE WESTERN WIKWAM

BUSINESS ADDRESS: 1560 NORTH AVE UNIT C

STREET FRONTAGE: FRONT 20'8" FT. SIDE 0 FT.

BUILDING FRONTAGE: FRONT 49' FT. SIDE _____ FT.

TRAFFIC LANE: FRONT _____ FT. SIDE _____ FT.

HEIGHT OF SIGN: 4' FT. CLEARANCE TO GRADE: _____ FT.

AREA OF SIGN: 27 SQ. FT. AREA OF EXISTING SIGNS: _____ SQ. FT.

TOTAL ALLOWED AREA: FRONT 40 SQ. FT. SIDE _____ SQ. FT.

TYPE OF SIGN

- ON PREMISE
- OFF PREMISE
- FREE STANDING
- PROJECTING
- ROOF
- FLUSH WALL
- ILLUMINATED
- OTHER

COMMENTS _____

*SKETCH

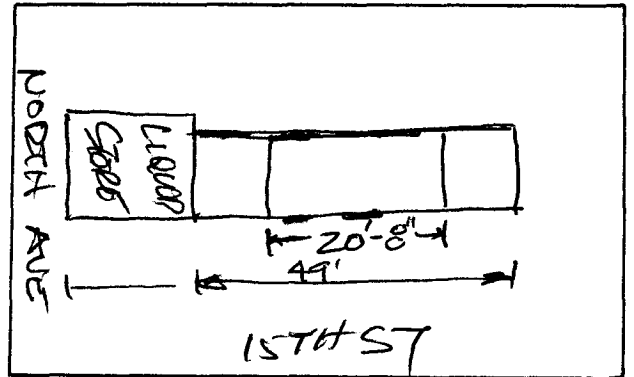

*Include: Streets, Property Lines, Proposed Sign Location.

PROPERTY OWNER: JAN ERTL

ADDRESS: 1600 NORTH AVE G.J.

CONTRACTOR: SIENPRO

ADDRESS: 805 SOUTH AVE G.J.

PHONE: 242-1111

[Signature]
Signature

APPROVED BY: Kristen K. Adhede

DATE APPROVED: 6/20/91

- FINAL PERMIT
- WILL REQUIRE SEPARATE PERMIT

* Need to see Building Dept