

DATE SUBMITTED: 1-14-91

PERMIT # _____

FEE \$ 10⁰⁰

SIGN PERMIT

GRAND JUNCTION PLANNING DEPARTMENT

Elect. Existing
No Need Survey

BUSINESS NAME: Angie Jeans

BUSINESS ADDRESS: 2560 North Ave

STREET FRONTAGE: FRONT 100' FT. SIDE X FT.

BUILDING FRONTAGE: FRONT 50' FT. SIDE X FT.

TRAFFIC LANE: FRONT 4' FT. SIDE X FT.

HEIGHT OF SIGN: 20' FT. CLEARANCE TO GRADE: 10' FT.

AREA OF SIGN: 100 SQ. FT. AREA OF EXISTING SIGNS: 0 SQ. FT.

TOTAL ALLOWED AREA: FRONT 150 SQ. FT. SIDE X SQ. FT.

TYPE OF SIGN

- ON PREMISE
- OFF PREMISE
- FREE STANDING
- PROJECTING
- ROOF
- FLUSH WALL
- ILLUMINATED
- OTHER

COMMENTS EXISTING, D/E Pole sign
name change only.

*SKETCH

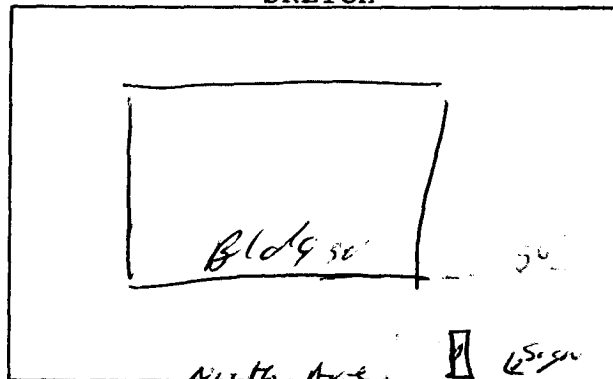

*Include: Streets, Property Lines, Proposed Sign Location.

PROPERTY OWNER: Mark Parlor

ADDRESS: 2560 North Ave

CONTRACTOR: BENTON Signs

ADDRESS: 2850 I-70 Bus Loop

PHONE: 243 8629

Lic # 2900421

[Signature]
Signature

APPROVED BY: [Signature]

DATE APPROVED: 1-14-91

- FINAL PERMIT
- WILL REQUIRE SEPARATE PERMIT

RESTAURANT

Andie Jean's

COCKTAILS