

DATE SUBMITTED: 5-28-91

PERMIT # _____

TAX SCHEDULE #: 294318100056

FEE \$500

SIGN PERMIT

GRAND JUNCTION PLANNING DEPARTMENT

BUSINESS NAME: J & S FENCE Co.

BUSINESS ADDRESS: 2886 I-70 BUSINESS LOOP, GRAND JUNCTION, CO.

STREET FRONTAGE: FRONT 112 FT. SIDE 388.9 FT.

BUILDING FRONTAGE: FRONT _____ FT. SIDE _____ FT.

TRAFFIC LANE: FRONT _____ FT. SIDE _____ FT.

HEIGHT OF SIGN: 8 FT. CLEARANCE TO GRADE: 4 FT.

AREA OF SIGN: 40 SQ. FT. AREA OF EXISTING SIGNS: 74 SQ. FT.

TOTAL ALLOWED AREA: FRONT 84 SQ. FT. SIDE 291.68 SQ. FT.

TYPE OF SIGN

*SKETCH

- ON PREMISE
- OFF PREMISE
- FREE STANDING
- PROJECTING
- ROOF
- FLUSH WALL
- ILLUMINATED
- OTHER

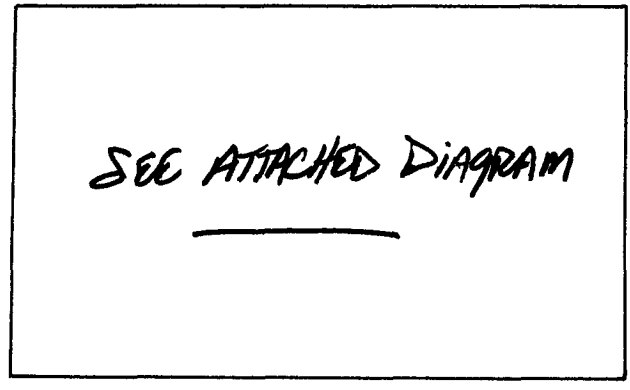

COMMENTS NON ILLUMINATED, PAINTED
ON BUILDING WALL -

*Include: Streets, Property Lines, Proposed Sign Location.

PROPERTY OWNER: J & S FENCE Co.

ADDRESS: 2886 I-70 BUSINESS LOOP

CONTRACTOR: BENTON SIGNS

ADDRESS: 2880 I-70 BUSINESS LOOP

PHONE: 243-8629

R. S. Khalick
Signature

APPROVED BY: Karl Metzger

DATE APPROVED: 5/28/91

- FINAL PERMIT
- WILL REQUIRE SEPARATE PERMIT

5/28/91
R.R.

BENTON
SIGNS
AND LIGHTING

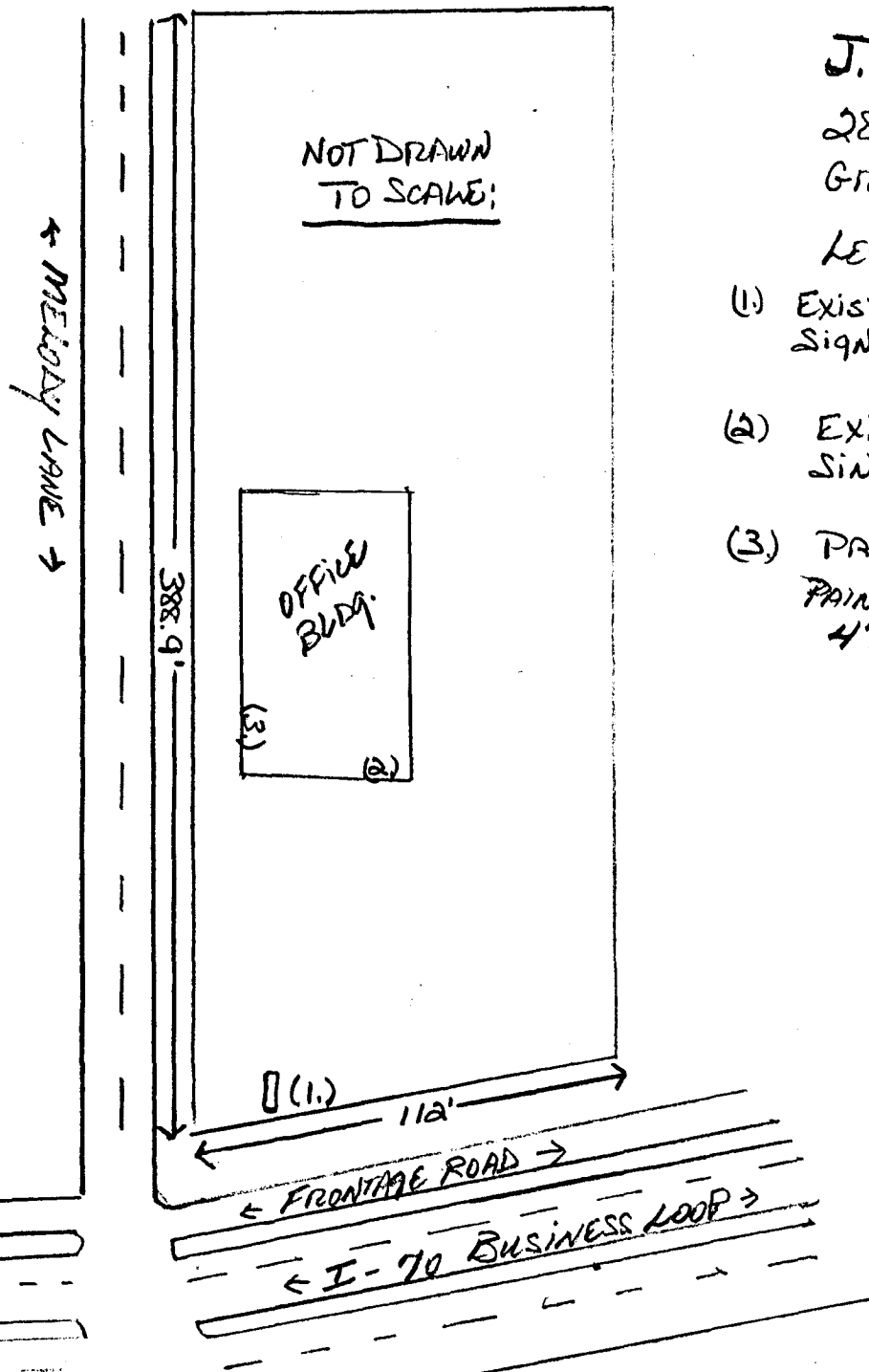
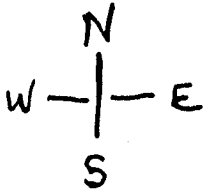

NOT DRAWN
TO SCALE;

J. & S. FENCE CO.

2886 I-70 BUSINESS LOOP
GRAND JUNCTION, COLO 81501

LEGEND:

- (1) EXISTING FREE STANDING POLE SIGN - 59 SQ. FT.
- (2) EXISTING BUILDING SIGN SINGLE FACE - 15 SQ. FT.
- (3) PROPOSED LOCATION NEW PAINTED ON BUILDING SIGN - 4'X10" - 40 SQ. FT.