

DATE SUBMITTED: 2-7-91

PERMIT # _____

TAX SCHEDULE #: 2943-074-00-060

FEE 500

SIGN PERMIT

GRAND JUNCTION PLANNING DEPARTMENT

BUSINESS NAME: VIC'S TOWING

BUSINESS ADDRESS: 2888 NORTH AVE.

STREET FRONTAGE: FRONT 90 FT. SIDE 145 FT.

BUILDING FRONTAGE: FRONT 30 FT. SIDE 30 FT.

TRAFFIC LANE: FRONT _____ FT. SIDE _____ FT.

HEIGHT OF SIGN: 8 FT. CLEARANCE TO GRADE: 4 FT.

AREA OF SIGN: 32 SQ. FT. AREA OF EXISTING SIGNS: 0 SQ. FT.

TOTAL ALLOWED AREA: FRONT 135 SQ. FT. SIDE 108.75 SQ. FT.

TYPE OF SIGN

- ON PREMISE
- OFF PREMISE
- FREE STANDING
- PROJECTING
- ROOF
- FLUSH WALL
- ILLUMINATED
- OTHER

COMMENTS _____

*SKETCH

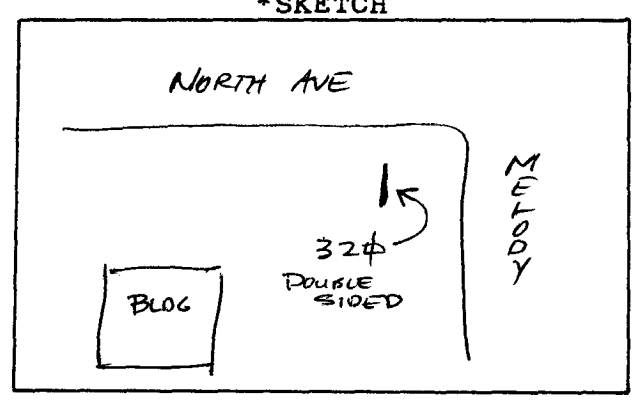

*Include: Streets, Property Lines, Proposed Sign Location.

PROPERTY OWNER: GREAT HOMES

ADDRESS: 1199 PATTERSON

TRACTOR: BUD'S SIGNS

TELEPHONE: 1055 UTE

PHONE: 245-7700

[Signature]
Signature

APPROVED BY: [Signature]

DATE APPROVED: 2-7-91

- FINAL PERMIT
- WILL REQUIRE SEPARATE PERMIT