

Date submitted: 4-1-92
Zone: C-2
Tax Schedule: 2945-142-04-008

Permit # _____ Fee \$ 5.00
 Requires Building Department Permit

SIGN PERMIT

GRAND JUNCTION COMMUNITY DEVELOPMENT

BUSINESS NAME: Canyon Convenience Inc CONTRACTOR: Western Neon Sign Co
BUS. ADDRESS: 459 No Ave ADDRESS: 2495 Industrial Blvd
PROPERTY OWNER: Cliff Weiland TELEPHONE NO: 242-7841
OWNER ADDRESS: 2402 Green Hills of Norman Okla LICENSE NO: 2910225

- 1. FLUSH WALL (2 square feet per linear foot of building facade)
- 2. ROOF (2 square feet per linear foot of building facade)
- 3. FREE-STANDING (2 traffic lanes .75 square feet x street frontage)
(4 or more traffic lanes 1.5 square feet x street frontage)
- 4. PROJECTING (5 square feet per each linear foot of building facade)
- 5. OFF PREMISE (See #3 Spacing Requirements; 300 square feet < 15 square feet)

EXTERNALLY ILLUMINATED INTERNALLY ILLUMINATED NON-ILLUMINATED

(1-5) Area of Proposed Sign 27 Square Feet
(1,2,4) Building Facade _____ Square Feet
(1-4) Street Frontage East Elevation _____ 91 Feet
(2,4) Height to top of Sign 18 Feet Clearance to Grade 14 Feet
() Maximum Allowed Area _____ Square Feet.
(5) Distance From All Existing Off-Premise Signs within 600 Feet _____ Feet

EXISTING SIGNAGE / TYPE:
Pole sign _____ 118 Square Feet
awning sign _____ 4521 Square Feet

TOTAL EXISTING _____ Square Feet

Price Signs

COMMENTS: sign to be mounted on canopy

NOTE: No sign may exceed 300 square feet. A separate sign permit is required for each sign. Attach a sketch of proposed and existing signage including types, dimensions, lettering, abutting streets, property lines, and locations. Free standing signs over 25 feet high, all roof signs, and illuminated signs require a separate permit from the Building Department.

Ray McMan 4/7/92 [Signature] 4-7-92
APPLICANT'S SIGNATURE DATE APPROVED BY DATE

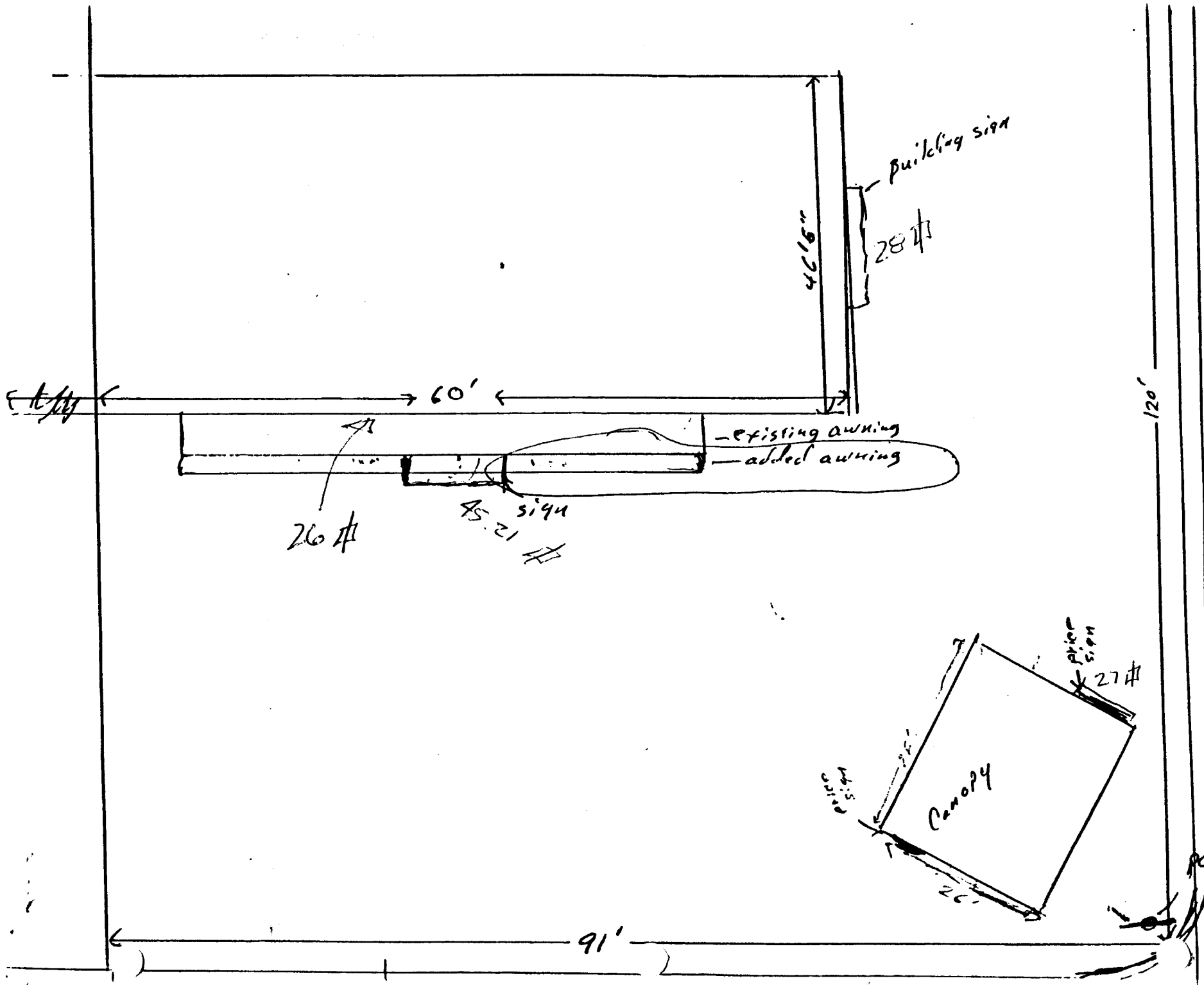

TOTAL SIGN
Allowance = 180 #

NO AVE

TOTAL SIGNAGE ALLOWANCE 180 # (18 # 10 # 1 # 1 #)

Date Submitted: 4-7-92
Zone: C-2
Tax Schedule: 2945-142-01-003

Permit # _____
Fee \$ 1000
 Requires Building Department Permit

SIGN PERMIT

GRAND JUNCTION COMMUNITY DEVELOPMENT

BUSINESS NAME: Canyon Convenience Inc. CONTRACTOR: Western Neon Sign CO.
BUS. ADDRESS: 459 N. Ave. ADDRESS: 2495 Industrial Blvd.
PROPERTY OWNER: Olin Weinland TELEPHONE NO: 242-7843
OWNER ADDRESS: 2402 Green Hills Ct. LICENSE NO: 2910205
Norman, Oklahoma

- 1. FLUSH WALL (2 square feet per linear foot of building facade)
- 2. ROOF (2 square feet per linear foot of building facade)
- 3. FREE-STANDING (2 traffic lanes .75 square feet. x street frontage)
(4 or more traffic lanes 1.5 square feet x street frontage)
- 4. PROJECTING (.5 square feet per each linear foot of building facade)
- 5. OFF PREMISE (See #3 Spacing Requirements; 300 square feet < 15 square feet)

EXTERNALLY ILLUMINATED INTERNALLY ILLUMINATED NON-ILLUMINATED

- (1-5) Area of Proposed Sign 118 Square Feet
(1,2,4) Building Facade _____ Square Feet
(1-4) Street Frontage East Elevation _____ 91 Feet
(2,4) Height to top of Sign 35' Feet Clearance to Grade 14' Feet
(1-5) Maximum Allowed Area 182 Square Feet.
(5) Distance From All Existing Off-Premise Signs within 600 Feet _____ Feet

EXISTING SIGNAGE / TYPE:

<u>Awning Sign</u>	<u>45.21</u> Square Feet
_____	_____ Square Feet
_____	_____ Square Feet
_____	_____ Square Feet

Penzoil
Price Sign
Reader Board

TOTAL EXISTING 45.21 Square Feet

COMMENTS: _____

NOTE: No sign may exceed 300 square feet. A separate sign permit is required for each sign. Attach a sketch of proposed and existing signage including types, dimensions, lettering, abutting streets, property lines, and locations. Free standing signs over 25 feet high, all roof signs, and illuminated signs require a separate permit from the Building Department.

Ray McManis 4/12/92 [Signature] 4-7-92
APPLICANT'S SIGNATURE DATE APPROVED BY DATE

TOTAL SIGN ALLOWANCE = 180 #

NO AVE

16" pole sign

120'

16" pole sign

#28

4'6"

- existing awning
- added awning

60'

#12.58
16" pole sign

#26

#27
16" pole sign

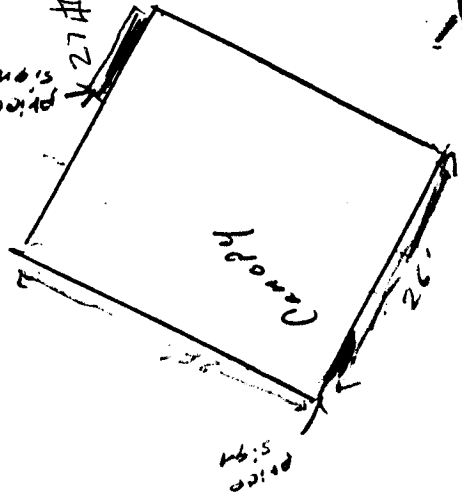

91'

TOTAL SIGNAGE ALLOWED = 120 # (68 # for Freestanding)

Date Submitted: 4-7-92
Zone: C-2
Tax Schedule: 2945-142-04-008

Form #
Fee \$ 5.00
 Requires Building Department Permit

SIGN PERMIT

~~GRAND JUNCTION COMMUNITY DEVELOPMENT~~

BUSINESS NAME: Canyon Conventions CONTRACTOR: Western Neon Signs Co.
BUS. ADDRESS: 451 N. Ave ADDRESS: 2490 E. 1st St. Grand Junction
PROPERTY OWNER: Chin Weiland TELEPHONE NO: 242-7344
OWNER ADDRESS: 2402 Green Hillcrest LICENSE NO: 22718205
Norman, OK

- 1. FLUSH WALL (2 square feet per linear foot of building facade)
- 2. ROOF (2 square feet per linear foot of building facade)
- 3. FREE-STANDING (2 traffic lanes .75 square feet. x street frontage)
(4 or more traffic lanes 1.5 square feet x street frontage)
- 4. PROJECTING (.5 square feet per each linear foot of building facade)
- 5. OFF PREMISE (See #3 Spacing Requirements; 300 square feet < 15 square feet)

EXTERNALLY ILLUMINATED INTERNALLY ILLUMINATED NON-ILLUMINATED

(1-5) Area of Proposed Sign 27 Square Feet
(1,2,4) Building Facade _____ Square Feet
(1-4) Street Frontage No. Elevation _____ 120 Feet
(2,4) Height to top of Sign 18 Feet Clearance to Grade 12 Feet
(1-5) Maximum Allowed Area _____ Square Feet
(5) Distance From All Existing Off-Premise Signs within 600 Feet _____ Feet

EXISTING SIGNAGE / TYPE:

_____	_____	Square Feet	
_____	_____	Square Feet	
_____	_____	Square Feet	
_____	_____	Square Feet	
			TOTAL EXISTING _____ Square Feet

Price Signs

COMMENTS: Sign to be mounted on canopy

NOTE: No sign may exceed 300 square feet. A separate sign permit is required for each sign. Attach a sketch of proposed and existing signage including types, dimensions, lettering, abutting streets, property lines, and locations. Free standing signs over 25 feet high, all roof signs, and illuminated signs require a separate permit from the Building Department.

<u>Joy McManis</u>	<u>4/7/92</u>	<u>[Signature]</u>	<u>4-7-92</u>
APPLICANT'S SIGNATURE	DATE	APPROVED BY	DATE

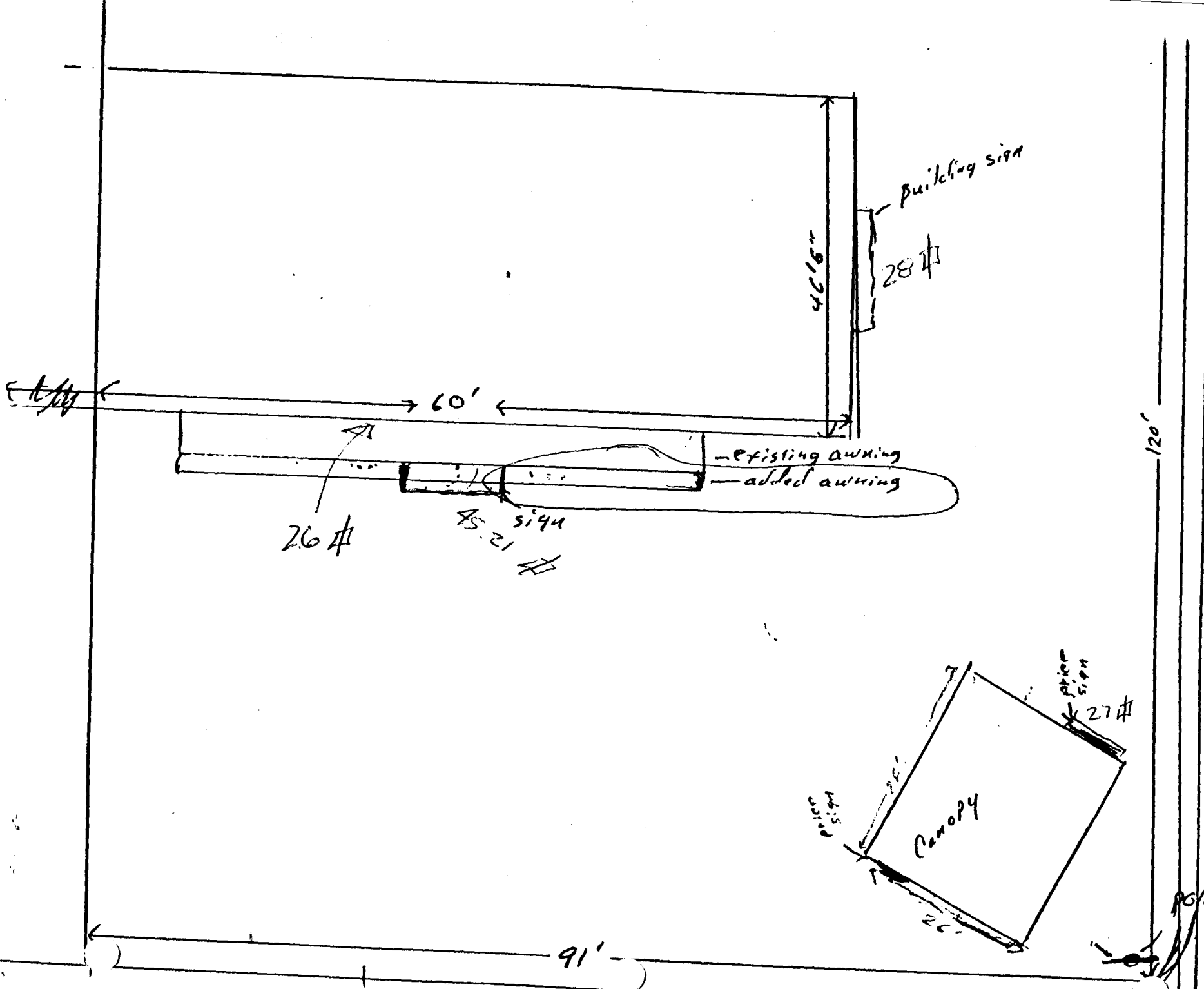

TOTAL SIGN ALLOWANCE = 180 SF

NO AVE

TOTAL SIGNAGE ALLOWANCE = 120 SF (US 111.0.5.1)