



SIGN PERMIT

Community Development Department
250 North 5th Street
Grand Junction, CO 81501
(303) 244-1430

PERMIT NO. _____
Date Submitted 7-17-92
FEE \$ 10⁰⁰
Tax Schedule: ~~245~~ 2945-123-00-087
Zone: C-1

BUSINESS NAME Texaco (Gims) CONTRACTOR G.S. Signs + Neon
STREET ADDRESS 1210 North Ave, G.J. ADDRESS 2915 Hill, G.S. Co. 81504
PROPERTY OWNER Ollin Winland TELEPHONE NO 245-2950
OWNER ADDRESS 3902 Greenhill Ct. LICENSE NO 2910206
Norman, Ok. 73069

- 1. FLUSH WALL 2 Square Feet per Linear Foot of Building Facade
- 2. ROOF 2 Square Feet per Linear Foot of Building Facade
- 3. FREE-STANDING 2 Traffic Lanes - 0.75 Square Feet x Street Frontage
4 or more Traffic Lanes - 1.5 Square Feet x Street Frontage
- 4. PROJECTING 0.5 Square Feet per Each Linear Foot of Building Facade
- 5. OFF-PREMISE See #3 Spacing Requirements; Not > 300 Square Feet or < 15 Square Feet

Externally Illuminated Internally Illuminated Non-Illuminated

- (1 - 5) Area of Proposed Sign 72' Square Feet 6'x7' + 6'x5' = 72' FS Sign
- (1,2,4) Building Facade 42' x 25' Linear Feet
- (1 - 4) Street Frontage 121' x 100' Linear Feet
- (2,4,5) Height to Top of Sign 26' Feet Clearance to Grade 14' Feet
- (5) Distance from all Existing Off-Premise Signs within 600 Feet NA Feet

NORTH AVENUE
1210 STREET FRONTAGE

Existing Signage/Type

<u>NO Signage</u>	_____	Sq Ft
_____	_____	Sq Ft
_____	_____	Sq Ft
Total Existing:	_____	Sq Ft

FOR OFFICE USE ONLY:

Signage Allowed on Parcel

Building 42' x 25' = 84 Sq Ft

Free-Standing 182 Sq Ft

Total Allowed: 182 Sq Ft

COMMENTS: Install one (1) FS sign of 72' at the corner of North + 12th street. See diagram
Location must meet requirements of State Hwy. Dept.

* Jim TAYLOR must approve of location in the field *
244-1558

NOTE: No sign may exceed 300 square feet. A separate sign permit is required for each sign. Attach a sketch of proposed and existing signage including types, dimensions, lettering, abutting streets, alleys, easements, property lines, and locations. **All signs require a separate permit from the Building Department.**

Joh. O. Ahanson 7-17-92 [Signature] 7-20-92
Applicant's Signature Date Approved By Date

#2



SIGN PERMIT

Community Development Department
250 North 5th Street
Grand Junction, CO 81501
(303) 244-1430

PERMIT NO. _____
Date Submitted 7-27-92
FEE \$ 5⁰⁰
Tax Schedule: 2945-123-00-087
Zone: C-1

BUSINESS NAME Texaco (Tims) CONTRACTOR G.S. Signs + Neon
STREET ADDRESS 1210 North Ave, G.S. ADDRESS 2915 Hill Ave, G.S. Co, 81504
PROPERTY OWNER Ollin Winland TELEPHONE NO 245-2950
OWNER ADDRESS 3902 Greenhill Ct LICENSE NO 2910206
Norman, Ok. 73069

- 1. FLUSH WALL 2 Square Feet per Linear Foot of Building Facade
- 2. ROOF 2 Square Feet per Linear Foot of Building Facade
- 3. FREE-STANDING 2 Traffic Lanes - 0.75 Square Feet x Street Frontage
4 or more Traffic Lanes - 1.5 Square Feet x Street Frontage
- 4. PROJECTING 0.5 Square Feet per Each Linear Foot of Building Facade
- 5. OFF-PREMISE See #3 Spacing Requirements; Not > 300 Square Feet or < 15 Square Feet

Externally Illuminated Internally Illuminated Non-Illuminated

(1 - 5) Area of Proposed Sign 34 Square Feet Canopy TEXACO + * = 32'
(1,2,4) Building Facade 42' Linear Feet
(1 - 4) Street Frontage 121 Linear Feet
(2,4,5) Height to Top of Sign 17'± Feet Clearance to Grade 15'± Feet
(5) Distance from all Existing Off-Premise Signs within 600 Feet _____ Feet

NORTH AVENUE FRONTAGE

Existing Signage/Type		
<u>1 FS sign</u>	<u>72'</u>	Sq Ft
_____	_____	Sq Ft
_____	_____	Sq Ft
Total Existing:	<u>72</u>	Sq Ft

FOR OFFICE USE ONLY:

Signage Allowed on Parcel

Building 84 Sq Ft

Free-Standing 182 Sq Ft

Total Allowed: 182 Sq Ft

COMMENTS: install 24" TEXACO + * on the east facin of the canopy = 34' of Signage (100% of the 84 sq ft of Bldg Signage is being Transferred to the EAST SIDE which has no street frontage)

NOTE: No sign may exceed 300 square feet. A separate sign permit is required for each sign. Attach a sketch of proposed and existing signage including types, dimensions, lettering, abutting streets, alleys, easements, property lines, and locations. **All signs require a separate permit from the Building Department.**

[Signature] 7-17-92 [Signature] 7-20-92
Applicant's Signature Date Approved By Date

#3



SIGN PERMIT

Community Development Department
250 North 5th Street
Grand Junction, CO 81501
(303) 244-1430

PERMIT NO. _____
Date Submitted 7-17-92
FEE \$ 5⁰⁰
Tax Schedule: 2945-123-00-087
Zone: C-1

BUSINESS NAME Texaco (Jim's) CONTRACTOR G.S. Signs & Neon
STREET ADDRESS 1210 North Ave, G.S. Co. ADDRESS 2915 Hill Ave G.S. Co. 81504
PROPERTY OWNER Allen Winland TELEPHONE NO 245-2950
OWNER ADDRESS 3902 Greenhill court LICENSE NO 2910206
Norman, OK 73069

- 1. FLUSH WALL 2 Square Feet per Linear Foot of Building Facade
- 2. ROOF 2 Square Feet per Linear Foot of Building Facade
- 3. FREE-STANDING 2 Traffic Lanes - 0.75 Square Feet x Street Frontage
4 or more Traffic Lanes - 1.5 Square Feet x Street Frontage
- 4. PROJECTING 0.5 Square Feet per Each Linear Foot of Building Facade
- 5. OFF-PREMISE See #3 Spacing Requirements; Not > 300 Square Feet or < 15 Square Feet

Externally Illuminated Internally Illuminated Non-Illuminated

(1 - 5) Area of Proposed Sign 34' Square Feet TEXACO + * Channel Letters
17' x 2' = 34
(1,2,4) Building Facade 25' Linear Feet
(1 - 4) Street Frontage 100' Linear Feet
(2,4,5) Height to Top of Sign 17'± Feet Clearance to Grade 15'± Feet
(5) Distance from all Existing Off-Premise Signs within 600 Feet 114' Feet

~~At 12th~~ 12th STREET FRONTAGE

Existing Signage/Type		
1 ES Texaco Sign	72	Sq Ft
1 FW Texaco + *	34	Sq Ft
		Sq Ft
Total Existing:	<u>0</u>	Sq Ft

FOR OFFICE USE ONLY:

Signage Allowed on Parcel

Building 25' / 50' Sq Ft

Free-Standing 100' / 150' Sq Ft

Total Allowed: 50' / 150' Sq Ft

COMMENTS: Install one (1) set of 24" Channel Letters Installed on the west canopy facade. "TEXACO +"

NOTE: No sign may exceed 300 square feet. A separate sign permit is required for each sign. Attach a sketch of proposed and existing signage including types, dimensions, lettering, abutting streets, alleys, easements, property lines, and locations. **All signs require a separate permit from the Building Department.**

[Signature] Applicant's Signature 7-17-92 Date [Signature] Approved By 7-20-92 Date

12th Street →

1
2
3
4
5
6
7
8
9
10
11
12
13
14
15
16
17
18
19
20
21
22
23
24
25
26
27
28

North Ave ↑

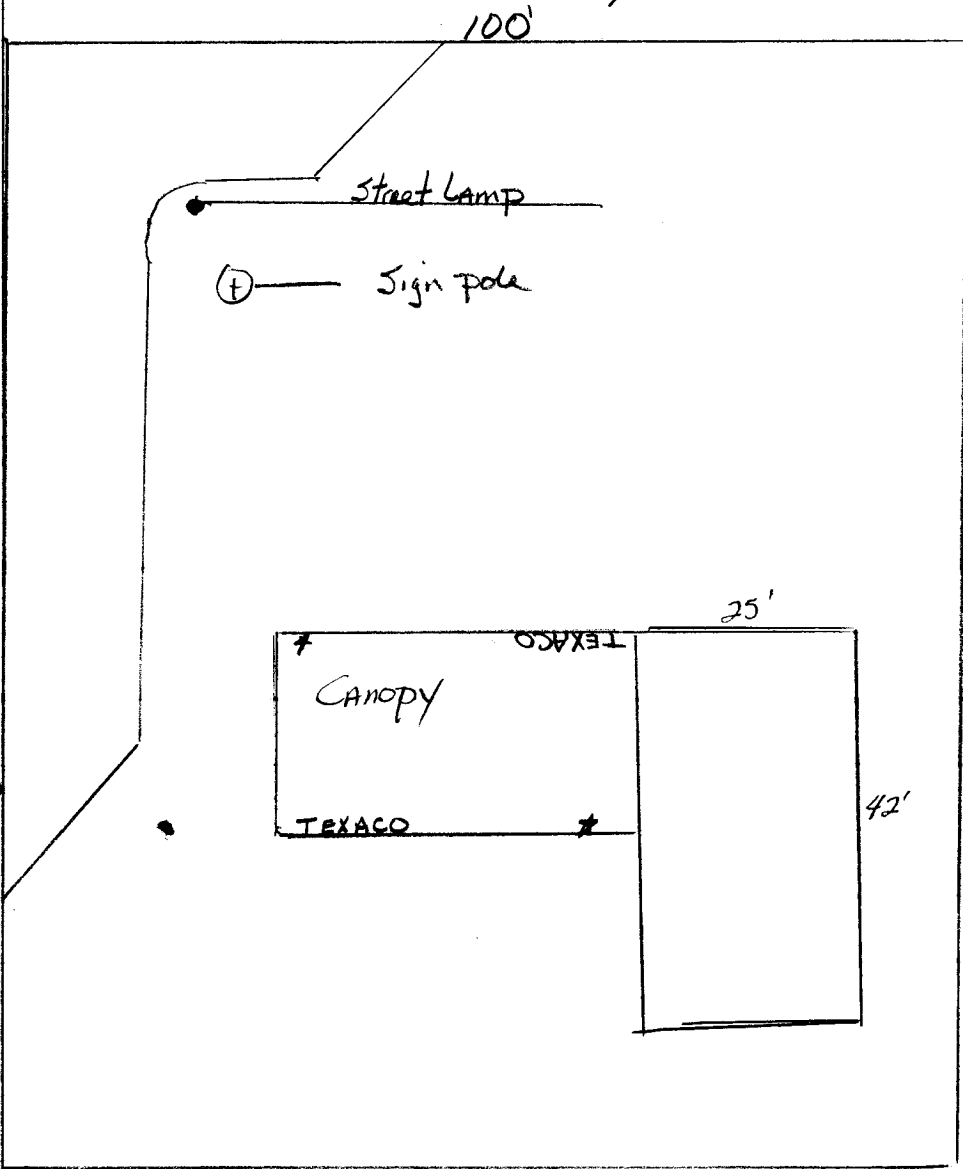

Building Signage
42' North = 82
25' 12th = 50

Lot Signage
121' North = 181.6'
100' 12th = 150'

Canopy 24" TEXACO + □ = 205" = 17 Run x 2' High = 34' Sign
~~18" = 167" = 14' x 18" = 21'~~
~~30" = 249" = 20.75 x 30" = 52'~~

- 1 - 6' x 7' * 6' x 5' FS Sign = 72'
- 2 - 24" TEXACO + Logo Channel Letters = 34' Each

East Canopy fascia

60'

48"

TEXACO 24'

30' (★)

2 x 17' = 34'

West Canopy fascia

60'

48"

(★) 30'

TEXACO 24'

= 2 x 17' = 34'

8
9
10
11
12
13
14
15
16
17
18
19
20
21
22
23
24
25
26
27
28

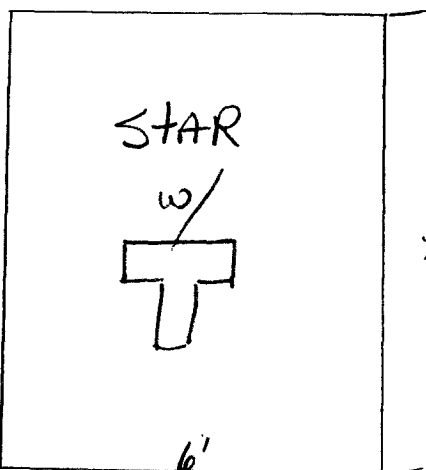

= 72' FS Sign

