

Date submitted: 3-25-92
Zone: PB
Tax schedule: 2945-122-00-115

Permit # _____
Fee \$ 500
 Requires Building Department Permit

SIGN PERMIT ✓

~~GRAND JUNCTION COMMUNITY DEVELOPMENT~~

BUSINESS NAME: Big Red O Quickprint Inc. CONTRACTOR: Western Neon Sign Co
BUS. ADDRESS: 2122 North 12th ADDRESS: 2495 Industrial Blvd.
PROPERTY OWNER: Same TELEPHONE NO: 242-7843
OWNER ADDRESS: _____ LICENSE NO: 2910205

- 1. FLUSH WALL (2 square feet per linear foot of building facade)
- 2. ROOF (2 square feet per linear foot of building facade)
- 3. FREE-STANDING (2 traffic lanes .75 square feet x street frontage)
(4 or more traffic lanes 1.5 square feet x street frontage)
- 4. PROJECTING (.5 square feet per each linear foot of building facade)
- 5. OFF PREMISE (See #3 Spacing Requirements; 300 square feet < 15 square feet)

EXTERNALLY ILLUMINATED INTERNALLY ILLUMINATED NON-ILLUMINATED

(1-5) Area of Proposed Sign 24 Square Feet
(1,2,4) Building Facade 45' Square Feet
(1-4) Street Frontage North 12th st 60 Feet
(2,4) Height to top of Sign 14' Feet Clearance to Grade 10' Feet
(1) Maximum Allowed Area 120 Square Feet.
(5) Distance From All Existing Off-Premise Signs within 600 Feet _____ Feet

EXISTING SIGNAGE / TYPE:

_____	_____	Square Feet	
_____	_____	Square Feet	
_____	_____	Square Feet	
_____	_____	Square Feet	TOTAL EXISTING _____ Square Feet

COMMENTS: New faces on existing sign

NOTE: No sign may exceed 300 square feet. A separate sign permit is required for each sign. Attach a sketch of proposed and existing signage including types, dimensions, lettering, abutting streets, property lines, and locations. Free standing signs over 25 feet high, all roof signs, and illuminated signs require a separate permit from the Building Department.

<u>Raymond J. McManus</u>		<u>[Signature]</u>	<u>3-27-92</u>
APPLICANT'S SIGNATURE	DATE	APPROVED BY	DATE

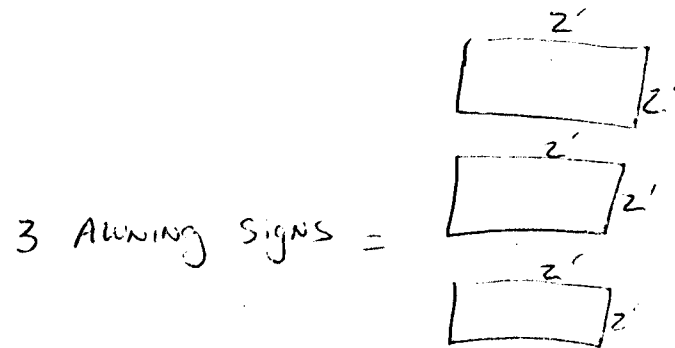
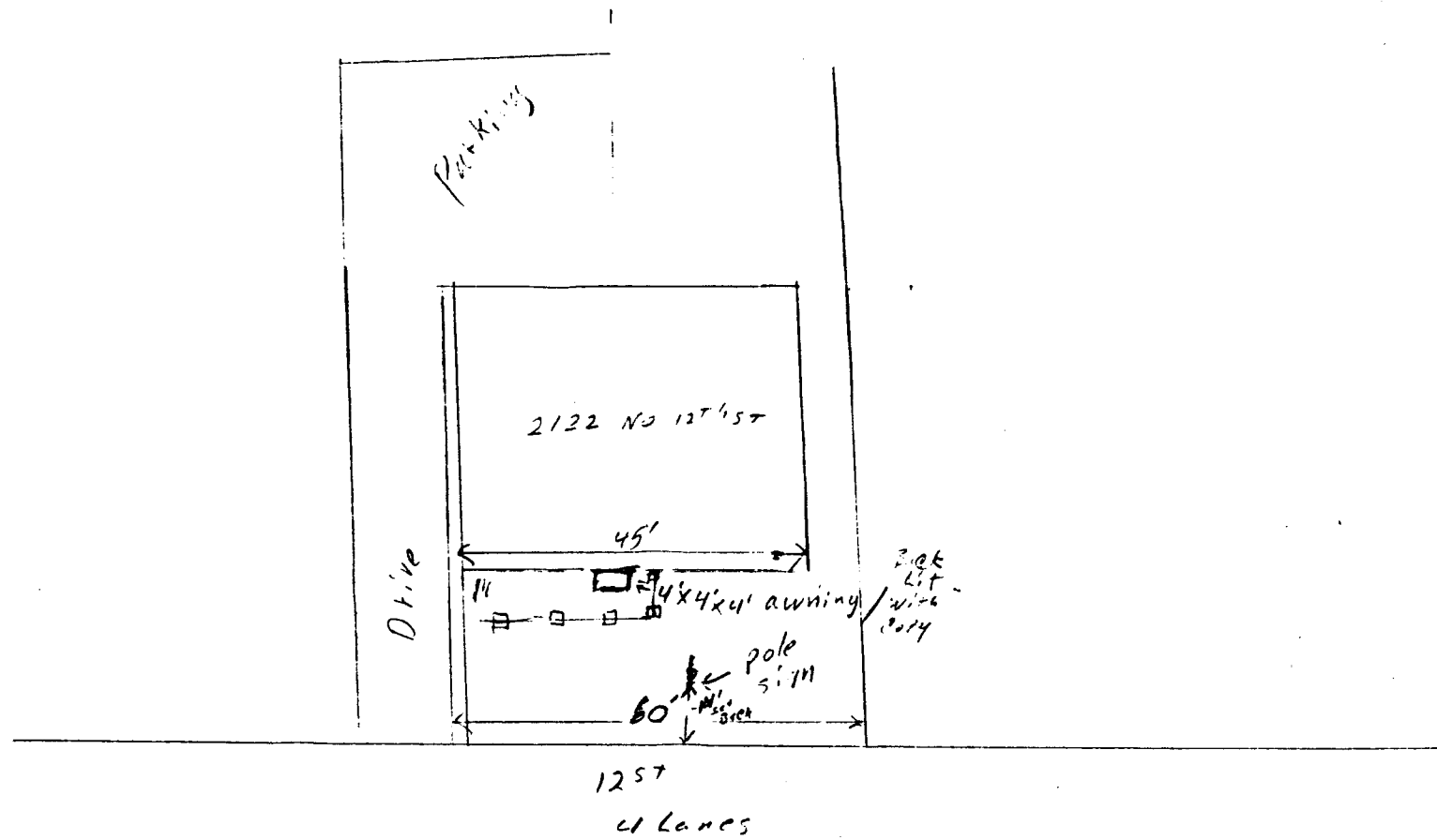

allowed
120

