

Date Submitted: Aug. 12, 1992  
Zone: \_\_\_\_\_  
Tax Schedule: 294526129'001

Permit # \_\_\_\_\_  
Fee \$ 10.00  
 Requires Building Department Permit

# SIGN PERMIT

## GRAND JUNCTION COMMUNITY DEVELOPMENT

BUSINESS NAME: GIBSON'S DISCOUNT CENTER CONTRACTOR: Beston Signs & More  
BUS. ADDRESS: 2694 U.S. Hwy 50 ADDRESS: 2880 I-70 B  
PROPERTY OWNER: SAFARI INC TELEPHONE NO: 243-2629  
OWNER ADDRESS: 1315 Virginia Blvd LICENSE NO: 2920315  
Highland, CO 80501

- 1. FLUSH WALL (2 square feet per linear foot of building facade)
- 2. HOOF (2 square feet per linear foot of building facade)
- 3. FREE-STANDING (2 traffic lanes .75 square feet x street frontage)  
(4 or more traffic lanes 1.5 square feet x street frontage)
- 4. PROJECTING (.5 square feet per each linear foot of building facade)
- 5. OFF PREMISE (See #3 Spacing Requirements; 300 square feet < 15 square feet)

EXTERNALLY ILLUMINATED     INTERNALLY ILLUMINATED     NON-ILLUMINATED

(1-5) Area of Proposed Sign 112 Square Feet  
(1,2,4) Building Facade 792 Square Feet  
(1-4) Street Frontage U.S. Hwy 50 188 Feet  
(2,4) Height to top of Sign 23 1/2 Feet    Clearance to Grade 16 1/2 Feet  
(1-5) Maximum Allowed Area 376 Square Feet.  
(5) Distance From All Existing Off-Premise Signs within 600 Feet \_\_\_\_\_ Feet

EXISTING SIGNAGE / TYPE:  
FLUSH WALL CABINET 16 Square Feet  
\_\_\_\_\_  
\_\_\_\_\_  
\_\_\_\_\_  
\_\_\_\_\_  
TOTAL EXISTING 16 Square Feet

COMMENTS: SINGLE FACE, FLUSH WALL, INTERNALLY ILLUMINATED CABINET

**NOTE:** No sign may exceed 300 square feet. A separate sign permit is required for each sign. Attach a sketch of proposed and existing signage including types, dimensions, lettering, abutting streets, property lines, and locations. Free standing signs over 25 feet high, all roof signs, and illuminated signs require a separate permit from the Building Department.

R. A. Koalich    8/12/92    Christen L. Colbeck    8/12/92  
APPLICANT'S SIGNATURE    DATE    APPROVED BY    DATE

BENTON  
**SIGNS**  
 AND LIGHTING

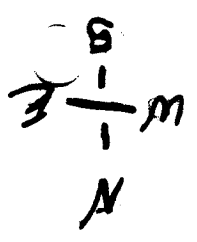

27 RD.

- NOT DRAWN TO SCALE -

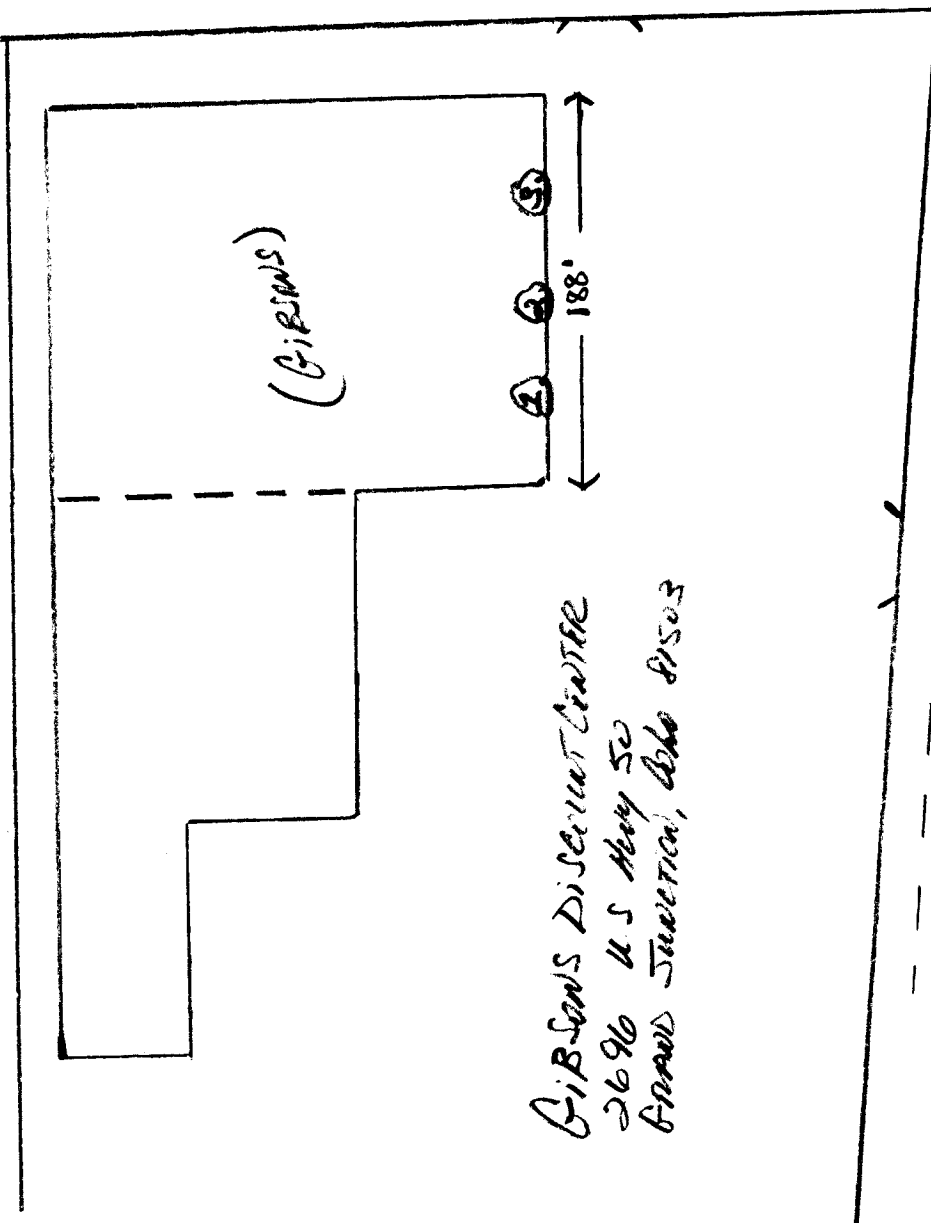

(GIBSON'S)

GIBSON'S DISCOUNT CENTER  
 2696 U.S. Hwy 50  
 Grand Junction, Colo 81503

188'

U.S. Hwy 50

LEGEND:

- ① SINGLE FACE, FLUSH MOUNT, INTERIALLY ILLUMINATED - 16 #
- ② SINGLE FACE, FLUSH MOUNT, INTERIALLY ILLUMINATED - 112 #
- ③ SINGLE FACE, FLUSH MOUNT, INTERIALLY ILLUMINATED - 16 #

TOTAL - 144 #

S/R/AD  
 R.D.V.

Sign # 2  
112 #

GIBSON'S DISCOUNT CENTER  
2646 U.S. Hwy 50  
Grand Junction, Colo. 81503

CABINET  
RED  
↓

YELLOW  
↓

RED  
↓

16'

WHITE  
↓

**Gibson's**

**DISCOUNT  
CENTER**

RED LETTERS