



# SIGN PERMIT

Community Development Department  
250 North 5th Street  
Grand Junction, CO 81501  
(303) 244-1430

PERMIT NO. \_\_\_\_\_

Date Submitted 10-21-94

FEE \$ 25.00

Tax Schedule 2945-143-13-001

Zone C-2

BUSINESS NAME Budget CONTRACTOR Grand Jet. Signs & Neon  
STREET ADDRESS 129 N. 1st 6587881501 LICENSE NO 2940177  
PROPERTY OWNER Schuesswohl Oil Co. ADDRESS 2915 Hill Ave, G.J., 81504  
OWNER ADDRESS 570 Hall Ave TELEPHONE NO 29 245-2950  
G.J., 81501

- 1. FLUSH WALL 2 Square Feet per Linear Foot of Building Facade
- 2. ROOF 2 Square Feet per Linear Foot of Building Facade
- 3. FREE-STANDING 2 Traffic Lanes - 0.75 Square Feet x Street Frontage  
or more Traffic Lanes - 1.5 Square Feet x Street Frontage
- 4. PROJECTING 0.5 Square Feet per each Linear Foot of Building Facade
- 5. OFF-PREMISE See #3 Spacing Requirements; Not > 300 Square Feet or < 15 Square Feet

Externally Illuminated  Internally Illuminated  Non-Illuminated

(1 - 5) Area of Proposed Sign 64 Square Feet 8' high x 8' wide x 18" thick  
(1,2,4) Building Facade 35' Linear Feet  
(1 - 4) Street Frontage 120' Linear Feet  
(2,4,5) Height to Top of Sign 22' Feet Clearance to Grade 14' Feet  
(5) Distance from all Existing Off-Premise Signs within 600 Feet \_\_\_\_\_ Feet

Existing Signage/Type

4' x 4' Free Standing 16 Sq Ft  
Facing Road Ave \_\_\_\_\_ Sq Ft  
\_\_\_\_\_ Sq Ft  
Total Existing: \_\_\_\_\_ Sq Ft

FOR OFFICE USE ONLY:

Signage Allowed on Parcel

Building 70' Sq Ft  
Free-Standing 180 Sq Ft  
Total Allowed: 180 Sq Ft

COMMENTS: install one (1) 8' high x 8' wide x 18" thick sign on an existing pole adjacent to 1st street

NOTE: No sign may exceed 300 square feet. A separate sign permit is required for each sign. Attach a sketch of proposed and existing signage including types, dimensions, lettering, abutting streets, alleys, easements, property lines, and locations. All signs require a separate permit from the Building Department.

Jak Oshana 10-6-94  
Applicant's Signature Date

[Signature] 10-21-94  
Approved By Date

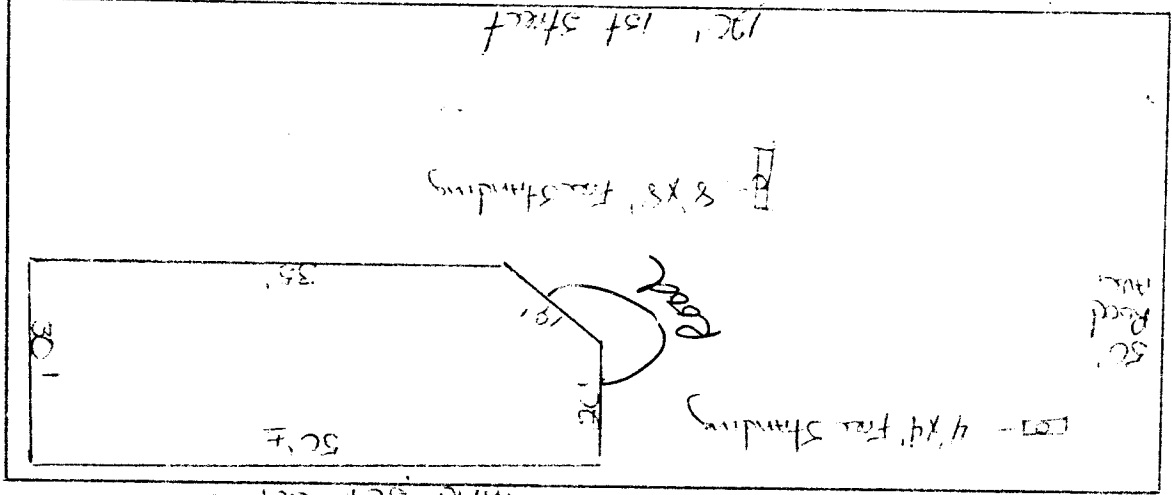

Grand Set Co. 81502

Budget 124 North 1st Street

TS# 2945-143-13-001

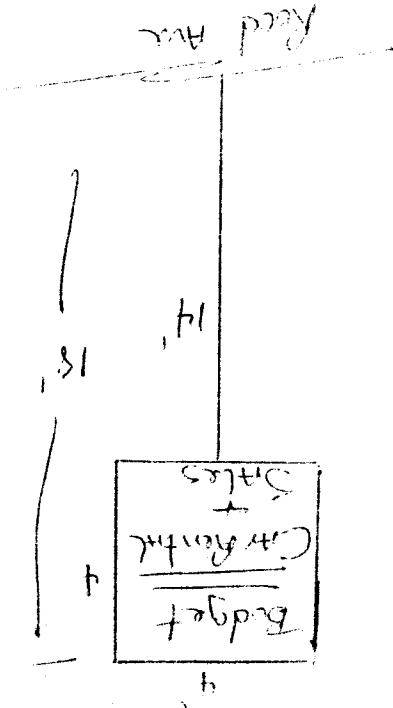
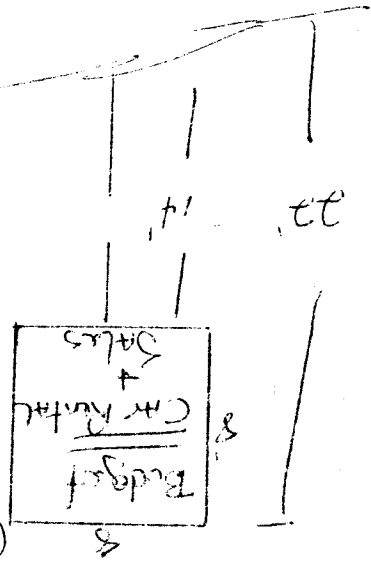



# SIGN PERMIT

Community Development Department  
250 North 5th Street  
Grand Junction, CO 81501  
(303) 244-1430

PERMIT NO. \_\_\_\_\_  
Date Submitted 10-21-94  
FEE \$ 5.00  
Tax Schedule 2945-143-13-001  
Zone C-2

BUSINESS NAME Budget - ~~Post~~ CONTRACTOR Grand Junction Signs & Neon  
STREET ADDRESS 127 North 1st, G.J. LICENSE NO 2940177  
PROPERTY OWNER Schuesswohl Oil Co ADDRESS 2915 Hill Ave, G.S., 81501  
OWNER ADDRESS 570 Hall Ave. TELEPHONE NO 245-2950  
G.J., Co. 81501

- 1. FLUSH WALL 2 Square Feet per Linear Foot of Building Facade
- 2. ROOF 2 Square Feet per Linear Foot of Building Facade
- 3. FREE-STANDING 2 Traffic Lanes - 0.75 Square Feet x Street Frontage  
4 or more Traffic Lanes - 1.5 Square Feet x Street Frontage
- 4. PROJECTING 0.5 Square Feet per each Linear Foot of Building Facade
- 5. OFF-PREMISE See #3 Spacing Requirements; Not > 300 Square Feet or < 15 Square Feet

Externally Illuminated       Internally Illuminated       Non-Illuminated

- (1 - 5) Area of Proposed Sign 16' Square Feet 4'x4'
- (1,2,4) Building Facade 39 Linear Feet
- (1 - 4) Street Frontage 50 Linear Feet
- (2,4,5) Height to Top of Sign 18' Feet Clearance to Grade 14' Feet
- (5) Distance from all Existing Off-Premise Signs within 600 Feet \_\_\_\_\_ Feet

Existing Signage/Type

<u>  —  </u>	_____	Sq Ft
_____	_____	Sq Ft
_____	_____	Sq Ft
<b>Total Existing:</b>	_____	Sq Ft

**FOR OFFICE USE ONLY:**

<u>Signage Allowed on Parcel</u>	
Building	<u>78</u> Sq Ft
Free-Standing	<u>37 1/2</u> Sq Ft
<b>Total Allowed:</b>	<u>78</u> Sq Ft

COMMENTS: install one (1) 4' high x 4' wide x 16" thick sign on an existing sign pole adjacent to Road Ave.

**NOTE:** No sign may exceed 300 square feet. A separate sign permit is required for each sign. Attach a sketch of proposed and existing signage including types, dimensions, lettering, abutting streets, alleys, easements, property lines, and locations. All signs require a separate permit from the Building Department

[Signature] 10-6-94      [Signature] 10-21-94  
Applicant's Signature      Date      Approved By      Date

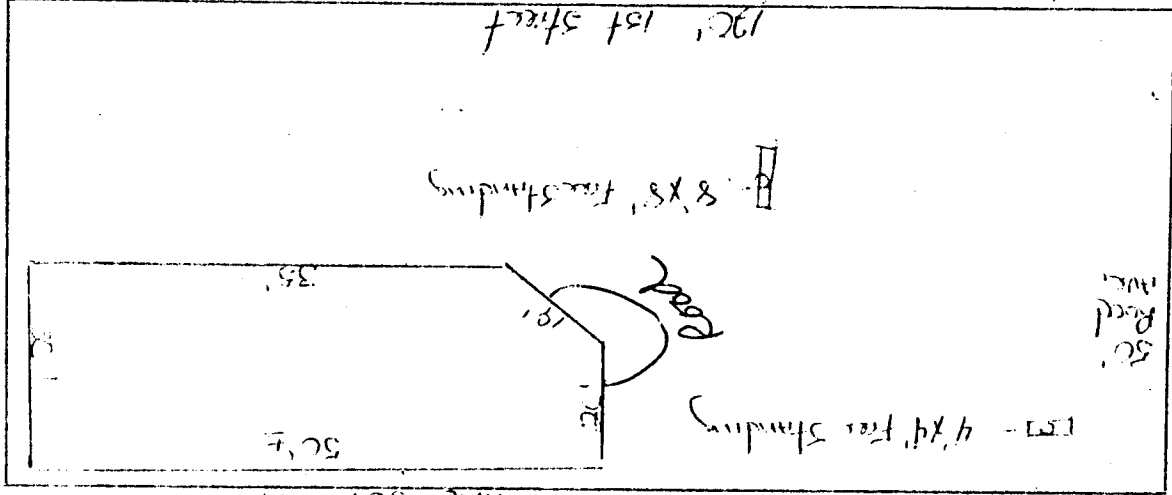

Budget 124 North 1st Street  
Grand St. Co. 81502

TS# 2945-143-13-001

