



# SIGN PERMIT

Community Development Department  
250 North 5th Street Grand Junction, CO 81501  
(303) 244-1430



Permit No. \_\_\_\_\_

Date Submitted 5/12/94

Fee \$ 5.00

Zone B-3

Tax Sched 2945-143-22-024

BUSINESS NAME Norwest Bank  
BUS ADDRESS 359 main street  
PROPERTY OWNER Norwest Bank  
OWNER ADDRESS 359 main street

CONTRACTOR Gordon Sign Company  
ADDRESS 2930 W 9th Ave  
TELEPHONE NO 629-6121 Denver  
LICENSE NO 2940610 CO

- 1. FLUSH WALL 2 Square Feet per Linear Foot of Building Facade
- 2. ROOF 2 Square Feet per Linear Foot of Building Facade
- 3. FREE-STANDING 2 Traffic Lanes - 0.75 Square Feet x Street Frontage  
4 or More Traffic Lanes - 1.5 Square Feet x Street Frontage
- 4. PROJECTING (canopy) 0.5 Square Feet per Each Linear Foot of Building Facade
- 5. OFF PREMISE See #3 Spacing Requirements; Not > 300 Square Feet or < 15 Square Feet
- EXTERNALLY ILLUMINATED  INTERNALLY ILLUMINATED  NON-ILLUMINATED

(1 - 5) Area of Proposed Sign 17 Square Feet (2' x 8'4")  
 (1,2,4) Building Facade ~~444~~ Linear Feet 125'  
 (1 - 4) Street Frontage 125' Linear Feet  
 (2,4,5) Height to Top of Sign \_\_\_\_\_ Feet Clearance to Grade existing structure Feet  
 (1 - 5) Maximum Allowed Sign Area 250 Square Feet  
 (5) Distance From All Existing Off Premise Signs within 600 Feet \_\_\_\_\_ Feet

EXISTING SIGNAGE / TYPE				
<u>Flush wall</u>	<u>12</u>	Square Feet		
<u>Directional</u>	<u>9</u>	Square Feet		
_____	_____	Square Feet		
_____	_____	Square Feet		
			TOTAL EXISTING	<u>21</u> SF

COMMENTS Replace existing awning cover with new - remove existing Modern Touch sign below

**NOTE:** No sign may exceed 300 square feet. A separate sign permit is required for each sign. Attach a sketch of proposed and existing signage including types, dimensions, lettering, abutting streets, property lines, and locations. All signs require a separate permit from the Building Department.

Debra Ramirez 4-28-94 Kathy Poston 5/6/94  
 APPLICANT'S SIGNATURE DATE APPROVED BY DATE

REMOVE

P 91885



REMOVE

(Leave Structure as is)

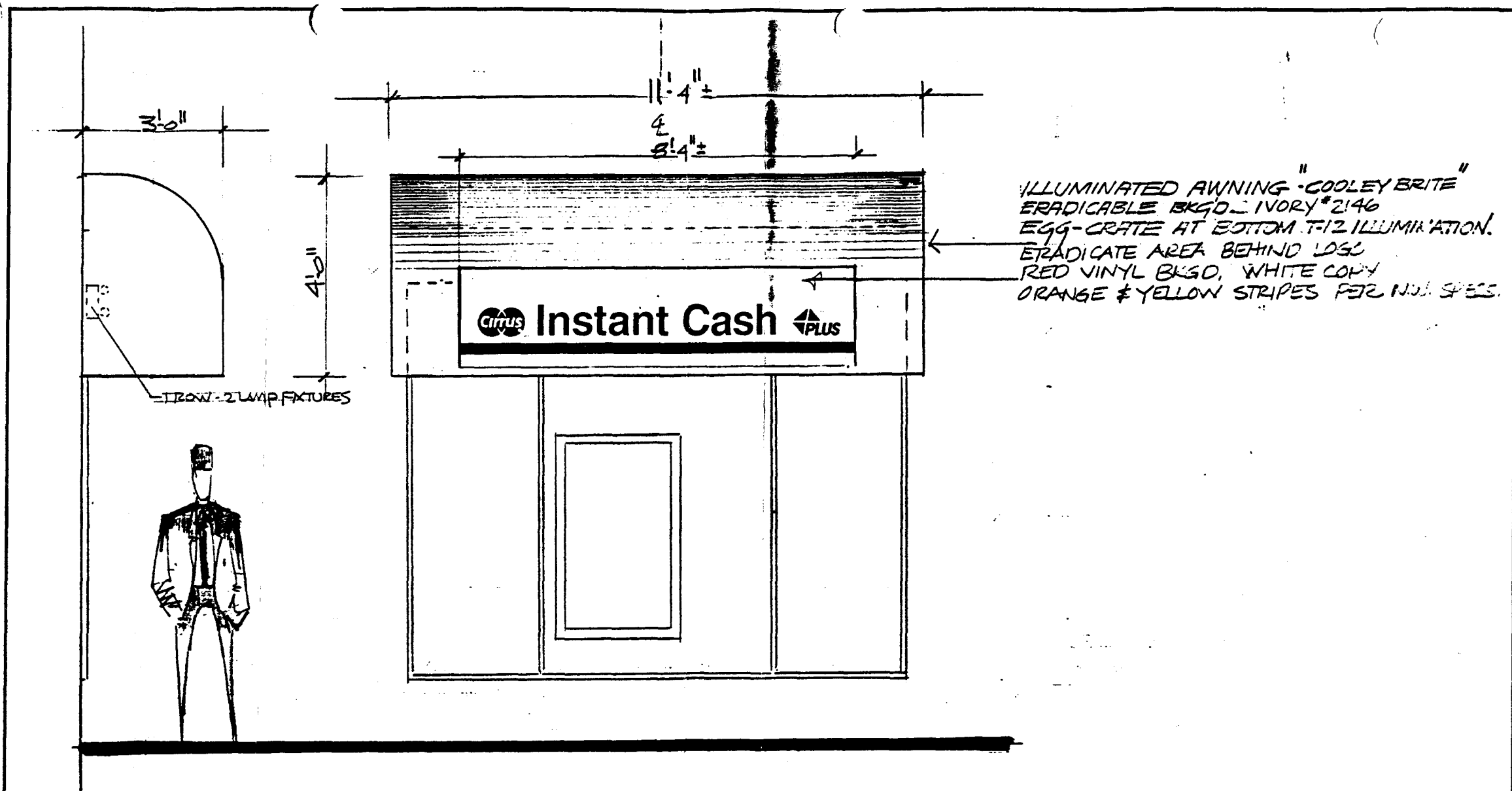

ILLUMINATED AWNING - COOLEY BRITE  
 ERADICABLE BKGD. - IVORY #2146  
 EGG-CRATE AT BOTTOM. 7/2 ILLUMINATION.  
 ERADICATE AREA BEHIND LOGO  
 RED VINYL BKGD. WHITE COPY  
 ORANGE & YELLOW STRIPES PER N.J. SPECS.

TRAW - 2 LAMP FIXTURES

GORDON SIGN COMPANY WILL ENDEAVOR TO CLOSELY MATCH COLORS, INCLUDING PMS WHERE SPECIFIED. WE CANNOT GUARANTEE EXACT MATCHES DUE TO VARYING COMPATIBILITY OF SURFACE MATERIALS AND PAINTS USED.  
 © THIS DESIGN IS THE EXCLUSIVE PROPERTY OF GORDON SIGN CO. AND CANNOT BE REPRODUCED EITHER IN WHOLE OR IN PART WITHOUT THEIR WRITTEN CONSENT.

SCALE: 1/2" = 1'-0"    DATE: 2-15-94    DRAWN BY: FCL    DRAWING: 27263 C  
 NORWEST BANK ATM #83 / 359 MAIN ST. GRAND JUNCTION  
 TISCHER



38764

TRANSACTION REPORT

MAY- 5-94 THU 12:25

RECEIVE

#	DATE	S. T.	NAME	TIME	PGS	NOTE	DP
01	MAY- 5	12:24	303 629 1024	1' 35"	3	OK	

**Facsimile Message Coversheet**

**Gordon Sign Company** 2930 W. 9th Ave. Denver 80204 (303) 629-6121

2 PAGES FOLLOW

TO: Cathy (Planning Dept.)

FAX NUMBER: 244-1599

FROM: Debra Raming

FAX NUMBER: (303) 629-1024

DATE: 5-5-94

RE: 359 main street

**MESSAGE**

Please let me know if everything is OK.

Thank you  
Debra

**SITE PLAN N.T.S.**  
 359 MAIN ST.  
 GRAND JUNCTION, CO.



MAIN STREET

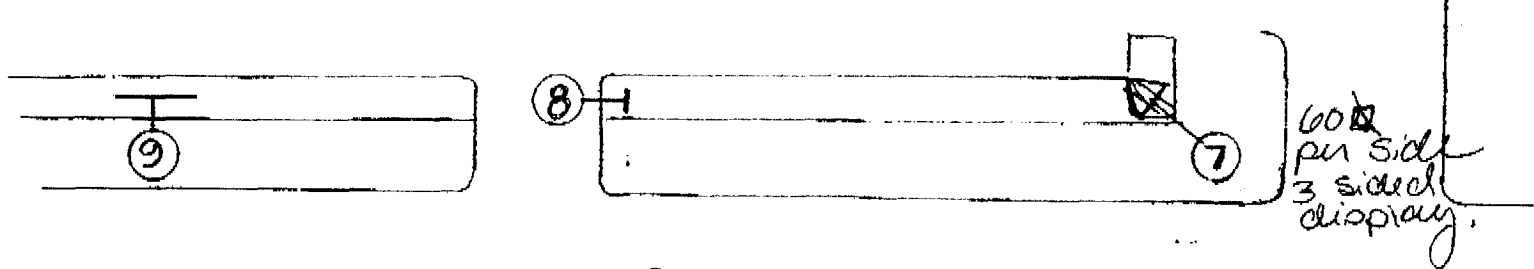
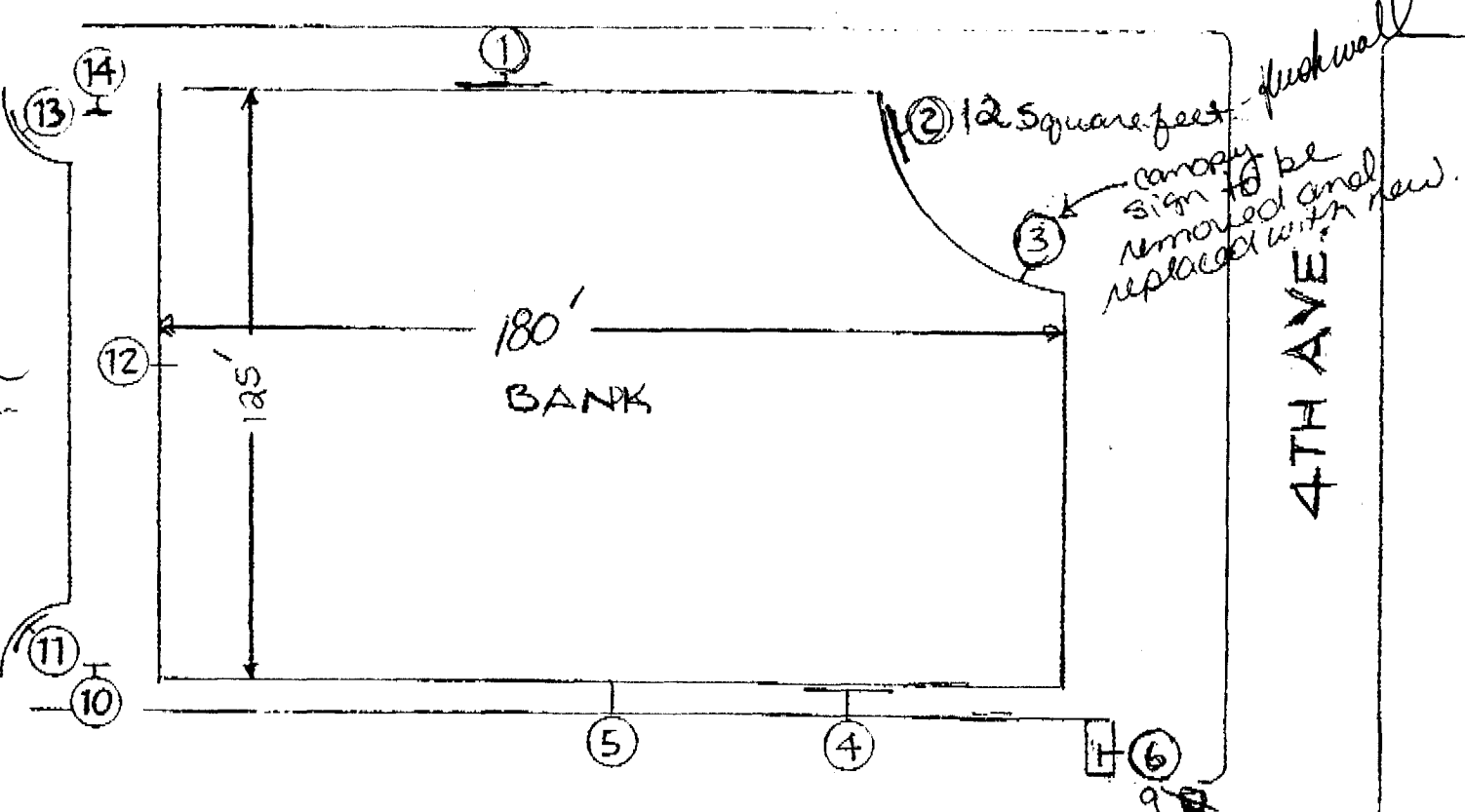

COLORADO

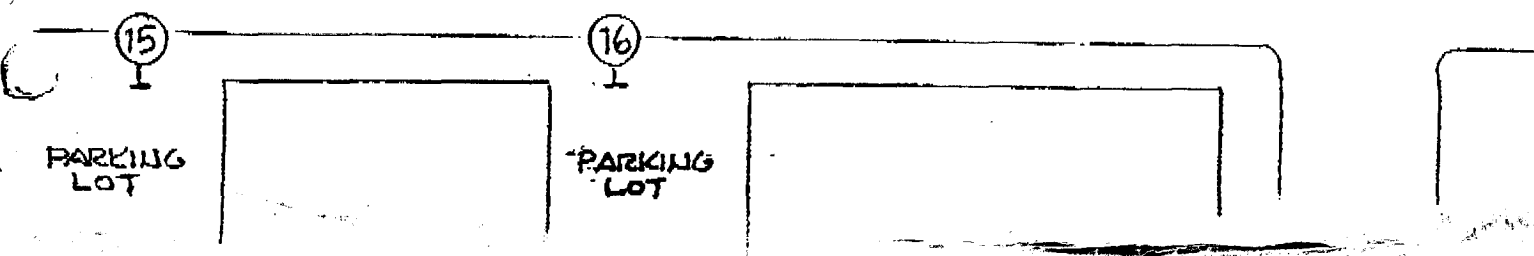

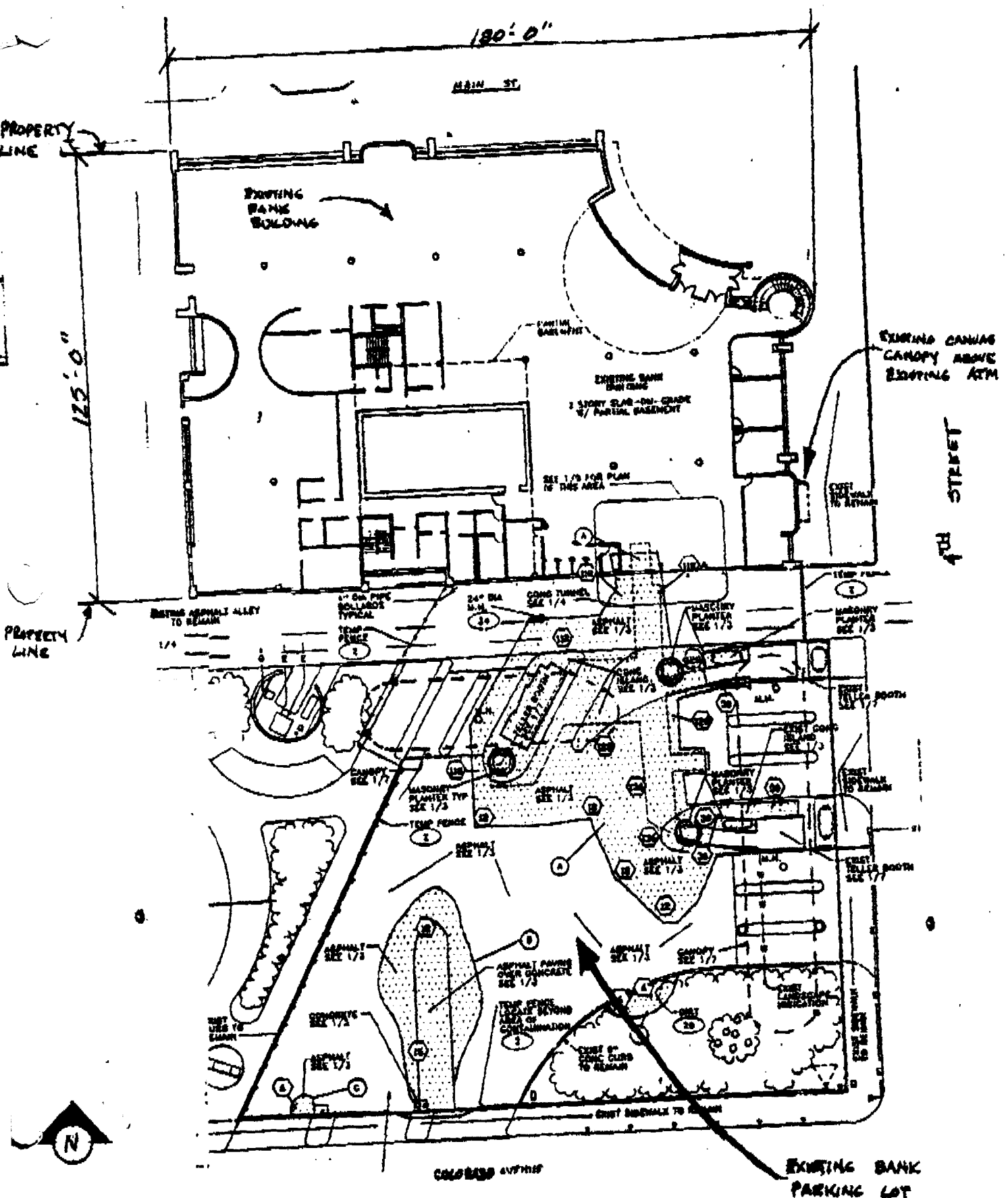

NORWEST BANK GRAND JCT. - DOWNTOWN  
 359 MAIN ST.