



# SIGN PERMIT

Community Development Department  
250 North 5th Street  
Grand Junction, CO 81501  
(303) 244-1430

PERMIT NO. \_\_\_\_\_  
Date Submitted 9/13/94  
FEE \$ 5.00  
Tax Schedule 2945-114-18-009  
Zone C-1

BUSINESS NAME ITC ARCADE  
STREET ADDRESS 357 ~~357~~ N. AVE  
PROPERTY OWNER RICHARD FULKURSAN  
OWNER ADDRESS 3309 E. COLFAX  
DENVER 80206

CONTRACTOR SOURDOUGH SIGNS  
LICENSE NO 09510406  
ADDRESS 2223 N. 2nd  
TELEPHONE NO 243-5013

- 1. FLUSH WALL 2 Square Feet per Linear Foot of Building Facade *on bldg.*
- 2. ROOF 2 Square Feet per Linear Foot of Building Facade
- 3. FREE-STANDING 2 Traffic Lanes - 0.75 Square Feet x Street Frontage  
4 or more Traffic Lanes - 1.5 Square Feet x Street Frontage
- 4. PROJECTING 0.5 Square Feet per each Linear Foot of Building Facade
- 5. OFF-PREMISE See #3 Spacing Requirements; Not > 300 Square Feet or < 15 Square Feet

Externally Illuminated       Internally Illuminated       Non-Illuminated

- (1 - 5) Area of Proposed Sign 8 Square Feet
- (1,2,4) Building Facade 25 (width) Linear Feet *bldg - 42'*
- (1 - 4) Street Frontage 3425 Linear Feet
- (2,4,5) Height to Top of Sign 8 Feet Clearance to Grade 6 Feet
- (5) Distance from all Existing Off-Premise Signs within 600 Feet \_\_\_\_\_ Feet

Existing Signage/Type

<u>1 FREE STNDG</u>	<u>LOW</u>	Sq Ft
<u>Flush Wall (Pues' Room)</u>	<u>13.75</u>	Sq Ft
_____	_____	Sq Ft
<b>Total Existing:</b>	<u><del>64</del></u>	Sq Ft
	<u>77.75</u>	

**FOR OFFICE USE ONLY:**

Signage Allowed on Parcel

Building	<u>84</u>	Sq Ft
Free-Standing	<u>112.5</u>	Sq Ft
<b>Total Allowed:</b>	<u>84</u>	Sq Ft
	<i>building</i>	

COMMENTS: \_\_\_\_\_

**NOTE:** No sign may exceed 300 square feet. A separate sign permit is required for each sign. Attach a sketch of proposed and existing signage including types, dimensions, lettering, abutting streets, alleys, easements, property lines, and locations. All signs require a separate permit from the Building Department.

Brian Swanson  
Applicant's Signature

9/13/94  
Date

Kathy Porter  
Approved By

9/13/94  
Date

PROPOSED  
SIGN

POLE  
SIGN

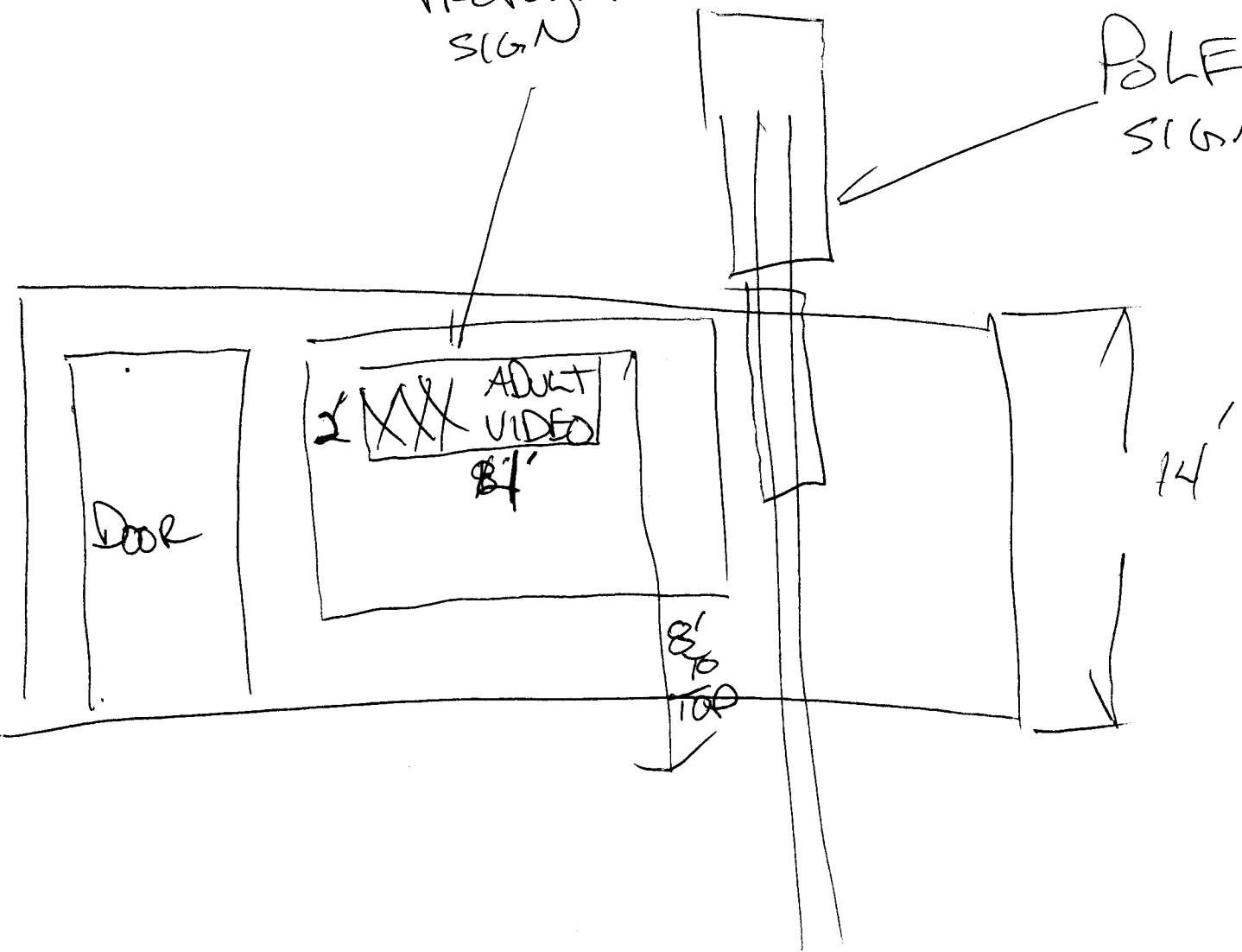



# midwest sign & screen printing supply co.

790 Umatilla, Denver CO 80204

(303) 534-8133

CO WATS 800-332-3819

Nat'l WATS 800-525-3014

FAX (303) 534-2406

NO AVE

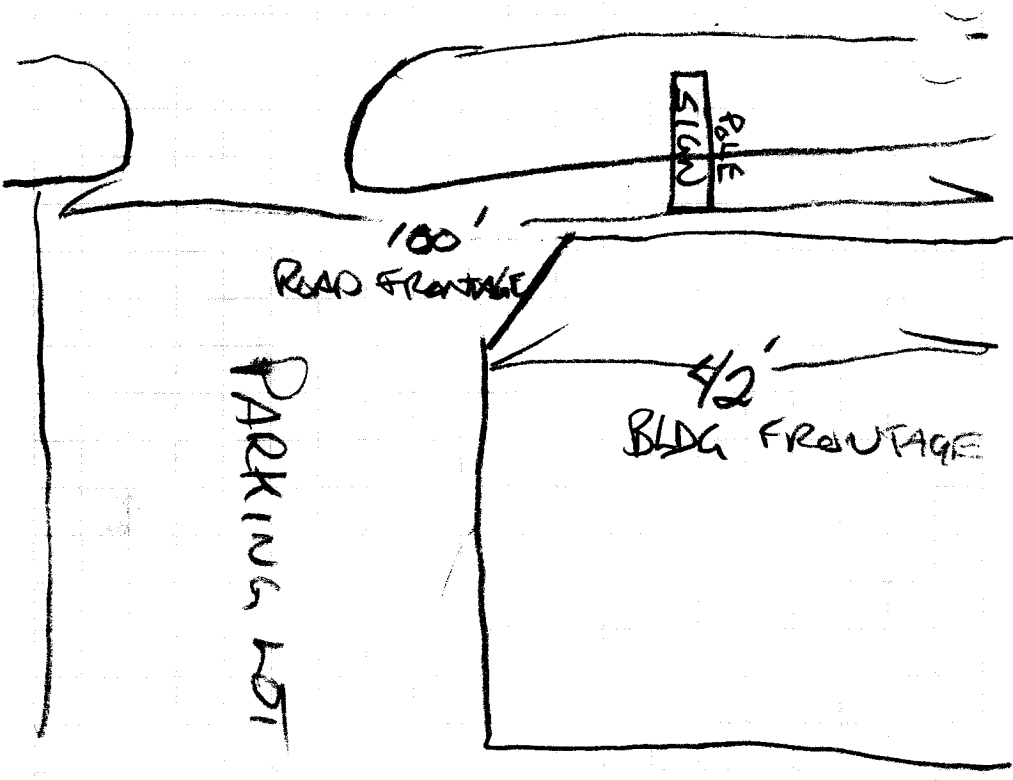

**Distributor to:**  
Sign Advertising  
Screen Printing  
& Graphics Industries



Saint Paul

Denver

Kansas City

Milwaukee

Omat