



SIGN PERMIT

Community Development Department
250 North 5th Street
Grand Junction, CO 81501
(303) 244-1430

PERMIT NO. _____
Date Submitted 11/23/94
FEE \$ 25.00
Tax Schedule 2701-313-09-001
Zone I-1

BUSINESS NAME Alcan Spring
STREET ADDRESS 2242 Hwy 6450
PROPERTY OWNER Charles Carter
OWNER ADDRESS 2242 Hwy 6450

CONTRACTOR Western New
LICENSE NO 2440176
ADDRESS 2495 INDUSTRIAL BLVD.
TELEPHONE NO 2427843

- 1. FLUSH WALL 2 Square Feet per Linear Foot of Building Facade
- 2. ROOF 2 Square Feet per Linear Foot of Building Facade
- 3. FREE-STANDING 2 Traffic Lanes - 0.75 Square Feet x Street Frontage
4 or more Traffic Lanes - 1.5 Square Feet x Street Frontage
- 4. PROJECTING 0.5 Square Feet per each Linear Foot of Building Facade
- 5. OFF-PREMISE See #3 Spacing Requirements; Not > 300 Square Feet or < 15 Square Feet

Externally Illuminated Internally Illuminated Non-Illuminated

- (1 - 5) Area of Proposed Sign 32 Square Feet
- (1,2,4) Building Facade 65 Linear Feet
- (1 - 4) Street Frontage 180/75 Linear Feet
- (2,4,5) Height to Top of Sign 10 Feet Clearance to Grade 6 Feet
- (5) Distance from all Existing Off-Premise Signs within 600 Feet Feet

Existing Signage/Type

<u>Wall letters (non illum)</u>	<u>32</u>	Sq Ft
_____	_____	Sq Ft
_____	_____	Sq Ft
Total Existing:	<u>32</u>	Sq Ft

FOR OFFICE USE ONLY:	
<u>Signage Allowed on Parcel</u>	
Building	<u>130</u> Sq Ft
Free-Standing	<u>262.5</u> Sq Ft
Total Allowed:	<u>262.5</u> Sq Ft

COMMENTS: _____

NOTE: No sign may exceed 300 square feet. A separate sign permit is required for each sign. Attach a sketch of proposed and existing signage including types, dimensions, lettering, abutting streets, alleys, easements, property lines, and locations. All signs require a separate permit from the Building Department.

[Signature] 11-22-94 Kathy Portner 11/23/94
Applicant's Signature Date Approved By Date

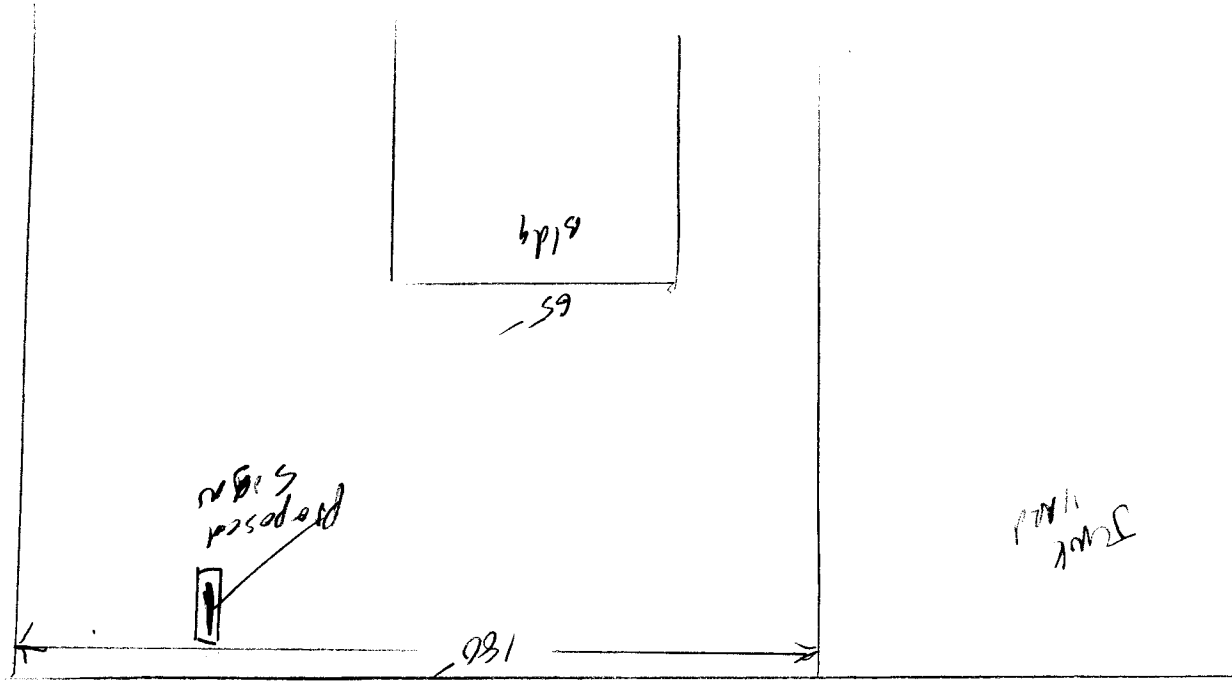

← 130 →
JUNK 6150

6



4



10

