



# SIGN PERMIT

Community Development Department  
250 North 5th Street  
Grand Junction, CO 81501  
(303) 244-1430

PERMIT NO. \_\_\_\_\_  
Date Submitted 8/24/95  
FEE \$ 25.00  
Tax Schedule 2945-143-20-002  
Zone B-3

BUSINESS NAME CAREI Gallery  
STREET ADDRESS 523 1/2 MAIN  
PROPERTY OWNER RASC Properties  
OWNER ADDRESS 101 S. 3rd. G.J.

CONTRACTOR JACK S. MOORHOUSE (Signs N Such)  
LICENSE NO 2950850  
ADDRESS 1156 N. 4th St. Grand Junction  
TELEPHONE NO 245-9002

- 1. FLUSH WALL 2 Square Feet per Linear Foot of Building Facade
- 2. ROOF 2 Square Feet per Linear Foot of Building Facade
- 3. FREE-STANDING 2 Traffic Lanes - 0.75 Square Feet x Street Frontage  
4 or more Traffic Lanes - 1.5 Square Feet x Street Frontage
- 4. PROJECTING 0.5 Square Feet per each Linear Foot of Building Facade
- 5. OFF-PREMISE See #3 Spacing Requirements; Not > 300 Square Feet or < 15 Square Feet

Externally Illuminated       Internally Illuminated       Non-Illuminated

- (1 - 5) Area of Proposed Sign ~~8,3~~ 8,3 Square Feet
- (1,2,4) Building Facade 100 Linear Feet
- (1 - 4) Street Frontage 100 Linear Feet
- (2,4,5) Height to Top of Sign 11 1/2 Feet Clearance to Grade 9' Feet
- (5) Distance from all Existing Off-Premise Signs within 600 Feet \_\_\_\_\_ Feet

Existing Signage/Type

Multiple Projecting Signs 40 sq. ft. Sq Ft  
\_\_\_\_\_ Sq Ft  
\_\_\_\_\_ Sq Ft  
Total Existing: 40 Sq Ft

FOR OFFICE USE ONLY:

Signage Allowed on Parcel  
Building 200 Sq Ft  
Free-Standing 75 Sq Ft  
Total Allowed: 275 Sq Ft

COMMENTS: 50 sq. ft. of projecting sign allowed

**NOTE:** No sign may exceed 300 square feet. A separate sign permit is required for each sign. Attach a sketch of proposed and existing signage including types, dimensions, lettering, abutting streets, alleys, easements, property lines, and locations. All signs require a separate permit from the Building Department.

Jack Moorhouse  
Applicant's Signature

8-23-95  
Date

Mike Pelletier  
Approved By

8/24/95  
Date

523 1/2 MAIN

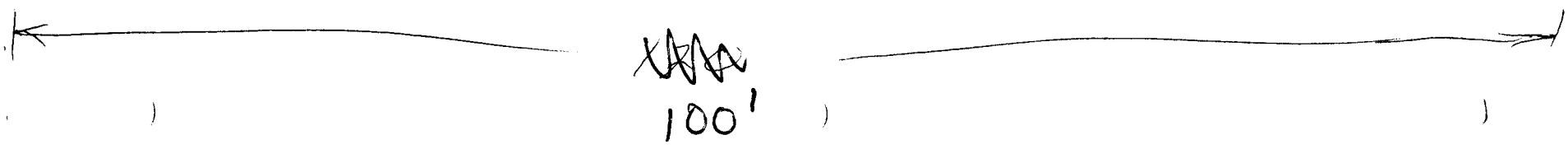
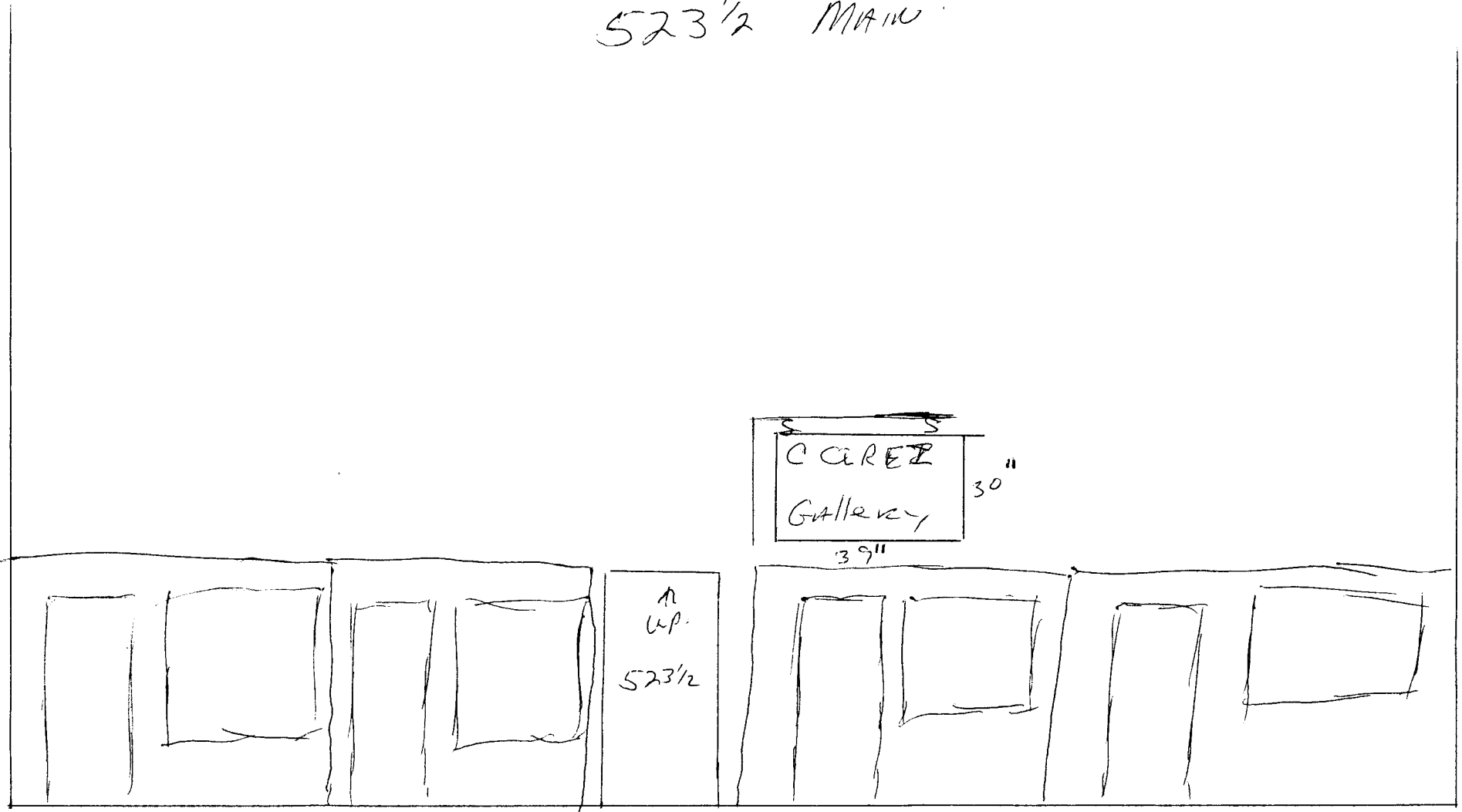

100'