



SIGN PERMIT

Community Development Department
250 North 5th Street
Grand Junction, CO 81501
(303) 244-1430

PERMIT NO. 52863
Date Submitted 6-21-95
FEE \$ 5.00
Tax Schedule 2945-123-21-007
Zone E-1

BUSINESS NAME PUFF & FLUFF PET PARLOR CONTRACTOR BUDS SIGNS
STREET ADDRESS 1460 NORTH AVE LICENSE NO 2950157
PROPERTY OWNER RICHARD GORMAN ADDRESS 1055 UTE
OWNER ADDRESS 1840 N. 12th TELEPHONE NO 245-7700

- 1. FLUSH WALL 2 Square Feet per Linear Foot of Building Facade
- 2. ROOF 2 Square Feet per Linear Foot of Building Facade
- 3. FREE-STANDING 2 Traffic Lanes - 0.75 Square Feet x Street Frontage
4 or more Traffic Lanes - 1.5 Square Feet x Street Frontage
- 4. PROJECTING 0.5 Square Feet per each Linear Foot of Building Facade
- 5. OFF-PREMISE See #3 Spacing Requirements; Not > 300 Square Feet or < 15 Square Feet

Externally Illuminated Internally Illuminated Non-Illuminated

(1 - 5) Area of Proposed Sign 16 Square Feet
(1,2,4) Building Facade 275 Linear Feet
(1 - 4) Street Frontage 275 Linear Feet
(2,4,5) Height to Top of Sign 12 Feet Clearance to Grade 10 Feet
(5) Distance from all Existing Off-Premise Signs within 600 Feet N/A Feet

Existing Signage/Type	Sq Ft
FREE-STANDING <u>(64)</u>	Sq Ft
<u>ROOF</u> <u>176</u>	Sq Ft
	Sq Ft
Total Existing: <u>176/240</u>	Sq Ft

FOR OFFICE USE ONLY:	
Signage Allowed on Parcel <u>15th</u> Street	
Building <u>550</u>	Sq Ft
Free-Standing <u>206</u>	Sq Ft
Total Allowed: <u>550</u>	Sq Ft

COMMENTS: EXISTING ROOF SIGN TO BE REMOVED

NOTE: No sign may exceed 300 square feet. A separate sign permit is required for each sign. Attach a sketch of proposed and existing signage including types, dimensions, lettering, abutting streets, alleys, easements, property lines, and locations. All signs require a separate permit from the Building Department.

[Signature] 6-21-95 [Signature] 6-21-95
Applicant's Signature Date Approved By Date

8'-0"

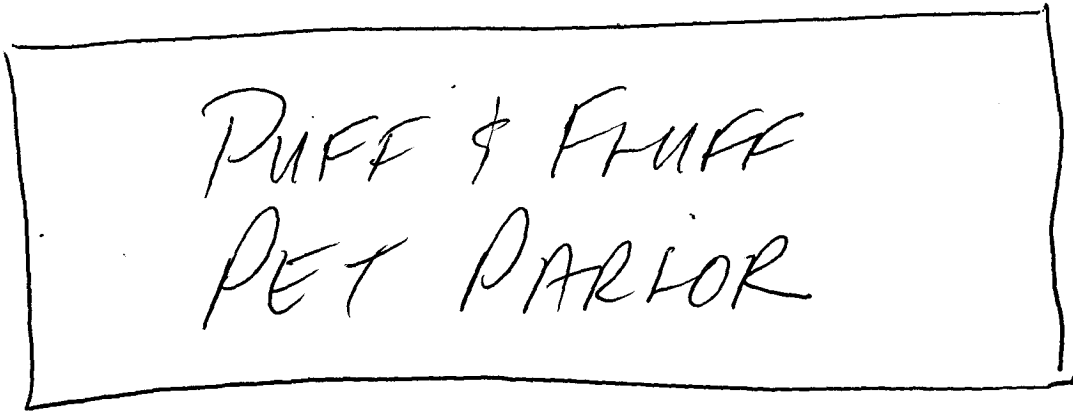

2'-0"

275'

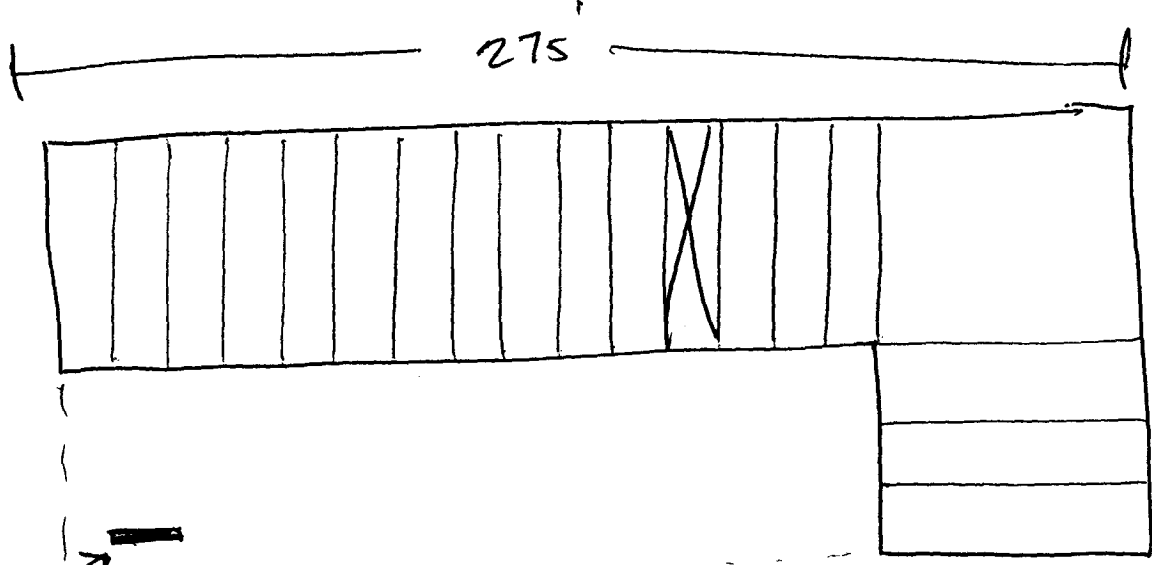

70'

NORTH AVE →

640 PAGESION

← 15th. STREET →