

B



SIGN PERMIT

Community Development Department
250 North 5th Street
Grand Junction, CO 81501
(303) 244-1430

PERMIT NO. _____
Date Submitted 4-2-96
FEE \$ 500
Tax Schedule 2945-143-29-008
Zone C-2

BUSINESS NAME Grayhound Lines Inc
STREET ADDRESS 230 S. 5th Street
PROPERTY OWNER Smith + Associates
OWNER ADDRESS 648 Independent #201
6 S. 81505

CONTRACTOR Western Neon Sign Co.
LICENSE NO 2495 Industrial BLVD
ADDRESS 242-7843
TELEPHONE NO 2960490

- 1. FLUSH WALL 2 Square Feet per Linear Foot of Building Facade
 - 2. ROOF 2 Square Feet per Linear Foot of Building Facade
 - 3. FREE-STANDING 2 Traffic Lanes - 0.75 Square Feet x Street Frontage
 - 4. PROJECTING 4 or more Traffic Lanes - 1.5 Square Feet x Street Frontage
 - 5. OFF-PREMISE 0.5 Square Feet per each Linear Foot of Building Facade
- See #3 Spacing Requirements; Not > 300 Square Feet or < 15 Square Feet

Externally Illuminated Internally Illuminated Non-Illuminated

Bar Electric 24x4

(1 - 5) Area of Proposed Sign 8' Square Feet 2'x8'
 (1,2,4) Building Facade 134' Linear Feet 5th street
 (1 - 4) Street Frontage 134' Linear Feet
 (2,4,5) Height to Top of Sign 17' Feet Clearance to Grade 15' Feet
 (5) Distance from all Existing Off-Premise Signs within 600 Feet _____ Feet
5TH ST FRONTAGE

Existing Signage/Type

2 - 4x8 FW	64	Sq Ft
1 - 2x4 Projecting	8	Sq Ft
1 - 2'x4 FW	(8)	Sq Ft
Total Existing:	8	Sq Ft

PROPOSED SIGN WITH THIS PERMIT

FOR OFFICE USE ONLY:

Signage Allowed on Parcel	
Building	<u>268</u> Sq Ft
Free-Standing	<u>201</u> Sq Ft
Total Allowed:	<u>268</u> Sq Ft

COMMENTS: Install one (1) 2'x4' Projecting "Western Union" Sign to the existing hanging bar located at to the 5th Street entrance

NOTE: No sign may exceed 300 square feet. A separate sign permit is required for each sign. Attach a sketch of proposed and existing signage including types, dimensions, lettering, abutting streets, alleys, easements, property lines, and locations. All signs require a separate permit from the Building Department.

[Signature] 4/2/96
Applicant's Signature Date

Bill Naleh 4-2-96
Approved By Date

A



SIGN PERMIT

Community Development Department
250 North 5th Street
Grand Junction, CO 81501
(303) 244-1430

PERMIT NO.

Date Submitted 4-2-96

FEE \$ 250

Tax Schedule: 2945-143-29-008

Zone: C-2

BUSINESS NAME	<u>Grayhound Lines, Inc</u>	CONTRACTOR	<u>Western Neon Sign Co.</u>
STREET ADDRESS	<u>230 S. 5th Street</u>	ADDRESS	<u>2495 Industrial Blvd</u>
PROPERTY OWNER	<u>Smith Assoc.</u>	TELEPHONE NO	<u>242-7843</u>
OWNER ADDRESS	<u>1045 Independent. 201 65 8505</u>	LICENSE NO	<u>2960490</u>

- | | | |
|--------------------------|------------------|---|
| <input type="checkbox"/> | 1. FLUSH WALL | 2 Square Feet per Linear Foot of Building Facade |
| <input type="checkbox"/> | 2. ROOF | 2 Square Feet per Linear Foot of Building Facade |
| <input type="checkbox"/> | 3. FREE-STANDING | 2 Traffic Lanes - 0.75 Square Feet x Street Frontage
4 or more Traffic Lanes - 1.5 Square Feet x Street Frontage |
| <input type="checkbox"/> | 4. PROJECTING | 0.5 Square Feet per Each Linear Foot of Building Facade |
| <input type="checkbox"/> | 5. OFF-PREMISE | See #3 Spacing Requirements; Not > 300 Square Feet or < 15 Square Feet |

<input type="checkbox"/> Externally Illuminated	<input checked="" type="checkbox"/> Internally Illuminated	<input type="checkbox"/> Non-Illuminated
---	--	--

- (1 - 5) Area of Proposed Sign 8' Square Feet 2'x4'
- (1,2,4) Building Facade 151' Linear Feet FACING Ute
- (1 - 4) Street Frontage 151' Linear Feet 4 LANE
- (2,4,5) Height to Top of Sign 12' Feet Clearance to Grade 10' Feet
- (5) Distance from all Existing Off-Premise Signs within 600 Feet NA Feet

UTE FRONTAGE

Existing Signage/Type

2 - 4'x8' FW Signs 64 Sq Ft

(1 - 2'x4 Projecting 9 Sq Ft

 Sq Ft

Total Existing: 64 Sq Ft

FOR OFFICE USE ONLY:

Signage Allowed on Parcel

Building 302 Sq Ft

Free-Standing 226 Sq Ft

Total Allowed: 302 Sq Ft

COMMENTS: Install one 2' high x 4' long Flush way "Western Union" Sign.

NOTE: No sign may exceed 300 square feet. A separate sign permit is required for each sign. Attach a sketch of proposed and existing signage including types, dimensions, lettering, abutting streets, alleys, easements, property lines, and locations. All signs require a separate permit from the Building Department.

<u>Jeff D. Adams</u>	<u>4/2/96</u>	<u>Bill Nehl</u>	<u>4-2-96</u>
Applicant's Signature	Date	Approved By	Date

B us Electric 2466

Grayhound Lines Inc
230 S. 5th Street
Grand Jct. Ca 81501
970-242-6014

Chris Brooks / Terminal Manager

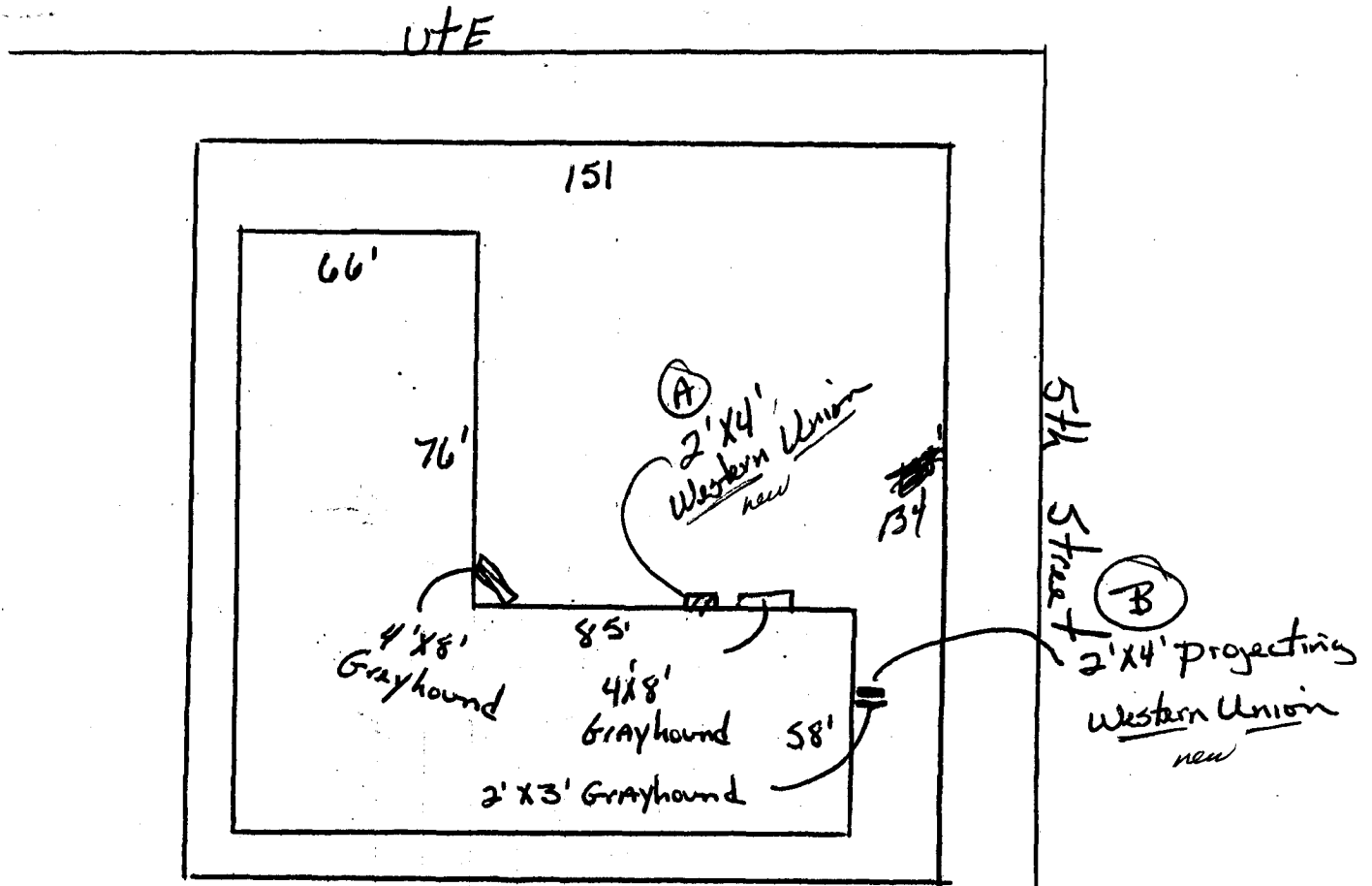

302 sqFT Total Flushwall signage allowed to UTE Ave

268 sqFT Total Flushwall signs allowed to 5th Street.

Not to Scale

Note: The 3' High x 6' Long Internal illuminated
Sign will not fit within the existing confines for
the projected sign. See pictures. Call for details

