



SIGN CLEARANCE



Community Development Department
 250 North 5th Street
 Grand Junction, CO 81501
 (970) 244-1430

Clearance No. 56181
 Date Submitted 5-16-96
 FEE \$ 25⁰⁰
 Tax Schedule 2945-242-12-001
 Zone I-2

BUSINESS NAME ABC Industries Inc
 STREET ADDRESS 610 S. 12th St. GS.
 PROPERTY OWNER ABC Industries, Inc
 OWNER ADDRESS 301 Kings
Warsaw Indiana 46590

CONTRACTOR Western Neon Sign Co.
 LICENSE NO. 2960490
 ADDRESS 2495 Industrial BLVD
 TELEPHONE NO. 242-7843

- 1. FLUSH WALL 2 Square Feet per Linear Foot of Building Facade
- 2. ROOF 2 Square Feet per Linear Foot of Building Facade
- 3. FREE-STANDING 2 Traffic Lanes - 0.75 Square Feet x Street Frontage
4 or more Traffic Lanes - 1.5 Square Feet x Street Frontage
- 4. PROJECTING 0.5 Square Feet per each Linear Foot of Building Facade
- 5. OFF-PREMISE See #3 Spacing Requirements; Not > 300 Square Feet or < 15 Square Feet

Externally Illuminated

Internally Illuminated

Non-Illuminated

- 1 - 5) Area of Proposed Sign ~~481~~ ⁴⁸¹ Square Feet ~~80~~ ^{8x12}awning 50% signed
- (1,2,4) Building Facade 116 Linear Feet
- (1 - 4) Street Frontage 220 Linear Feet -12th St.
- (2,4,5) Height to Top of Sign 20 Feet Clearance to Grade 12' Feet
- (5) Distance from all Existing Off-Premise Signs within 600 Feet NA Feet

Certificate # 3246

Existing Signage/Type:	
ABC FW	32 Sq. Ft.
	Sq. Ft.
	Sq. Ft.
Total Existing:	Sq. Ft.

● FOR OFFICE USE ONLY ●	
Signage Allowed on Parcel:	12th St.
Building	232 Sq. Ft.
Free-Standing	165 Sq. Ft.
Total Allowed:	232 Sq. Ft.

COMMENTS: Install an awning to the center front of building

NOTE: No sign may exceed 300 square feet. A separate sign clearance is required for each sign. Attach a sketch of proposed and existing signage including types, dimensions, lettering, abutting streets, alleys, easements, property lines, and locations. **A SEPARATE PERMIT FROM THE BUILDING DEPARTMENT IS REQUIRED.**

[Signature] 5-16-96 [Signature] 5/16/96
 Applicant's Signature Date Community Development Approval Date

(White: Community Development) (Canary: Applicant) (Pink: Building Dept) (Goldenrod: Code Enforcement)

U.S. Steel

12th Street

road

lettering
to sign
6' x 8' = 48"
assuming
8' x 12'

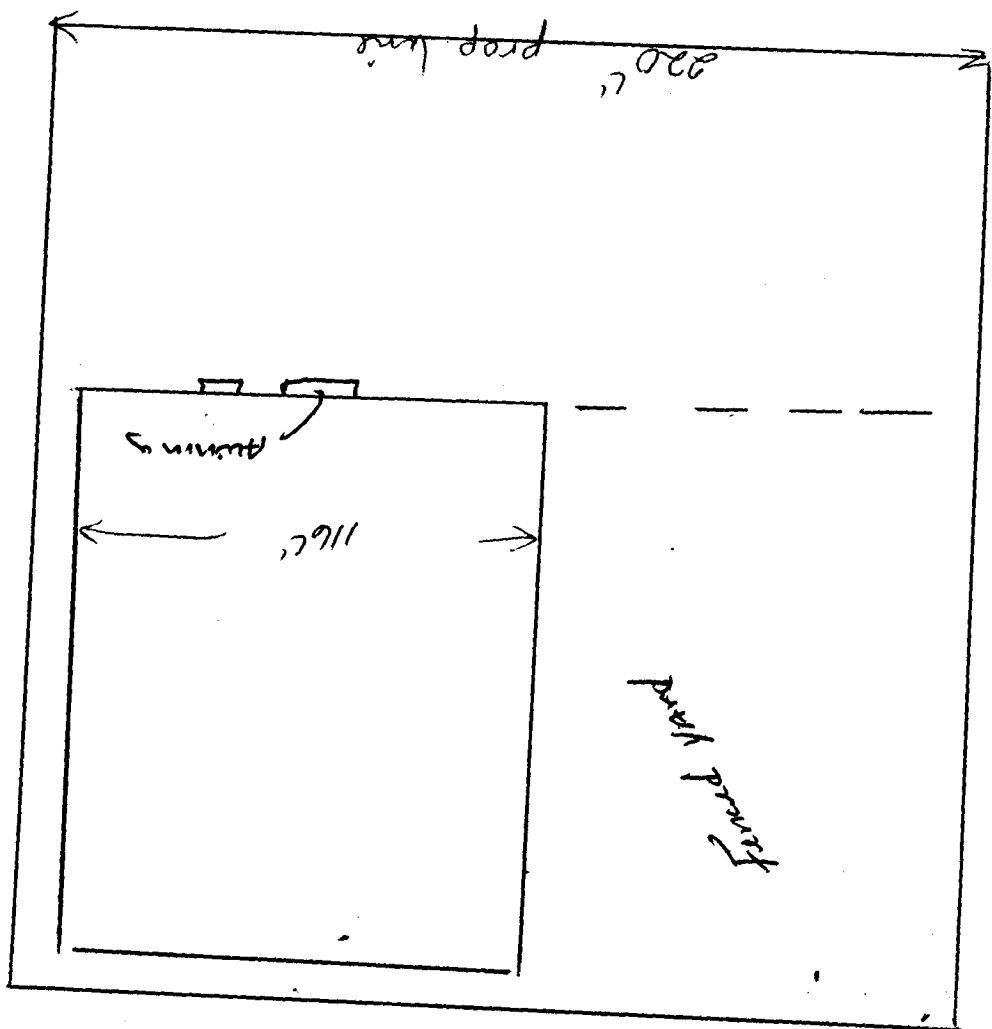
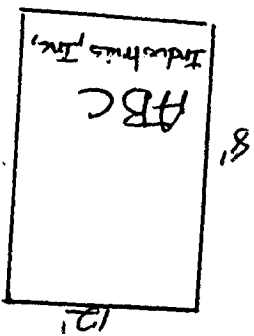

not to scale

ABC Industries