



SIGN PERMIT

Community Development Department
250 North 5th Street
Grand Junction, CO 81501
(303) 244-1430

PERMIT NO. _____
Date Submitted 3/15/96
FEE \$ 25.00 + ~~100.00~~ fine
Tax Schedule 2945-123-15-015
Zone C-1

BUSINESS NAME Common Grounds CONTRACTOR SIGN DESIGNS
STREET ADDRESS 1230 N. 12th G. Jct. LICENSE NO 2960597
PROPERTY OWNER Marilyn Christensen ADDRESS 3018 Market Way S.J.
OWNER ADDRESS 719 Golfmore Ct TELEPHONE NO 434-0939
81501

- 1. FLUSH WALL 2 Square Feet per Linear Foot of Building Facade
 - 2. ROOF 2 Square Feet per Linear Foot of Building Facade
 - 3. FREE-STANDING 2 Traffic Lanes - 0.75 Square Feet x Street Frontage
4 or more Traffic Lanes - 1.5 Square Feet x Street Frontage
 - 4. PROJECTING 0.5 Square Feet per each Linear Foot of Building Facade
 - 5. OFF-PREMISE See #3 Spacing Requirements; Not > 300 Square Feet or < 15 Square Feet
- Externally Illuminated Internally Illuminated Non-Illuminated

(1 - 5) Area of Proposed Sign 84 Square Feet
(1,2,4) Building Facade 53 Linear Feet
(1 - 4) Street Frontage 100' Linear Feet
(2,4,5) Height to Top of Sign 32 Feet Clearance to Grade 25 Feet
(5) Distance from all Existing Off-Premise Signs within 600 Feet Feet

<u>Existing Signage/Type</u>	Sq Ft
_____	_____
_____	_____
_____	_____
Total Existing:	_____ Sq Ft

FOR OFFICE USE ONLY:	
Signage Allowed on Parcel	
Building <u>106</u>	Sq Ft
Free-Standing <u>150</u>	Sq Ft
Total Allowed: <u>150</u>	Sq Ft

COMMENTS: Designed + Installed by
Chet Hambey. - face change only

NOTE: No sign may exceed 300 square feet. A separate sign permit is required for each sign. Attach a sketch of proposed and existing signage including types, dimensions, lettering, abutting streets, alleys, easements, property lines, and locations. All signs require a separate permit from the Building Department.

Jim Kuh 3/15/96 [Signature] 3/18/96
Applicant's Signature Date Approved By Date

Common Grounds Coffee House 241-4221

Not lit up

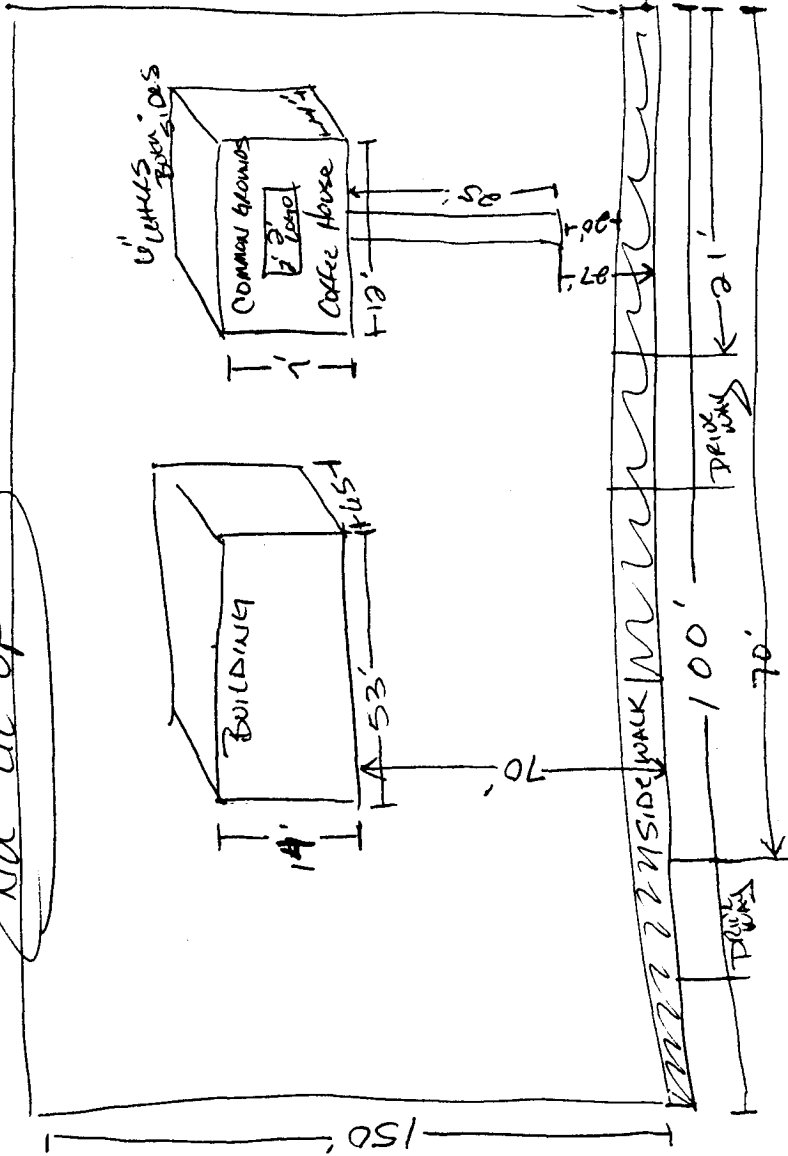

303-245-0962

260 COLORADO AVENUE • GRAND JUNCTION, COLORADO 81501

FAX 303-243-1356