



SIGN CLEARANCE

Community Development Department
 250 North 5th Street
 Grand Junction, CO 81501
 (970) 244-1430

Clearance No. _____
 Date Submitted 10-29-96
 FEE \$ 2500
 Tax Schedule 2943-073-00-129
 Zone C-1

BUSINESS NAME BOARD & BUCKLE
 STREET ADDRESS 2822 N. AVE.
 PROPERTY OWNER BOB SISAL
 OWNER ADDRESS 2822 N. AVE.

CONTRACTOR BUD'S SIGNS
 LICENSE NO. 2960112
 ADDRESS 1055 UTE AVE.
 TELEPHONE NO. 245-7700

- 1. FLUSH WALL 2 Square Feet per Linear Foot of Building Facade
- 2. ROOF 2 Square Feet per Linear Foot of Building Facade
- 3. FREE-STANDING 2 Traffic Lanes - 0.75 Square Feet x Street Frontage
 4 or more Traffic Lanes - 1.5 Square Feet x Street Frontage
- 4. PROJECTING 0.5 Square Feet per each Linear Foot of Building Facade
- 5. OFF-PREMISE See #3 Spacing Requirements; Not > 300 Square Feet or < 15 Square Feet

Externally Illuminated Internally Illuminated Non-Illuminated

- 5) Area of Proposed Sign 64 Square Feet
- (1,2,4) Building Facade 36 Linear Feet
- (1 - 4) Street Frontage 75 Linear Feet
- (2,4,5) Height to Top of Sign ~~22~~ Feet Clearance to Grade 12 Feet
- (5) Distance from all Existing Off-Premise Signs within 600 Feet _____ Feet

Existing Signage/Type:	
	Sq. Ft.
	Sq. Ft.
	Sq. Ft.
Total Existing:	<u>0</u> Sq. Ft.

● FOR OFFICE USE ONLY ●	
Signage Allowed on Parcel:	
Building	<u>72</u> Sq. Ft.
Free-Standing	<u>112.5</u> Sq. Ft.
Total Allowed:	<u>112.5</u> Sq. Ft.

COMMENTS: _____

NOTE: No sign may exceed 300 square feet. A separate sign clearance is required for each sign. Attach a sketch of proposed and existing signage including types, dimensions, lettering, abutting streets, alleys, easements, property lines, and locations. **A SEPARATE PERMIT FROM THE BUILDING DEPARTMENT IS REQUIRED.**

[Signature] 10-29-96 [Signature] 11/5/96
 Applicant's Signature Date Community Development Approval Date

(White: Community Development) (Canary: Applicant) (Pink: Building Dept) (Goldenrod: Code Enforcement)

← North Ave →

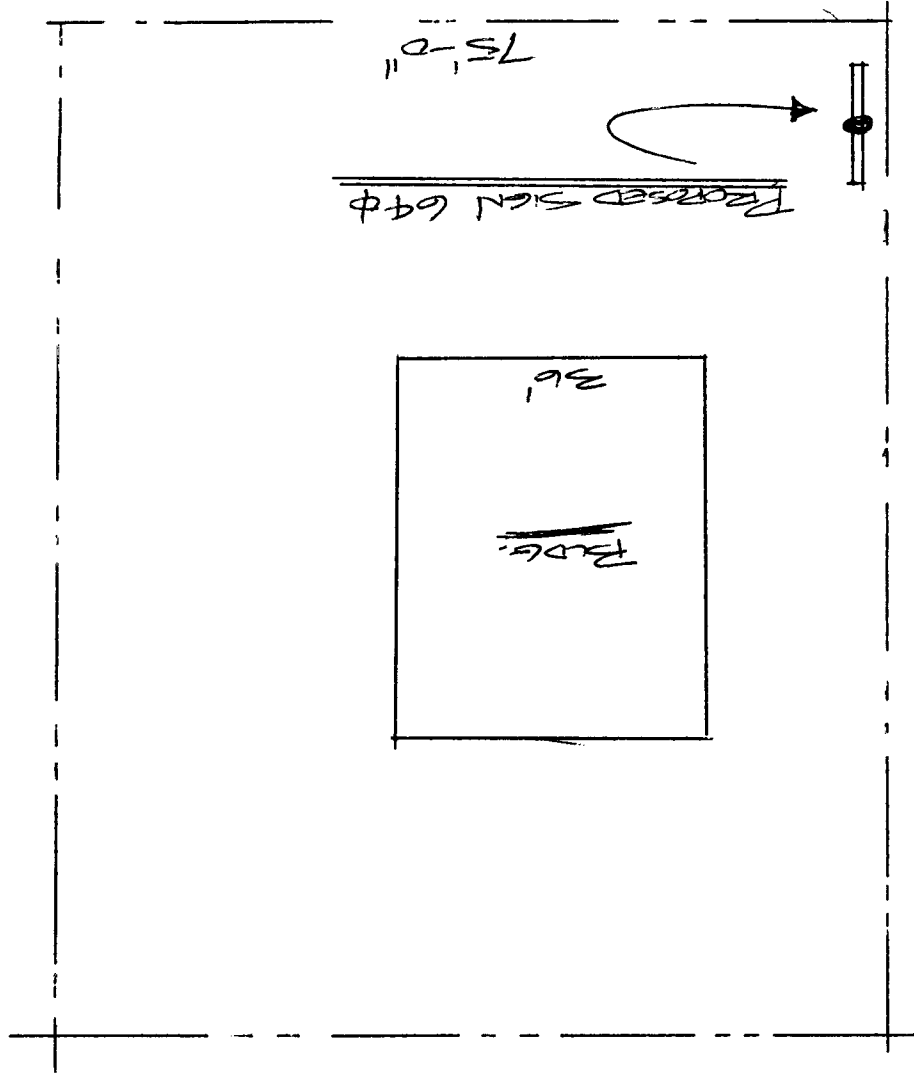

North ↓

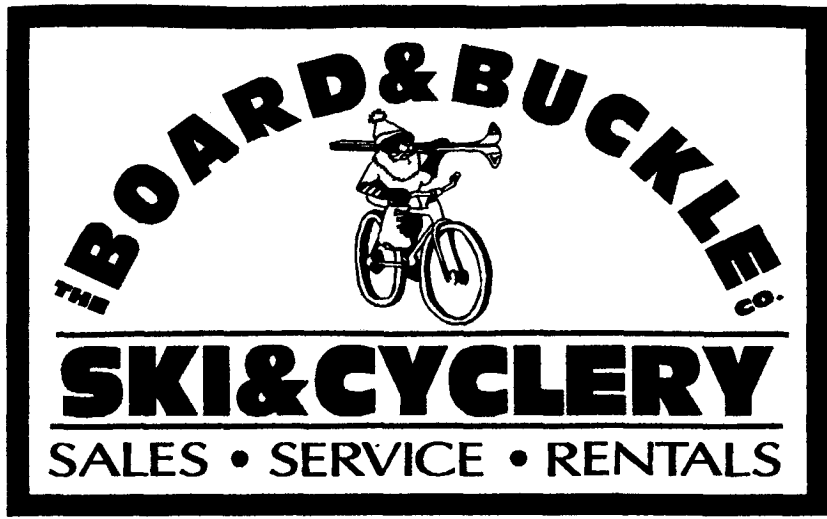

5'x8' = 40¢

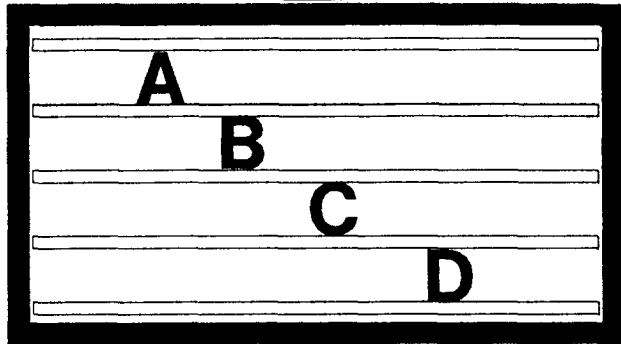

4'x6' = 24¢

64¢ TOTAL

10'-0"

2'-0" O.A.

12'-0"

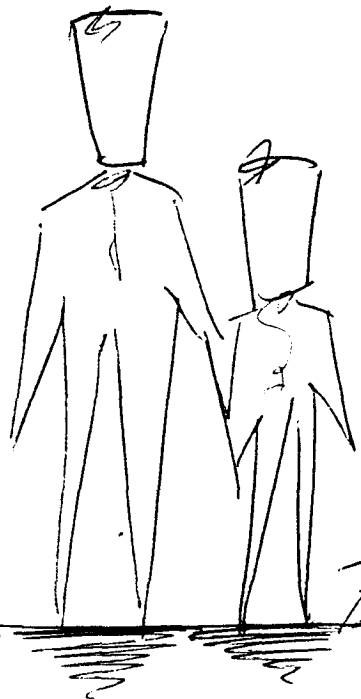

Bud's '96