



# SIGN PERMIT

Community Development Department  
250 North 5th Street  
Grand Junction, CO 81501  
(970) 244-1430

Permit No. \_\_\_\_\_  
Date Submitted 6-2-97  
FEE \$ 25.00  
Tax Schedule 2945-241-23-014  
Zone C-

Lot 15-19, Bk 1 Cannon Add.  
to Orchard Mesa H.  
Sect. 26-15.121

BUSINESS NAME MIA ~~Maha Thai~~  
STREET ADDRESS 757 Hwy 50  
PROPERTY OWNER Earl & Mary J. Payne  
OWNER ADDRESS 410 Mesa Ct  
E. J. Co 81501

CONTRACTOR Western Neon Sign Co.  
LICENSE NO. 2960496  
ADDRESS 2495 Industrial BLVD  
TELEPHONE NO. 242-7843

- 1. FLUSH WALL 2 Square Feet per Linear Foot of Building Facade
- Face Change Only (2,3 & 4):
- 2. ROOF 2 Square Feet per Linear Foot of Building Facade
- 3. FREE-STANDING 2 Traffic Lanes - 0.75 Square Feet x Street Frontage  
4 or more Traffic Lanes - 1.5 Square Feet x Street Frontage
- 4. PROJECTING 0.5 Square Feet per each Linear Foot of Building Facade

Existing Externally or Internally Illuminated - No Change in Electrical Service  Non-Illuminated

(1 - 4) Area of Proposed Sign 65 ~~60~~ Square Feet 66'x10' Face Change only  
(1,2,4) Building Facade 44' Linear Feet  
(1 - 4) Street Frontage 122 Linear Feet  
(2,4) Height to Top of Sign 25 Feet Clearance to Grade 15 Feet

Existing Signage/Type: <u>  </u>	
<u>2' x 6'6" Readerboard</u>	<u>13.7</u> Sq. Ft.
	Sq. Ft.
	Sq. Ft.
Total Existing:	Sq. Ft.

● FOR OFFICE USE ONLY ●		
Signage Allowed on Parcel:		
Building	<u>88</u>	Sq. Ft.
Free-Standing	<u>183</u>	Sq. Ft.
Total Allowed:	<u>183</u>	Sq. Ft.

COMMENTS: Remove existing MIA's Stop n' Eat faces & repaint to  
~~Maha~~ <sup>MIA</sup> Thia Restaurant & reinstall to the cabinet

NOTE: No sign may exceed 300 square feet. A separate sign permit is required for each sign. Attach a sketch of proposed and existing signage including types, dimensions, lettering, abutting streets, alleys, easements, property lines, and locations.

[Signature] 4-21-97 [Signature] 5/30/97  
Applicant's Signature Date Community Development Approval Date

(White: Community Development) (Canary: Applicant) (Pink: Code Enforcement)

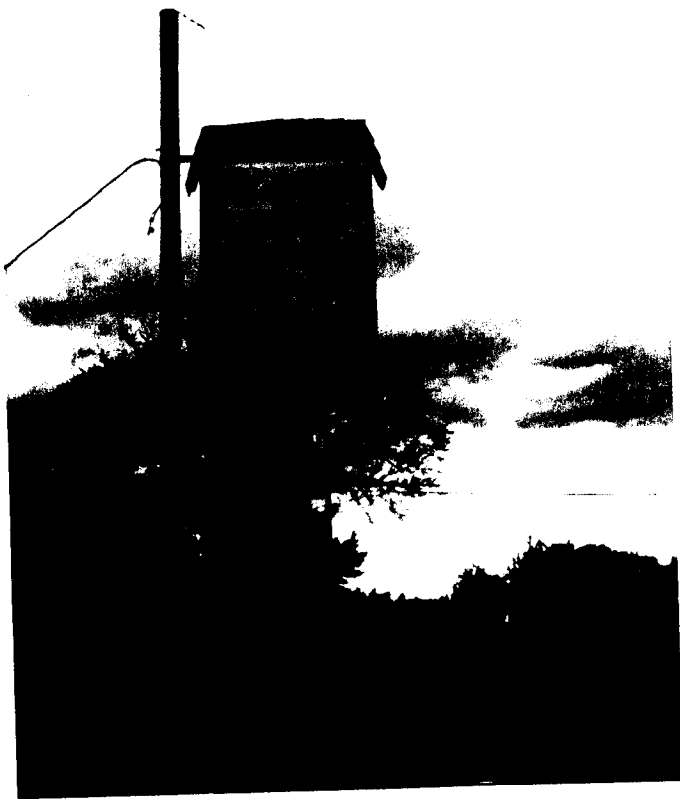

757 Hwy 50 To Delta →

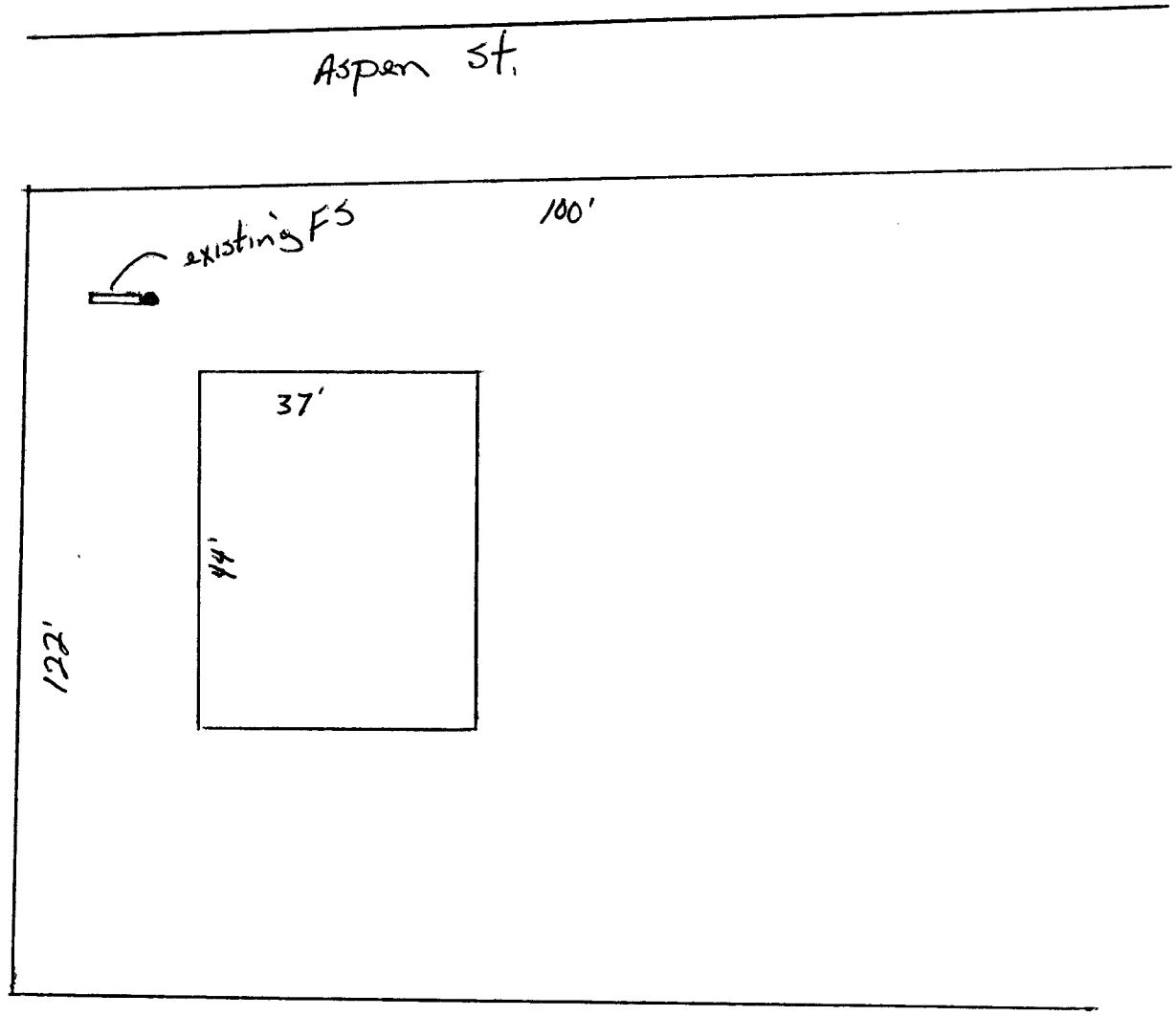

6 1/2'



8'

