

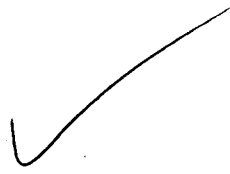

SIGN CLEARANCE



Community Development Department
 250 North 5th Street
 Grand Junction, CO 81501
 (970) 244-1430

Clearance No. 661600
 Date Submitted 8-13-97
 FEE \$ 25.00
 Tax Schedule 2945-104-21-021
 Zone C-2

BUSINESS NAME Motor City Transmissions CONTRACTOR Canvas Products Co
 STREET ADDRESS 1405 Motor Street LICENSE NO. 2950254 2920181
 PROPERTY OWNER _____ ADDRESS 580 25 Road
 OWNER ADDRESS _____ TELEPHONE NO. 292-1453

- 1. FLUSH WALL 2 Square Feet per Linear Foot of Building Facade
- 2. ROOF 2 Square Feet per Linear Foot of Building Facade
- 3. FREE-STANDING 2 Traffic Lanes - 0.75 Square Feet x Street Frontage
4 or more Traffic Lanes - 1.5 Square Feet x Street Frontage
- 4. PROJECTING 0.5 Square Feet per each Linear Foot of Building Facade
- 5. OFF-PREMISE See #3 Spacing Requirements; Not > 300 Square Feet or < 15 Square Feet

Externally Illuminated Internally Illuminated Non-Illuminated

- (1 - 5) Area of Proposed Sign 27 Square Feet
- (1,2,4) Building Facade 125 Linear Feet
- (1 - 4) Street Frontage 165' Linear Feet
- (2,4,5) Height to Top of Sign - Feet Clearance to Grade _____ Feet
- (5) Distance from all Existing Off-Premise Signs within 600 Feet _____ Feet

Existing Signage/Type:	
Wall Sign	32
WALL Sign	32 Sq. Ft.
Pole Sign	12 Sq. Ft.
Pole sign	12
★ All other Signage to be removed	Sq. Ft.
Total Existing:	94 94 Sq. Ft.

● FOR OFFICE USE ONLY ●	
Signage Allowed on Parcel:	
Building	250 Sq. Ft.
Free-Standing	124 Sq. Ft.
Total Allowed:	250 Sq. Ft.

COMMENTS: _____

NOTE: No sign may exceed 300 square feet. A separate sign clearance is required for each sign. Attach a sketch of proposed and existing signage including types, dimensions, lettering, abutting streets, alleys, easements, property lines, and locations. **A SEPARATE PERMIT FROM THE BUILDING DEPARTMENT IS REQUIRED.**

[Signature] 8-13-97 [Signature] 8/14/97
 Applicant's Signature Date Community Development Approval Date

(White: Community Development) (Canary: Applicant) (Pink: Building Dept) (Goldenrod: Code Enforcement)

AMERAS Products Co
580 25 Road
G-D Co 81605
27-1253
Tom Dykstra

Site Plan

Motor City
1105 Motor Street
G.D. Co 81605
Motor
712-8126

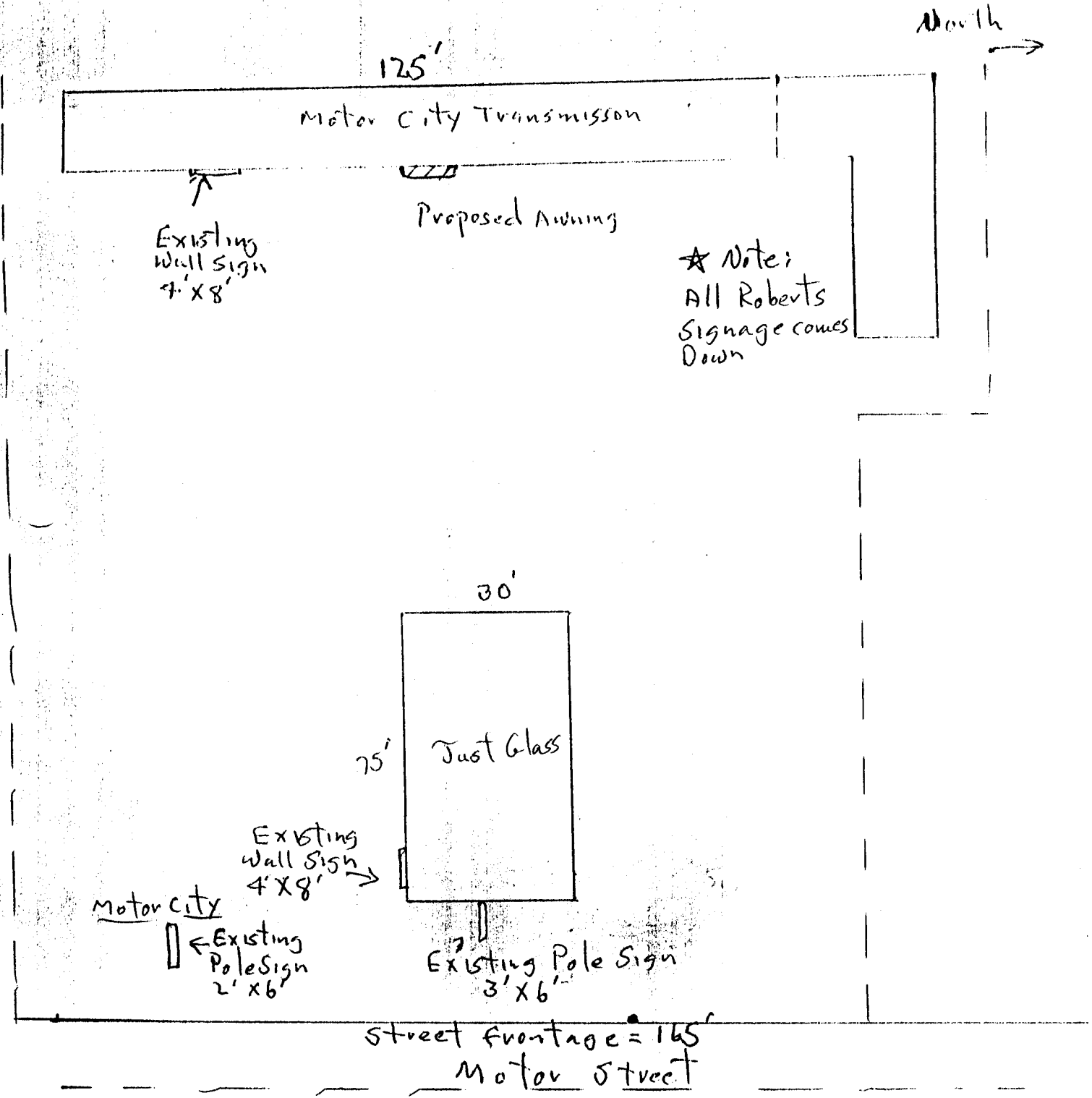

9'



Monte's
MOTOR CITY

3
TRANSMISSIONS

OFFICE

PURCHASE ORDER NO. _____ DATE: 8-1-87
 NAME: Monte's Motor City PHONE: _____
 ADDRESS: _____ QUOTE (if any) _____
 PROMISED BY: _____
 INSTRUCTIONS: Cooley - Green # 2108

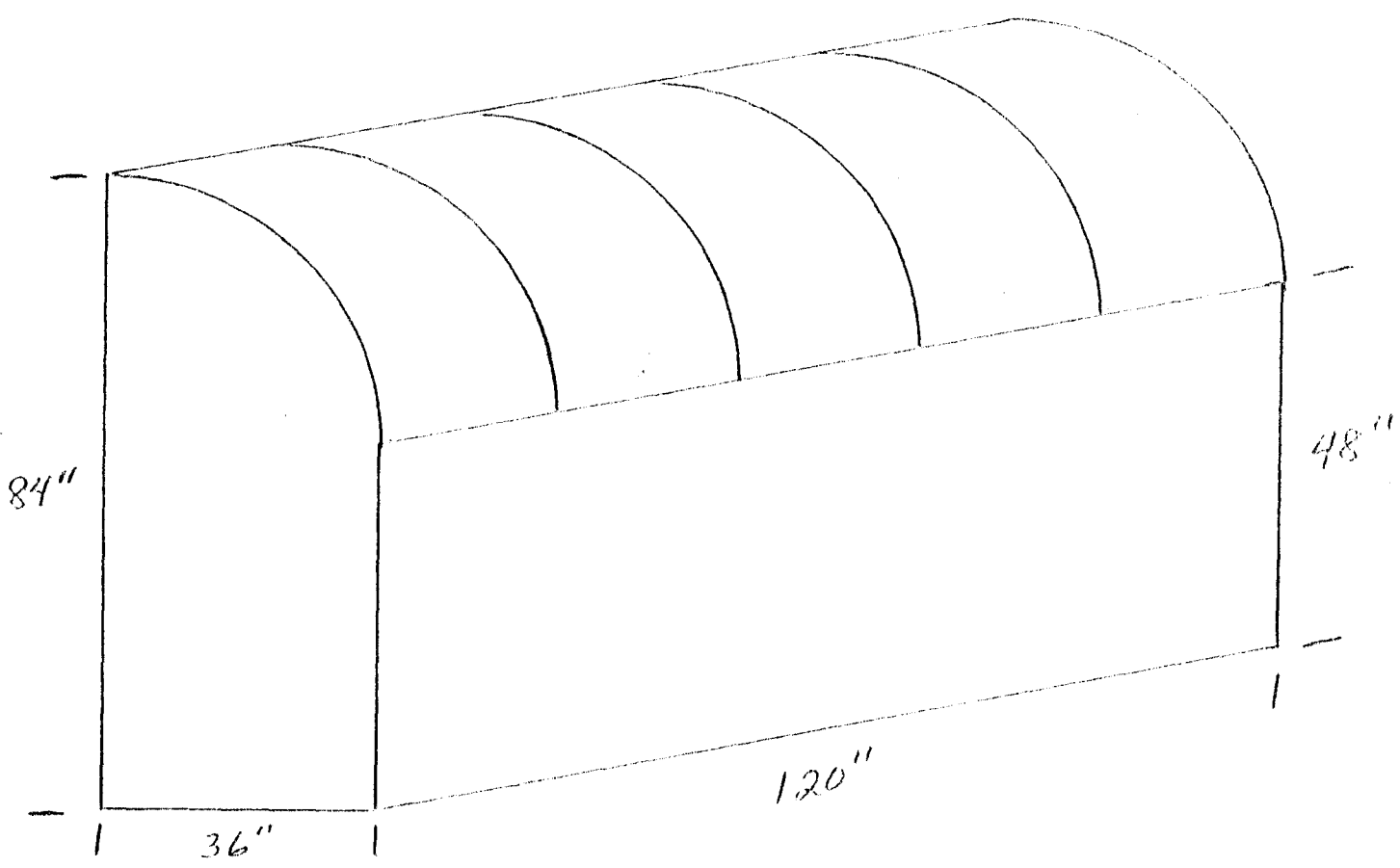

Operator _____
 Material & Hardware Used _____

Notified _____
 Inv. No. _____

Total Time _____
 Total Material _____
 City Tax _____
 County Tax _____
 State Tax _____