



SIGN CLEARANCE

Community Development Department
250 North 5th Street
Grand Junction, CO 81501
(970) 244-1430

Clearance No. 43206
Date Submitted 11-13-97
FEE \$ 25.-
Tax Schedule 2945-133-16-008
Zone C-2

BUSINESS NAME SIMPSON Auto
STREET ADDRESS 1801 E. Main
PROPERTY OWNER Clarence Simpson
OWNER ADDRESS 2244 Kinston Rd
GJ. 81503

CONTRACTOR Western Neon Sign Co
LICENSE NO. 297 0446
ADDRESS 2495 Industrial Blvd.
TELEPHONE NO. 242 7843

- 1. FLUSH WALL 2 Square Feet per Linear Foot of Building Facade
- 2. ROOF 2 Square Feet per Linear Foot of Building Facade
- 3. FREE-STANDING 2 Traffic Lanes - 0.75 Square Feet x Street Frontage
4 or more Traffic Lanes - 1.5 Square Feet x Street Frontage
- 4. PROJECTING 0.5 Square Feet per each Linear Foot of Building Facade
- 5. OFF-PREMISE See #3 Spacing Requirements; Not > 300 Square Feet or < 15 Square Feet

Externally Illuminated Internally Illuminated Non-Illuminated

- (1 - 5) Area of Proposed Sign 70 Square Feet
- (1,2,4) Building Facade 42 Linear Feet
- (1 - 4) Street Frontage 158 Linear Feet Main St.
- (2,4,5) Height to Top of Sign 17 Feet Clearance to Grade 12 Feet
- (5) Distance from all Existing Off-Premise Signs within 600 Feet _____ Feet

Existing Signage/Type:	
	Sq. Ft.
	Sq. Ft.
	Sq. Ft.
Total Existing: <u>0</u>	Sq. Ft.

● FOR OFFICE USE ONLY ●		
Signage Allowed on Parcel:		
Building	<u>84</u>	Sq. Ft.
Free-Standing	<u>118.5</u>	Sq. Ft.
Total Allowed:	<u>118.5</u>	Sq. Ft.

COMMENTS: Existing sign @ W+50, moving to E Main. Doing to reface & repair.

NOTE: No sign may exceed 300 square feet. A separate sign clearance is required for each sign. Attach a sketch of proposed and existing signage including types, dimensions, lettering, abutting streets, alleys, easements, property lines, and locations. **A SEPARATE PERMIT FROM THE BUILDING DEPARTMENT IS REQUIRED.**

Ray McNamee 11/12/97 Mike Pelletier 11/13/97
Applicant's Signature Date Community Development Approval Date

(White: Community Development) (Canary: Applicant) (Pink: Building Dept) (Goldenrod: Code Enforcement)

Barns Electric 2466

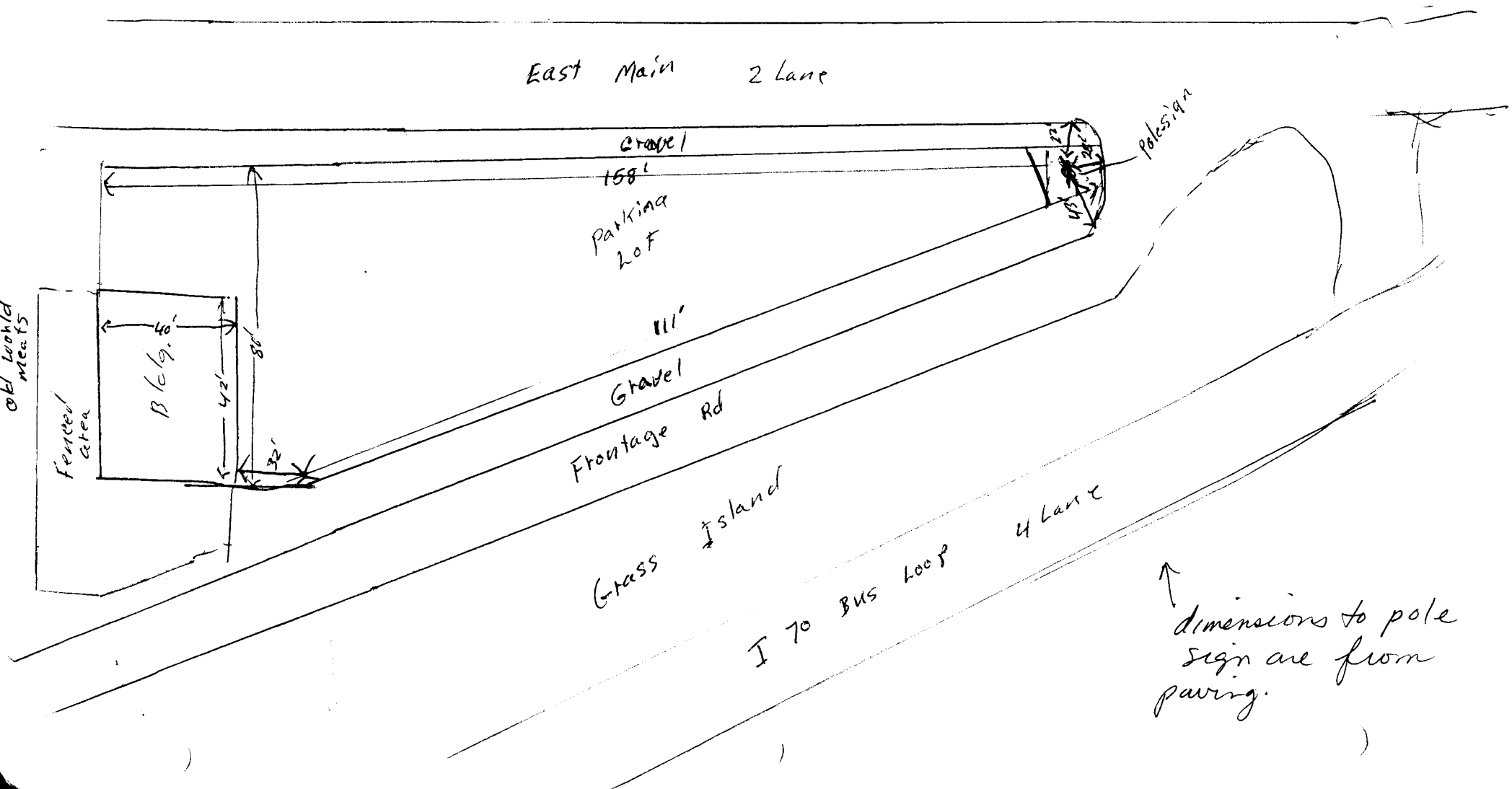
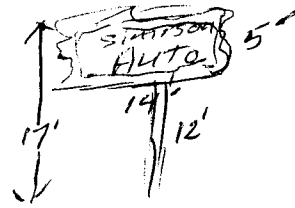

↑
 dimensions to pole
 sign are from
 paving.