



SIGN CLEARANCE

Community Development Department
250 North 5th Street
Grand Junction, CO 81501
(970) 244-1430

Clearance No. U 2595
Date Submitted 10/24/97
FEE \$ 25.00
Tax Schedule ~~2945-054.02.003~~
Zone C-2

BUSINESS NAME YOUNG ELECTRIC SIGN CO. CONTRACTOR YOUNG ELECTRIC SIGN CO.
STREET ADDRESS 2393 F 1/2 RD. LICENSE NO. 175151
PROPERTY OWNER JIM EASTER ADDRESS 2393 F 1/2 RD.
OWNER ADDRESS Box 279 CORY CO 81414 TELEPHONE NO. 242-7880

- 1. FLUSH WALL 2 Square Feet per Linear Foot of Building Facade
- 2. ROOF 2 Square Feet per Linear Foot of Building Facade
- 3. FREE-STANDING 2 Traffic Lanes - 0.75 Square Feet x Street Frontage
4 or more Traffic Lanes - 1.5 Square Feet x Street Frontage
- 4. PROJECTING 0.5 Square Feet per each Linear Foot of Building Facade
- 5. OFF-PREMISE See #3 Spacing Requirements; Not > 300 Square Feet or < 15 Square Feet

Externally Illuminated Internally Illuminated Non-Illuminated

- (1 - 5) Area of Proposed Sign 55 Square Feet
- (1,2,4) Building Facade N/A Linear Feet
- (1 - 4) Street Frontage 150 Linear Feet
- (2,4,5) Height to Top of Sign 14 Feet Clearance to Grade 8 Feet
- (5) Distance from all Existing Off-Premise Signs within 600 Feet _____ Feet

Existing Signage/Type:	Sq. Ft.
<u>NONE</u>	
	Sq. Ft.
	Sq. Ft.
Total Existing:	Sq. Ft.

● FOR OFFICE USE ONLY ●	
Signage Allowed on Parcel:	
Building	<u>200.0</u> Sq. Ft.
Free-Standing	<u>112.5</u> Sq. Ft.
Total Allowed:	<u>200.0</u> Sq. Ft.

COMMENTS: _____

NOTE: No sign may exceed 300 square feet. A separate sign clearance is required for each sign. Attach a sketch of proposed and existing signage including types, dimensions, lettering, abutting streets, alleys, easements, property lines, and locations. **A SEPARATE PERMIT FROM THE BUILDING DEPARTMENT IS REQUIRED.**

John Easter 10/22/97 Walter Z. Caldwell 10/22/97
Applicant's Signature Date Community Development Approval Date

(White: Community Development) (Canary: Applicant) (Pink: Building Dept) (Goldenrod: Code Enforcement)

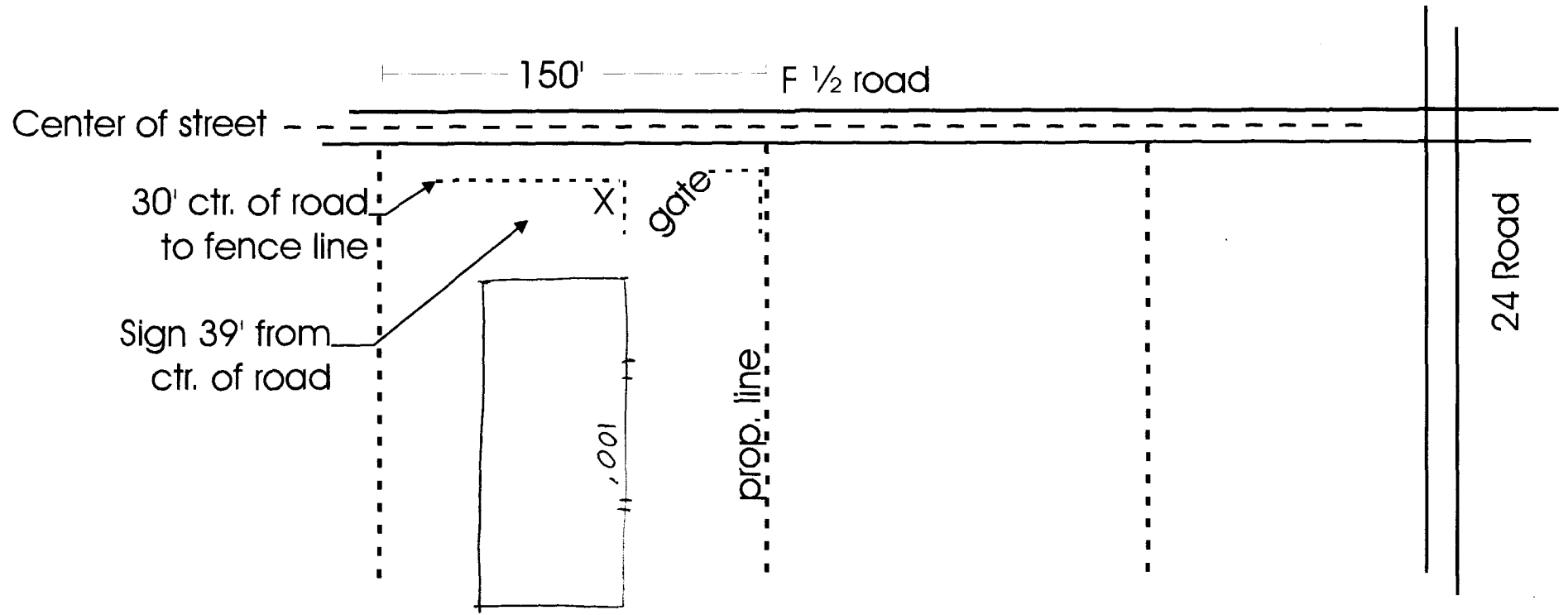

not to scale

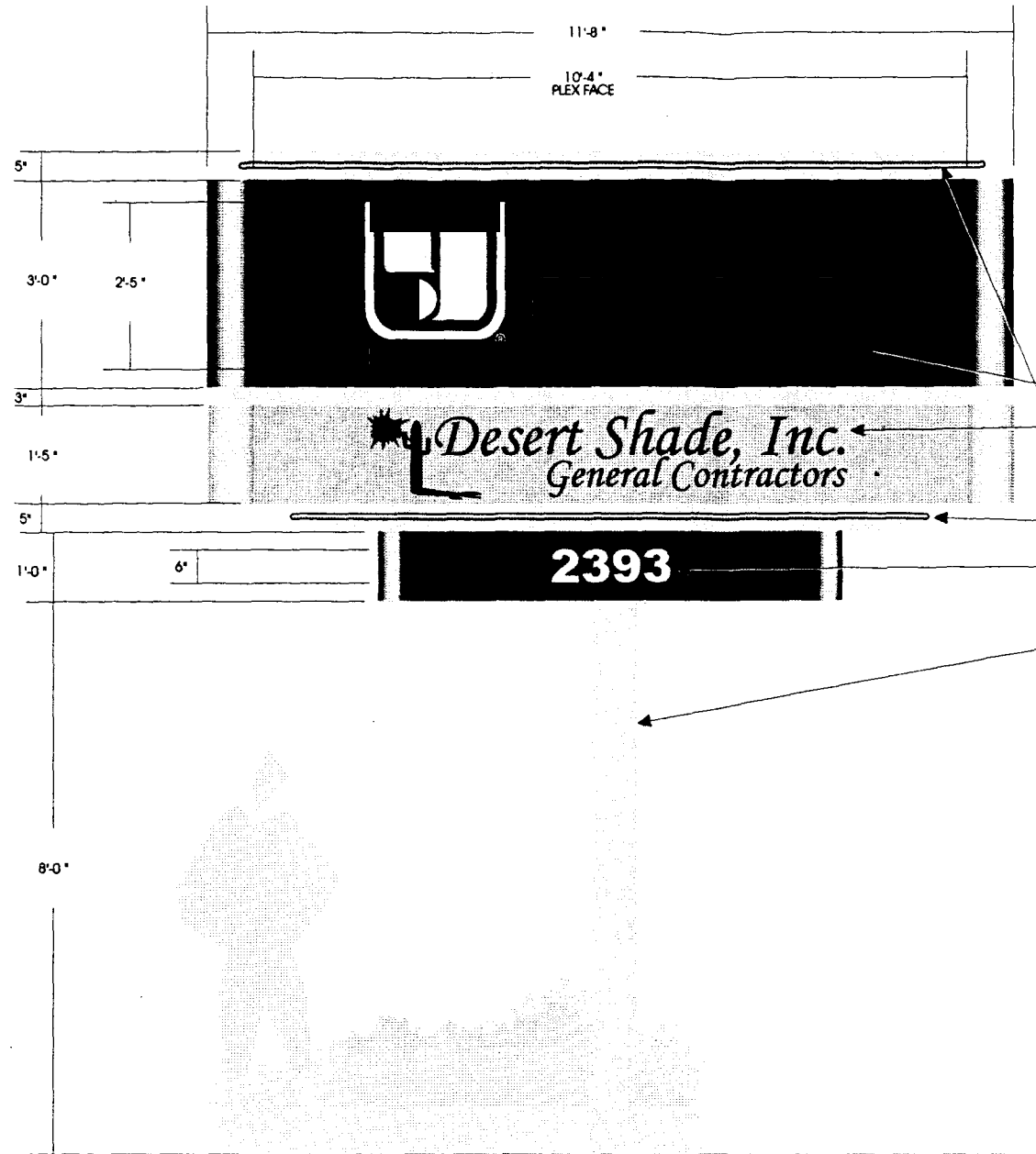

REFURBISH & INSTALL (1) S/F 14'-6" OAH SIGN

CABINETS of ALUMINUM W/ RADIUS ENDS & HIDDEN RETAINERS

PAINT TOP, BOTTOM & MIDDLE REVEALS WHITE, TOP CABINET YESCO RED, BOTTOM CABINET GREY TO MATCH 3M VINYL MED GREY #220-31 (ALL SEMI-GLOSS)

FACES OF 1/4" WHITE PLEX W/ (2nd SURFACE CHANGE TRACK HIDDEN RETAINERS)

FACE DECORATION BACKGROUND OPAQUE TO MATCH CABINET ENDS (EITHER PAINT OR VINYL)
 "YESCO" COPY & LOGO REVERSE-TO-WHITE.
 "DESERT ..." COPY & LOGO BURGUNDY #230-49

ILLUMINATION W/ T12 CW/HO 800mA FLUORESCENT LAMPS
 BORDER TUBE OF 15mm CL RED NEON 30mA

"2393" NON-ILLUM WHITE VINYL FONT: ARIAL BLACK

NEW 8"(.322) PIPE
 PAINT WHITE

55 SQ. FT.
 14' O.A. HEIGHT

7-7	NAME	YESCO
	ADDRESS	2393 F 1/2 Rd, Unit # 1, G.J.
	SALESMAN	JOHN HEEMSTRA
	ORIGINAL DATE	6/30/97
	DESIGNER	DOUG TURNER
	REVISION	8/12/97
		YOUNG ELECTRIC SIGN COMPANY 2393 F 1/2 Road, Unit 1 Grand Junction, CO 81505 (970) 242-7880

DISPOSAL: THE ORIGINAL IDEAS HEREIN ARE THE PROPERTY OF YOUNG ELECTRIC SIGN COMPANY. PERMISSION TO USE COPY OR REPRODUCE THIS DRAWING MUST BE OBTAINED BY WRITTEN AGREEMENT. SEE YOUR SALES REPRESENTATIVE FOR THE NEAREST OFFICE.