



SIGN CLEARANCE

2 of 3

(B)

Community Development Department
250 North 5th Street
Grand Junction, CO 81501
(970) 244-1430

Clearance No. 43215
Date Submitted 4-17-97
FEE \$ 5.00
Tax Schedule 2943-181-05-022
Zone C-1

BUSINESS NAME SALLY BEAUTY SUPPLY
STREET ADDRESS 2889 NORTH AVE.
PROPERTY OWNER UNKNOWN
OWNER ADDRESS SAME

CONTRACTOR BUD'S SIGNS
LICENSE NO. 2970109
ADDRESS 1055 UTE
TELEPHONE NO. 245-7700

- 1. FLUSH WALL 2 Square Feet per Linear Foot of Building Facade
- 2. ROOF 2 Square Feet per Linear Foot of Building Facade
- 3. FREE-STANDING 2 Traffic Lanes - 0.75 Square Feet x Street Frontage
4 or more Traffic Lanes - 1.5 Square Feet x Street Frontage
- 4. PROJECTING 0.5 Square Feet per each Linear Foot of Building Facade
- 5. OFF-PREMISE See #3 Spacing Requirements; Not > 300 Square Feet or < 15 Square Feet

Externally Illuminated Internally Illuminated Non-Illuminated



- (1 - 5) Area of Proposed Sign 51 Square Feet
- (1,2,4) Building Facade 52 Linear Feet (NORTH AVE)
- (1 - 4) Street Frontage 100ft Linear Feet 130ft
- (2,4,5) Height to Top of Sign 14 Feet Clearance to Grade 11 Feet
- (5) Distance from all Existing Off-Premise Signs within 600 Feet N/A Feet

| Existing Signage/Type: | Sq. Ft. |
|-------------------------|---------------|
| FREESTANDING | |
| FREESTANDING | 40 |
| | 40 |
| Total Existing: | 80 |

| ● FOR OFFICE USE ONLY ● | | |
|---|------------|---------|
| Signage Allowed on Parcel: <u>NORTH AVE</u> | | |
| Building | <u>104</u> | Sq. Ft. |
| Free-Standing | <u>195</u> | Sq. Ft. |
| Total Allowed: | <u>195</u> | Sq. Ft. |

COMMENTS:

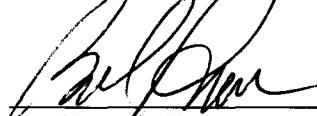
NOTE: No sign may exceed 300 square feet. A separate sign clearance is required for each sign. Attach a sketch of proposed and existing signage including types, dimensions, lettering, abutting streets, alleys, easements, property lines, and locations. **A SEPARATE PERMIT FROM THE BUILDING DEPARTMENT IS REQUIRED.**

4-17-97

4-18-97

Applicant's Signature Date Community Development Approval Date

(White: Community Development) (Canary: Applicant) (Pink: Building Dept) (Goldenrod: Code Enforcement)

PROPOSED SIGNS

(A) 51φ

(B) 51φ

(C) 51φ

← NORTH AVE →
100' ±

NORTH ↑

EXISTING
FREESTANDING
40φ

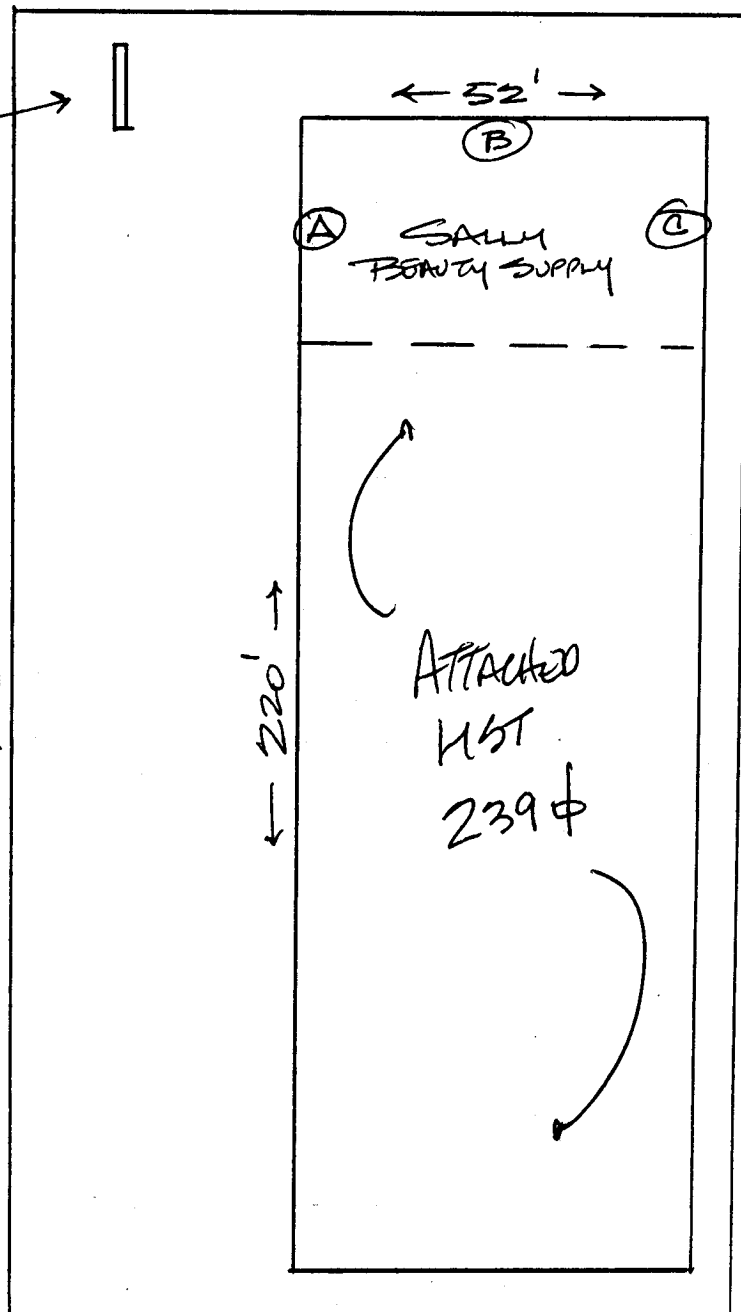

← 52' →

(B)

(A)

SALLY
BEAUTY SUPPLY

(C)

← MELODY LANE →

← 220' →

← 220' →

Attached
H&T
239φ

EXISTING SIGNS

| | |
|------------------|-----|
| HI OCEANUS | 26¢ |
| FANTASTIC SAMS | 48¢ |
| R.M JENKINS | 36¢ |
| BAKERY | 30¢ |
| A-SUNGS | 30¢ |
| TROPICAL ISLAND | 24¢ |
| SECURITY PACIFIC | 45¢ |

TOTAL 239¢

2270

17'-0"

36"

SALLY BEAUTY SUPPLY

16"
16"

SIDE SIGN

INDIVIDUAL LIT LETTER SECTION

PN# 36NC-R

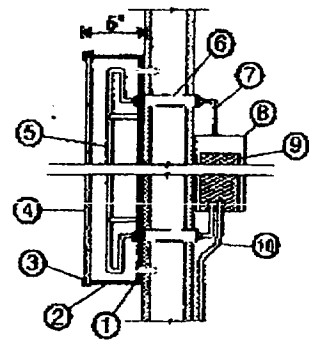

- 1) .050 ALUMINUM BACK
- 2) .040 BLACK RETURN
- 3) BLACK TRIM CAP
- 4) RED ACRYLIC FACE (ROHM & HAAS #2263)
- 5) RED NEON TUBE
- 8) ELECTRO-BITS
- 7) METAL CONDUIT W/ GTO WIRE
- 8) TRANSFORMER BOX
- 9) 30 MA TRANSFORMER
- 10) 120 VOLT SERVICE

All 3 signs look like this one

| | | | | | | | |
|---------|-------|-------------|----------|-------------------|------|-----------|---|
| Project | City | Salesperson | Scale | Customer Approval | Date | Revisions | schad-tracy signs 125 Minnesota Ave. N Oronoco, MN 55959 (507) 367-2631 1610 E. Cliff Road Burnsville, MN 55337 (612) 884-2421 (507) 367-2633 (Fax) (612) 894-2748 (Fax) |
| Address | State | Date | Drawn by | | | | |

HR 27 '97 10:04AM SCHAD TRACY SIGNS