



PERMIT SIGN CLEARANCE

Community Development Department
250 North 5th Street
Grand Junction, CO 81501
(970) 244-1430

Clearance No. _____
Date Submitted _____
FEE \$ 25.00
Tax Schedule 2945-142-02-002
Zone C2

BUSINESS NAME GJ Auto Source
STREET ADDRESS 261 North ave
PROPERTY OWNER Darren Cusi
OWNER ADDRESS 261 North ave

CONTRACTOR Platinum Sign Co.
LICENSE NO. 2980732
ADDRESS 620 Noland ave
TELEPHONE NO. 248-9677

- 1. FLUSH WALL 2 Square Feet per Linear Foot of Building Facade
- 2. ROOF 2 Square Feet per Linear Foot of Building Facade
- 3. FREE-STANDING 2 Traffic Lanes - 0.75 Square Feet x Street Frontage
4 or more Traffic Lanes - 1.5 Square Feet x Street Frontage
- 4. PROJECTING 0.5 Square Feet per each Linear Foot of Building Facade
- 5. OFF-PREMISE See #3 Spacing Requirements; Not > 300 Square Feet or < 15 Square Feet

Externally Illuminated Internally Illuminated Non-Illuminated

- (1 - 5) Area of Proposed Sign 57.76 Square Feet
- (1,2,4) Building Facade 93 Linear Feet
- (1 - 4) Street Frontage 100 Linear Feet
- (2,4,5) Height to Top of Sign 25 Feet Clearance to Grade 17'6" Feet
- (5) Distance from all Existing Off-Premise Signs within 600 Feet N/A Feet

Existing Signage/Type:	
Hand Painted / Auto Source	45 Sq. Ft.
Hand Painted / WC Finance	100 Sq. Ft.
Hand Painted / STOP	100 Sq. Ft.
Total Existing:	<u>0</u> 245 Sq. Ft.

● FOR OFFICE USE ONLY ●		
Signage Allowed on Parcel:		
Building	<u>186</u>	Sq. Ft.
Free-Standing	<u>150</u>	Sq. Ft.
Total Allowed:	<u>186</u>	Sq. Ft.

COMMENTS: existing pole sign - new face only

NOTE: No sign may exceed 300 square feet. A separate sign clearance is required for each sign. Attach a sketch of proposed and existing signage including types, dimensions, lettering, abutting streets, alleys, easements, property lines, and locations. **A SEPARATE PERMIT FROM THE BUILDING DEPARTMENT IS REQUIRED.**

Bill L. Bolson 7-22-98
Applicant's Signature Date

Mike Pelletier 7/27/98
Community Development Approval Date

(White: Community Development) (Canary: Applicant) (Pink: Building Dept) (Goldenrod: Code Enforcement)

MAIN ID SIGN

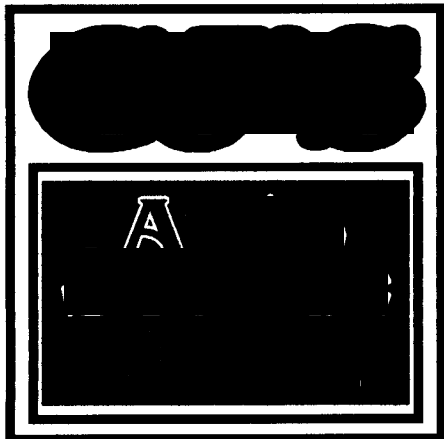

BUISNESS CARDS

DETAIL OF MAIN ID



8 7'6" X 7'6"



THIS ARTWORK WAS PREPARED BY AND IS THE PROPERTY OF PLATINUM SIGN CO. ANY UNAUTHORIZED USE OF SAME, IN WHOLE OR PART IS PROHIBITED.

North ave

GT Auto Source

100'

Existing pole
Proposed
7'6" X 7'6"
Internally illuminated

261 North ave

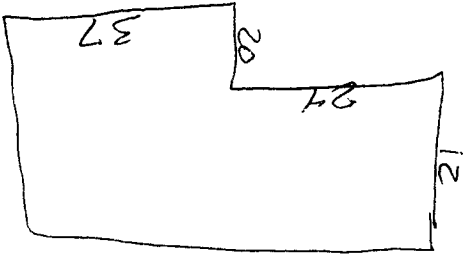

135'

3rd st

Alley

125'

50'