



# SIGN CLEARANCE

Community Development Department  
250 North 5th Street  
Grand Junction, CO 81501  
(970) 244-1430

*Call when ready*

Clearance No. U42101  
Date Submitted 3-6-98  
FEE \$ 25.00  
Tax Schedule 2945-103-34-002  
Zone C-2

BUSINESS NAME Murphy + Associates CONTRACTOR Canvas Products Co  
STREET ADDRESS 533 Bogart Lane (Unit A) LICENSE NO. 2980131  
PROPERTY OWNER JACK Bogart ADDRESS 580 25 Road  
OWNER ADDRESS 527 Bogart Lane TELEPHONE NO. 242-1452

- 1. FLUSH WALL 2 Square Feet per Linear Foot of Building Facade
- 2. ROOF 2 Square Feet per Linear Foot of Building Facade
- 3. FREE-STANDING 2 Traffic Lanes - 0.75 Square Feet x Street Frontage  
4 or more Traffic Lanes - 1.5 Square Feet x Street Frontage
- 4. PROJECTING 0.5 Square Feet per each Linear Foot of Building Facade
- 5. OFF-PREMISE See #3 Spacing Requirements; Not > 300 Square Feet or < 15 Square Feet

Externally Illuminated       Internally Illuminated       Non-Illuminated

- (1 - 5) Area of Proposed Sign 10 Square Feet
- (1,2,4) Building Facade 48 Linear Feet
- (1 - 4) Street Frontage 48 Linear Feet
- (2,4,5) Height to Top of Sign \_\_\_\_\_ Feet Clearance to Grade \_\_\_\_\_ Feet
- (5) Distance from all Existing Off-Premise Signs within 600 Feet \_\_\_\_\_ Feet

Existing Signage/Type:	
<u>Flush wall</u>	<u>8</u> Sq. Ft.
	Sq. Ft.
	Sq. Ft.
Total Existing:	<u>8</u> Sq. Ft.

● FOR OFFICE USE ONLY ●	
Signage Allowed on Parcel:	
Building	<u>448</u> Sq. Ft.
Free-Standing	<u>187.5</u> Sq. Ft.
Total Allowed:	<u>448</u> Sq. Ft.

COMMENTS: \_\_\_\_\_

**NOTE:** No sign may exceed 300 square feet. A separate sign clearance is required for each sign. Attach a sketch of proposed and existing signage including types, dimensions, lettering, abutting streets, alleys, easements, property lines, and locations. **A SEPARATE PERMIT FROM THE BUILDING DEPARTMENT IS REQUIRED.**

*Jack Bogart*      3-6-98      *Mike Bellator*      3/9/98  
 Applicant's Signature      Date      Community Development Approval      Date

(White: Community Development)      (Canary: Applicant)      (Pink: Building Dept)      (Goldenrod: Code Enforcement)

Canvas Products Co  
58025 Road  
242-1453  
Tom Dykstra

# Site Plan

Murphy Associates  
533 Bogart Lane  
241-1800  
Oona Murphy

North ↑

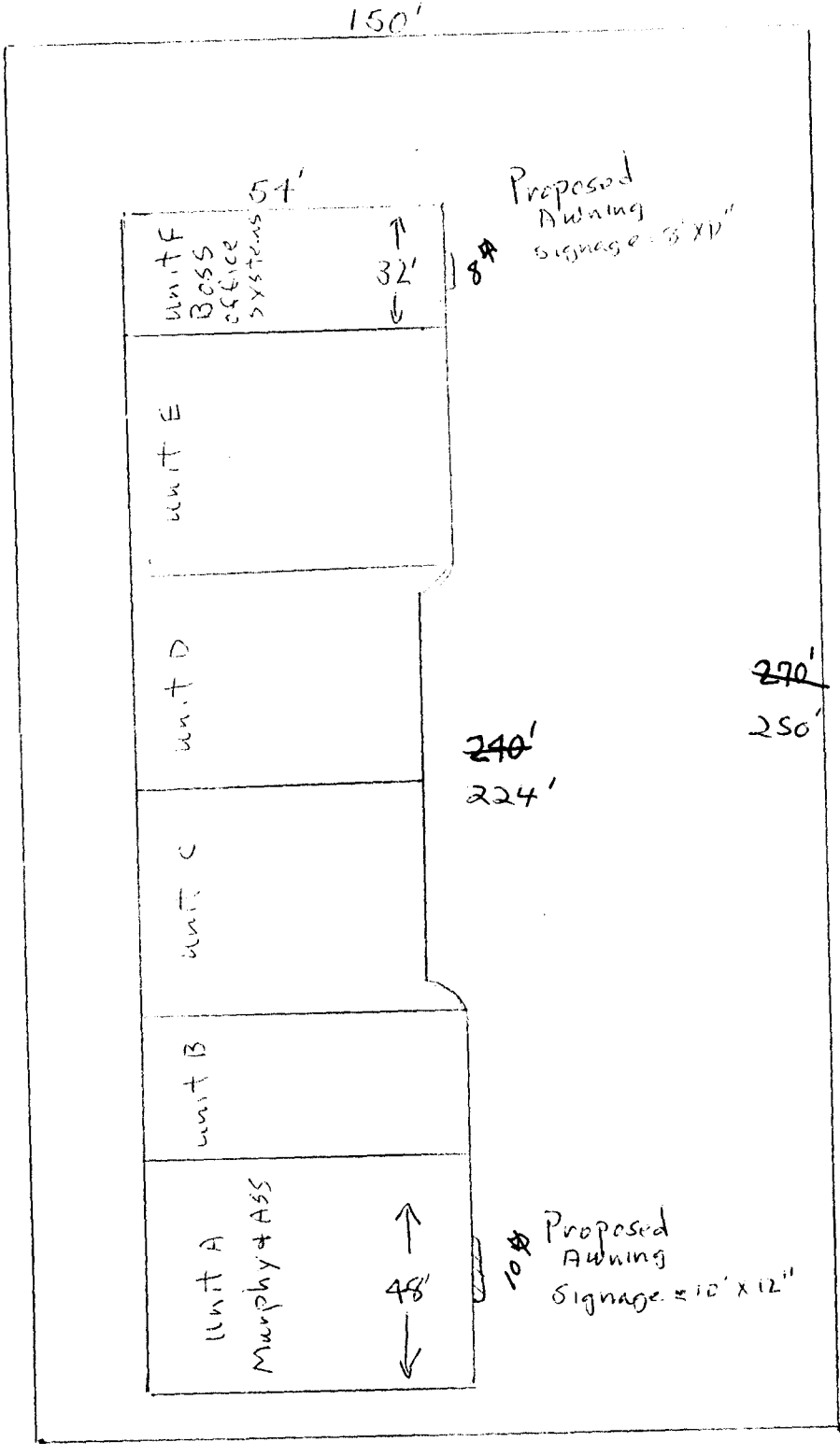

Proposed  
Awning  
Signage 3' x 12"

270'  
250'

240'  
224'

Proposed  
Awning  
Signage 10' x 12"

PURCHASE ORDER NO. \_\_\_\_\_ DATE: 3-5-78

NAME: Murphy & Associates PHONE: \_\_\_\_\_

ADDRESS: \_\_\_\_\_ QUOTE (if any) \_\_\_\_\_

PROMISED BY: \_\_\_\_\_

INSTRUCTIONS: Coolay w/ Coolthane - Eggcrate - Steel Stitch

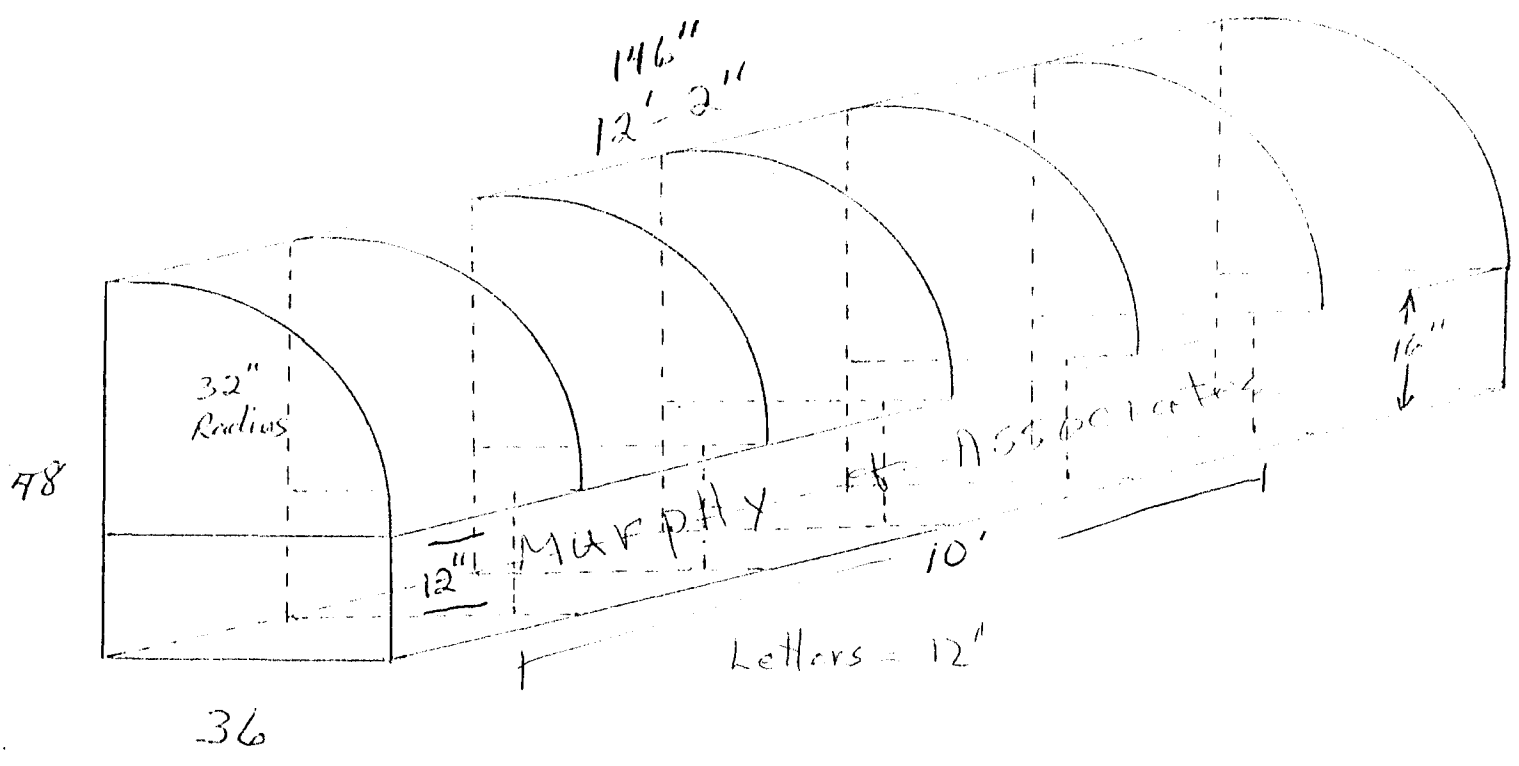

Operator \_\_\_\_\_  
Material & Hardware Used \_\_\_\_\_

\_\_\_\_\_

Notified \_\_\_\_\_  
Inv. No. \_\_\_\_\_

Total Time \_\_\_\_\_  
Total Material \_\_\_\_\_  
City Tax \_\_\_\_\_  
County Tax \_\_\_\_\_  
State Tax \_\_\_\_\_