



Permit

# SIGN CLEARANCE

Community Development Department  
250 North 5th Street  
Grand Junction, CO 81501  
(970) 244-1430

Clearance No. \_\_\_\_\_  
Date Submitted 6-15-98  
FEE \$ 25<sup>00</sup> + 25<sup>00</sup> fine  
Tax Schedule 2701-364-00-117  
Zone H-O

BUSINESS NAME Stop'n Save #3 (UBank)  
STREET ADDRESS 723 Horizon Drive  
PROPERTY OWNER Stop'n Save  
OWNER ADDRESS 723 Horizon Drive

CONTRACTOR Gordon Sign Company  
LICENSE NO. 29410610  
ADDRESS 2430 W. 9th Avenue Denver CO 80204  
TELEPHONE NO. (303) 462-6121

- 1. FLUSH WALL 2 Square Feet per Linear Foot of Building Facade
- 2. ROOF 2 Square Feet per Linear Foot of Building Facade
- 3. FREE-STANDING 2 Traffic Lanes - 0.75 Square Feet x Street Frontage  
4 or more Traffic Lanes - 1.5 Square Feet x Street Frontage
- 4. PROJECTING 0.5 Square Feet per each Linear Foot of Building Facade
- 5. OFF-PREMISE See #3 Spacing Requirements; Not > 300 Square Feet or < 15 Square Feet

Externally Illuminated       Internally Illuminated       Non-Illuminated

- (- 5) Area of Proposed Sign 5.50 Square Feet (1' x 5'5")
- (1,2,4) Building Facade 70' Linear Feet
- (1 - 4) Street Frontage 239' Linear Feet 260
- (2,4,5) Height to Top of Sign \_\_\_\_\_ Feet Clearance to Grade \_\_\_\_\_ Feet
- (5) Distance from all Existing Off-Premise Signs within 600 Feet \_\_\_\_\_ Feet

Existing Signage/Type:	
Wall	109.5 Sq. Ft.
Pole	146.5 Sq. Ft.
	Sq. Ft.
Total Existing:	216 Sq. Ft.

● FOR OFFICE USE ONLY ●	
Signage Allowed on Parcel:	Horizon
Building	140 Sq. Ft.
Free-Standing	390 Sq. Ft.
Total Allowed:	390 Sq. Ft.

COMMENTS: install one U-Bank sign 1' x 5'5" on wood fascia.

NOTE: No sign may exceed 300 square feet. A separate sign clearance is required for each sign. Attach a sketch of proposed and existing signage including types, dimensions, lettering, abutting streets, alleys, easements, property lines, and locations. **A SEPARATE PERMIT FROM THE BUILDING DEPARTMENT IS REQUIRED.**

Megan McCall      6/16/98      Walter Allbeck      6/16/98  
 Applicant's Signature      Date      Community Development Approval      Date

(White: Community Development)      (Canary: Applicant)      (Pink: Building Dept)      (Goldenrod: Code Enforcement)

Stop'n Save #3  
723 Horizon Drive

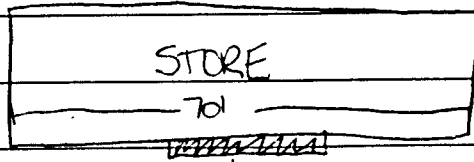
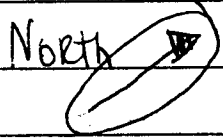

Existing Stop'n Save sign

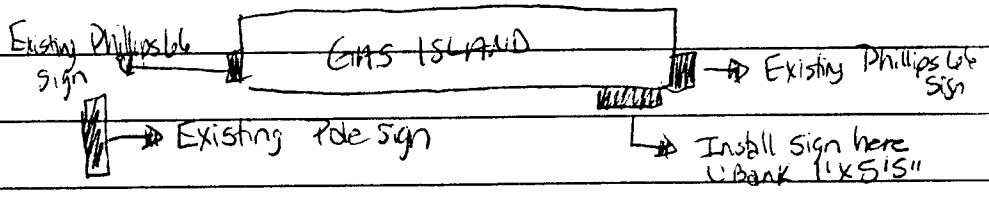

HORIZON

# GORDON SIGN COMPANY

2930 WEST 8TH AVE.  
DENVER, COLO. 80204  
(303) 829-8121

*U-Bank*

2120 NAEGELE ROAD  
COLORADO SPRINGS, COLO. 80904  
(303) 633-7763

## PLOT PLAN

PLOT PLAN FOR Stop'n Save #3 DATE 5/26/98

STREET ADDRESS 723 Horizon Drive

CITY Grand Junction ZONE \_\_\_\_\_ SET BACK \_\_\_\_\_

DRAW SKETCH OF AREA - SHOW GROUND SIGN SET-BACKS

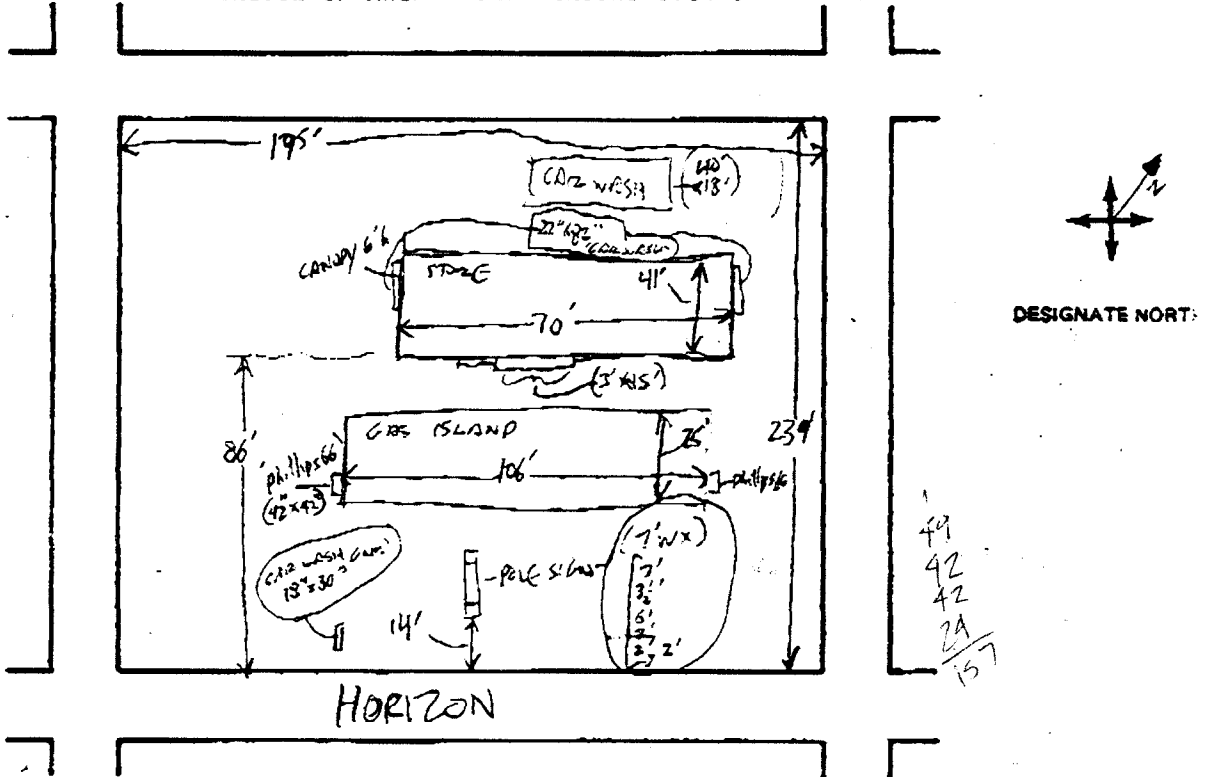

## PERMIT INFORMATION

LOT FRONTAGE: \_\_\_\_\_

BUILDING FRONT: \_\_\_\_\_

AREA AND TYPE OF EXISTING SIGNS: New SF. Ellen Sign  
Painted on front wood fascia

PICTURE \_\_\_\_\_

COMMENTS: New ~~sign~~

SALESMAN: Liley/Tischer

**NOTES:**

1. SIGN FACE TO BE 25' WHITE TRANSLUCENT ACRYLIC. HEAT BEND RETURNS TOP AND BOTTOM FOR ATTACHMENT TO CLADDING. PROVIDE SLOTTED OPENINGS ON RETURNS FOR BOLT ATTACHMENT. CHEM WELD 5' CLEAR ACRYLIC SIDE RETURNS TO SECOND SURFACE OF SIGN FACE AND TOP AND BOTTOM RETURNS. PROVIDE SLOTTED OPENINGS FOR BOLT ATTACHMENT.
2. 'U' TO BE 3M TRANSLUCENT SCOTCHCAL FILM TO MATCH USB RED. USE ARTWORK PROVIDED BY DESIGNER.
3. 'BANK' TO BE 3M TRANSLUCENT SCOTCHCAL FILM TO MATCH USB BLUE. USE ARTWORK PROVIDED BY DESIGNER.
4. 125' ALUM. CLADDING FRONT AS SHOWN. PAINT FINISH TO MATCH USB BLUE. SATIN FINISH.
5. 125' ALUM. CLADDING. PAINT FINISH WHITE. GLOSS FINISH.
6. PAINT FINISH SIGN FACE FIRST SURFACE TO MATCH USB BLUE. SATIN FINISH. ATM SWITCH GRAPHIC TO REVERSE OUT WHITE. USE SPRAY-LAT TO PROTECT SIGN FACE AT GRAPHIC DURING PAINTING PROCESS. USE ARTWORK PROVIDED BY ATM NETWORKS.
7. 'CASH STATION' TO BE 3M SCOTCHCAL TRANSLUCENT FILM TO MATCH CASH-STATION NETWORK SPECIFICATIONS. USE ARTWORK SUPPLIED BY NETWORKS.
8. 125' ALUM. FLUSHED IN ACCESS PANELS TOP AND BOTTOM. PAINT FINISH USB BLUE. SATIN FINISH. ATTACH WITH COUNTERSUNK FLATHEAD STAINLESS STEEL SCREWS. PAINT HEADS TO MATCH.

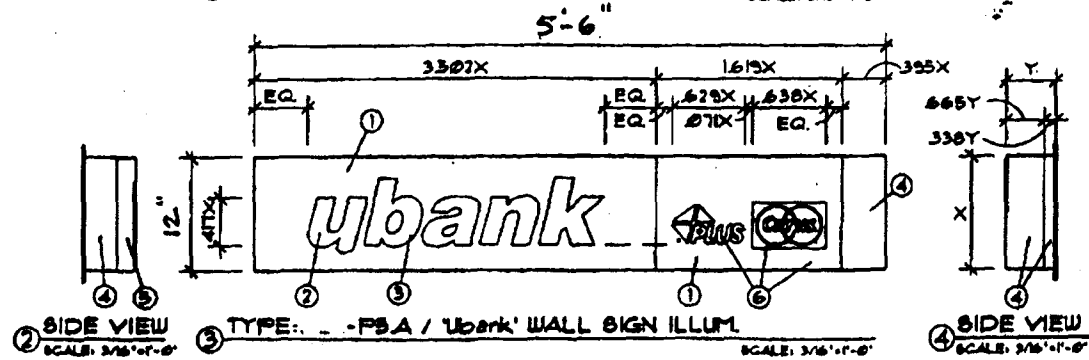
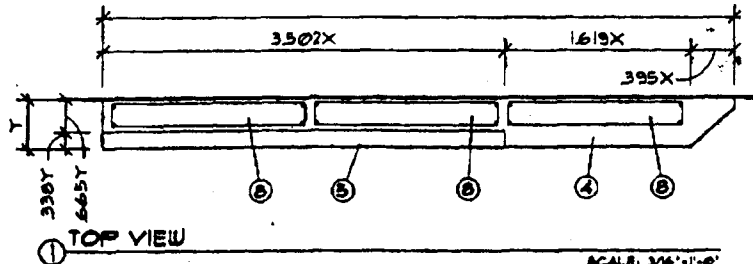

'ubank' WALL SIGN (ILLUM. FRONT FINISH) FOR USE IN: CA, CO, DC, KS, MN, NY, OR, UT, WA, AND WY

SIGN TYPE	X OVERALL HT.	Y ILLUM BROW	Z DEPTH
PSA	12'	5'-6 1/4"	8"
PSA	8'-6"	5'-6 1/4"	8"
PSA	8'-6"	5'-6 1/4"	8"
PSA	12'	5'-6 1/4"	8"

**Gordon Sign Company**  
 2830 West 8th Avenue  
 Denver, Colorado 80204  
 929-6121 FAX: 929-1024  
 E-Mail: GordonSign@aol.com