



SIGN PERMIT

Community Development Department
 250 North 5th Street
 Grand Junction, CO 81501
 (970) 244-1430

Permit No. _____
 Date Submitted 11/13/98
 FEE \$ 25⁰⁰
 Tax Schedule 2705-311-00-128
 Zone PAD

BUSINESS NAME Grand Jet Aircraft Sales
 STREET ADDRESS 782 Heritage Way
 PROPERTY OWNER Colorado Skunkworks
 OWNER ADDRESS 2317 Interstat Ave
Grand Jet, 81505-8620

CONTRACTOR Western Sign Co
 LICENSE NO. 298 0446
 ADDRESS 3183 Hill Ave
 TELEPHONE NO. 523 61045

1. FLUSH WALL 2 Square Feet per Linear Foot of Building Facade
Face Change Only (2,3 & 4):
 2. ROOF 2 Square Feet per Linear Foot of Building Facade
 3. FREE-STANDING 2 Traffic Lanes - 0.75 Square Feet x Street Frontage
 4 or more Traffic Lanes - 1.5 Square Feet x Street Frontage
 4. PROJECTING 0.5 Square Feet per each Linear Foot of Building Facade

Existing Externally or Internally Illuminated - No Change in Electrical Service Non-Illuminated

- (1 - 4) Area of Proposed Sign 112.6 Square Feet
 (1,2,4) Building Facade 60.30 Linear Feet
 (1 - 4) Street Frontage 128.34 Linear Feet
 (2,4) Height to Top of Sign 18 Feet Clearance to Grade 14'3" Feet

Existing Signage/Type:	Sq. Ft.
	Sq. Ft.
	Sq. Ft.
	Sq. Ft.
Total Existing:	Sq. Ft.

● FOR OFFICE USE ONLY ●	
Signage Allowed on Parcel:	
Building	<u>120.60</u> Sq. Ft.
Free-Standing	Sq. Ft.
Total Allowed:	<u>120.60</u> Sq. Ft.

COMMENTS: _____

NOTE: No sign may exceed 300 square feet. A separate sign permit is required for each sign. Attach a sketch of proposed and existing signage including types, dimensions, lettering, abutting streets, alleys, easements, property lines, and locations.

[Signature]
 Applicant's Signature

1/22/98
 Date

[Signature]
 Community Development Approval

11/13/98
 Date

(White: Community Development)

(Canary: Applicant)

(Pink: Code Enforcement)

STAKE JUNCTION WITH CITY STAKES 1650 Installed 420 650

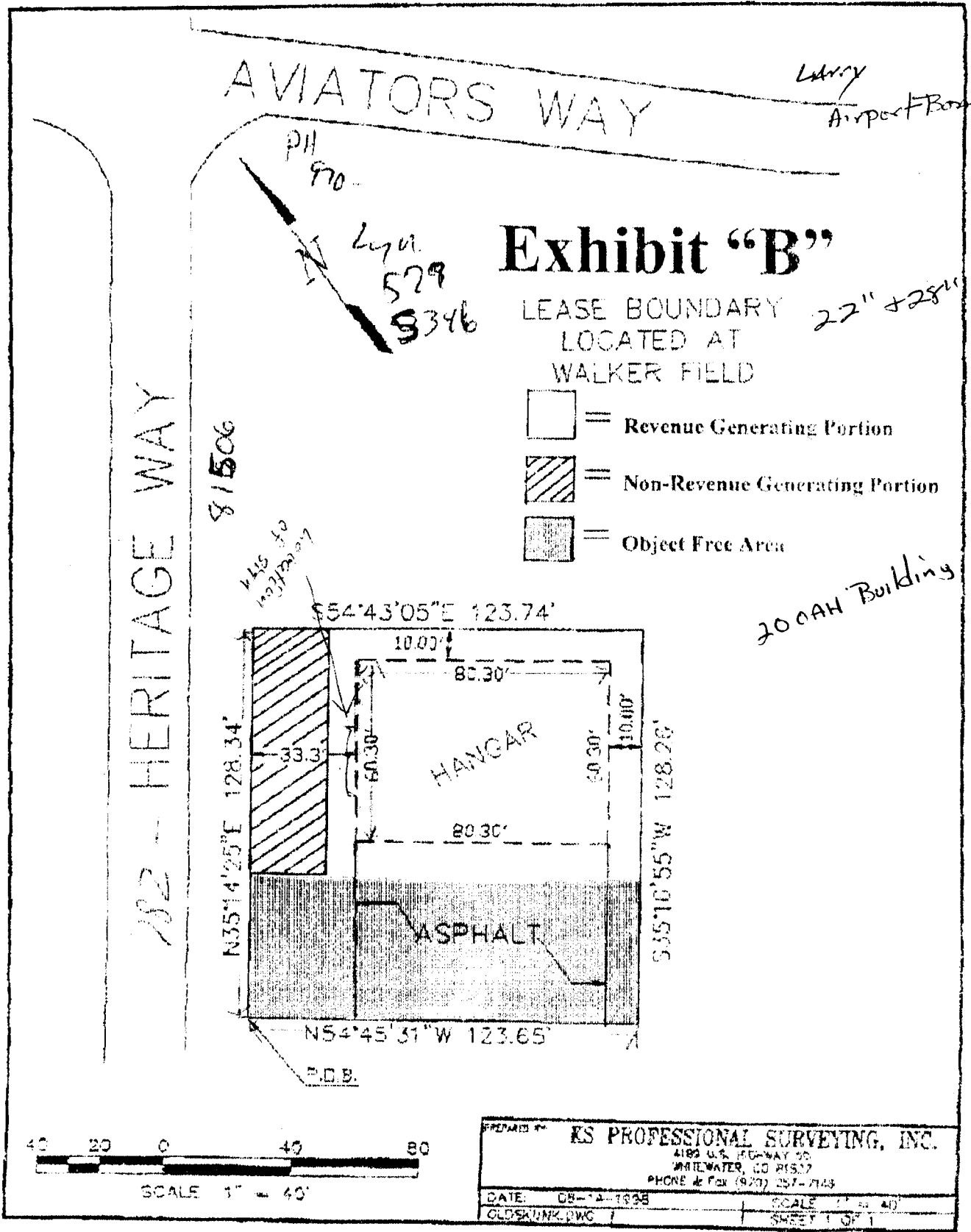

GRAND JUNCTION AIRCRAFT SALES

TOP LINE: TIMES BOLD EXTENDED, LARGE & SMALL CAPS - 15" & 12" - 27.8 SQ. FT.
BOTTOM LINE: TIMES BOLD, ALL UPPER CASE - 30" - 84.8 SQ. FT.
112.6 SQ. FT. TOTAL

FORMED PLASTIC LETTERS INSTALLED ONTO BUILDING



ELECTRIC SIGN *Specialists*

Office: (970) 523-4045 Fax: (970) 523-4046
3183 Hall Ave., Grand Junction, CO 81504

ALL RIGHTS RESERVED
No part of this design and layout may be reproduced or utilized in any form
or by any means without permission in writing from Western Neon Sign Co., Inc.

