



SIGN CLEARANCE

Community Development Department
250 North 5th Street
Grand Junction, CO 81501
(970) 244-1430

Clearance No. 05608
Date Submitted 6-10-98
FEES \$ 25⁰⁰
Tax Schedule 2945-103-34-002
Zone C-2

BUSINESS NAME Tan Lines, Inc CONTRACTOR Canvas Products Co
STREET ADDRESS 633 Bogart Lane (unit B) LICENSE NO. 2980,81
PROPERTY OWNER Jack Bogart ADDRESS 580 25 Road
OWNER ADDRESS 527 Bogart Lane TELEPHONE NO. 242-1453

- 1. FLUSH WALL 2 Square Feet per Linear Foot of Building Facade
- 2. ROOF 2 Square Feet per Linear Foot of Building Facade
- 3. FREE-STANDING 2 Traffic Lanes - 0.75 Square Feet x Street Frontage
4 or more Traffic Lanes - 1.5 Square Feet x Street Frontage
- 4. PROJECTING 0.5 Square Feet per each Linear Foot of Building Facade
- 5. OFF-PREMISE See #3 Spacing Requirements; Not > 300 Square Feet or < 15 Square Feet

Externally Illuminated Internally Illuminated Non-Illuminated

- (1 - 5) Area of Proposed Sign 7 Square Feet
- (1,2,4) Building Facade 240 Linear Feet 240
- (1 - 4) Street Frontage 270 Linear Feet 270
- (2,4,5) Height to Top of Sign _____ Feet Clearance to Grade _____ Feet
- (5) Distance from all Existing Off-Premise Signs within 600 Feet _____ Feet

Existing Signage/Type:	
Flash wall (Boss)	8 Sq. Ft.
Flash wall (Murphy)	10 Sq. Ft.
	Sq. Ft.
Total Existing:	18 Sq. Ft.

● FOR OFFICE USE ONLY ●		
Signage Allowed on Parcel:		
Building	480	Sq. Ft.
Free-Standing	202.5	Sq. Ft.
Total Allowed:	480	Sq. Ft.

COMMENTS:

NOTE: No sign may exceed 300 square feet. A separate sign clearance is required for each sign. Attach a sketch of proposed and existing signage including types, dimensions, lettering, abutting streets, alleys, easements, property lines, and locations. **A SEPARATE PERMIT FROM THE BUILDING DEPARTMENT IS REQUIRED.**

[Signature] 6-10-98 [Signature] 6/10/98
Applicant's Signature Date Community Development Approval Date

(White: Community Development) (Canary: Applicant) (Pink: Building Dept) (Goldenrod: Code Enforcement)

CANVAS Products Co
58025 Road
2-1453
Tom Dykstra

Site Plan

TAN Lines, Inc
533 Bogart Lane
Unit B
295-7000
Tracy Williams

North ↑

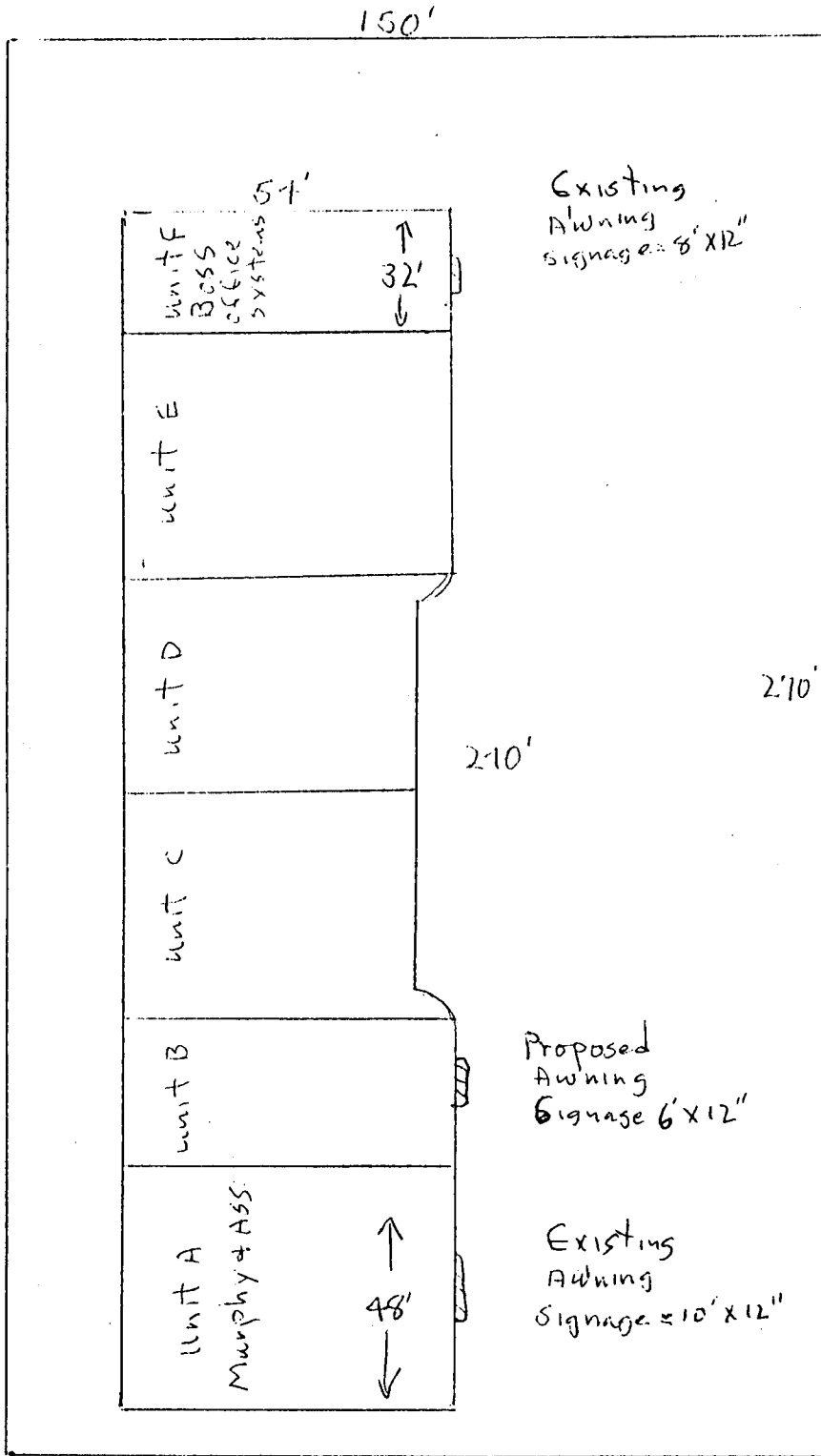

Bogart Lane

PURCHASE ORDER NO. _____ DATE: 6-10-98

NAME: Tan Lines, Inc PHONE: _____

ADDRESS: 533 Bogart Lane (unit B) QUOTE (if any) _____

PROMISED BY: _____

INSTRUCTIONS: Cooley Burgundy w/eggcrate

steel stitch

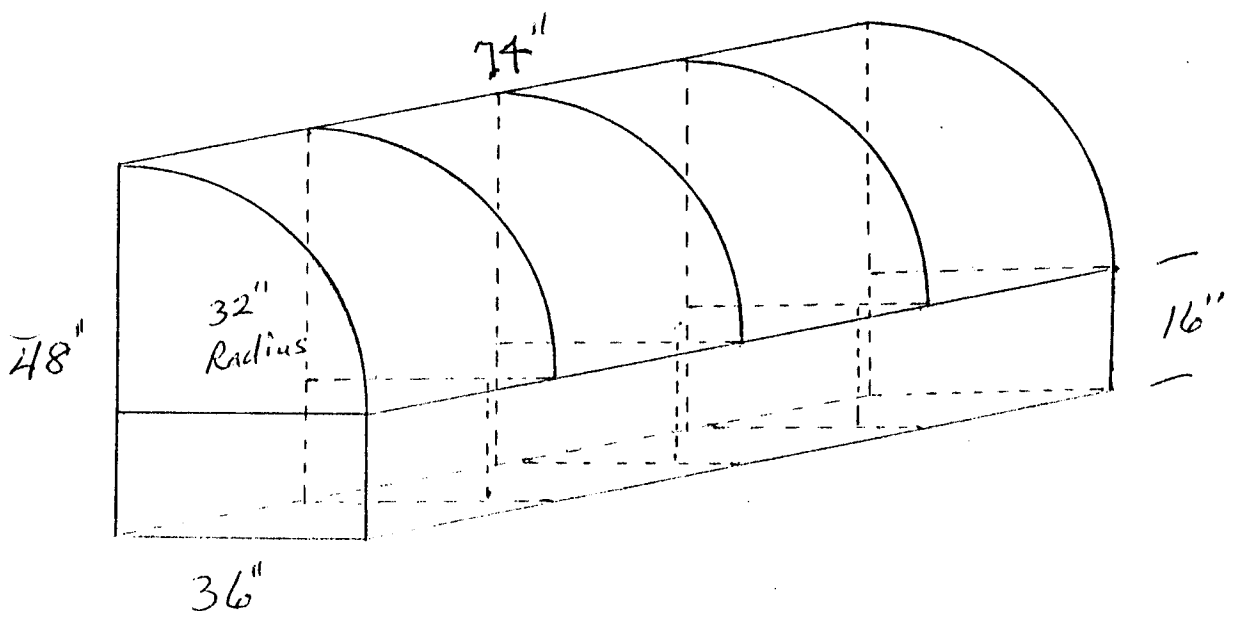

Operator _____
Material & Hardware Used _____

Notified _____
Inv. No. _____

Total Time _____
Total Material _____
City Tax _____
County Tax _____
State Tax _____