



# SIGN PERMIT

Community Development Department  
 250 North 5th Street  
 Grand Junction, CO 81501  
 (970) 244-1430

Permit No. \_\_\_\_\_  
 Date Submitted 7-14-98  
 FEE \$ 25.00  
 Tax Schedule 2945. 141. 18-009  
 Zone B-3

BUSINESS NAME HOBBY HUT MODELS CONTRACTOR BUD'S SIGNS  
 STREET ADDRESS 811 N. 12th LICENSE NO. 2980109  
 PROPERTY OWNER SAME ADDRESS 1055 UTE AVE  
 OWNER ADDRESS SAME TELEPHONE NO. 245-7700

1. FLUSH WALL 2 Square Feet per Linear Foot of Building Facade  
**Face Change Only (2,3 & 4):**  
 2. ROOF 2 Square Feet per Linear Foot of Building Facade  
 3. FREE-STANDING 2 Traffic Lanes - 0.75 Square Feet x Street Frontage  
 4 or more Traffic Lanes - 1.5 Square Feet x Street Frontage  
 4. PROJECTING 0.5 Square Feet per each Linear Foot of Building Facade

Existing Externally or Internally Illuminated - No Change in Electrical Service  Non-Illuminated

(1 - 4) Area of Proposed Sign 168 Square Feet  
 (1,2,4) Building Facade 50 Linear Feet  
 (1 - 4) Street Frontage 125 Linear Feet 12TH. ST.  
 (2,4) Height to Top of Sign 12 Feet Clearance to Grade 5 Feet

Existing Signage/Type:	
<u>0</u> ON 12th ST.	Sq. Ft.
	Sq. Ft.
	Sq. Ft.
Total Existing:	<u>0</u> Sq. Ft.

● FOR OFFICE USE ONLY ●		
Signage Allowed on Parcel:	<u>12th St</u>	
Building	<u>100</u>	Sq. Ft.
Free-Standing	<u>187.5</u>	Sq. Ft.
Total Allowed:	<u>187.5</u>	Sq. Ft.

COMMENTS: THIS IS A FACE CHANGE ONLY  
SIGN IS EXISTING NOW...

NOTE: No sign may exceed 300 square feet. A separate sign permit is required for each sign. Attach a sketch of proposed and existing signage including types, dimensions, lettering, abutting streets, alleys, easements, property lines, and locations.

[Signature] Date \_\_\_\_\_ Community Development Approval [Signature] Date 7/14/98

(White: Community Development) (Canary: Applicant) (Pink: Code Enforcement)

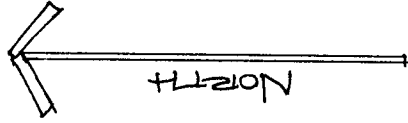

← N. 12th →

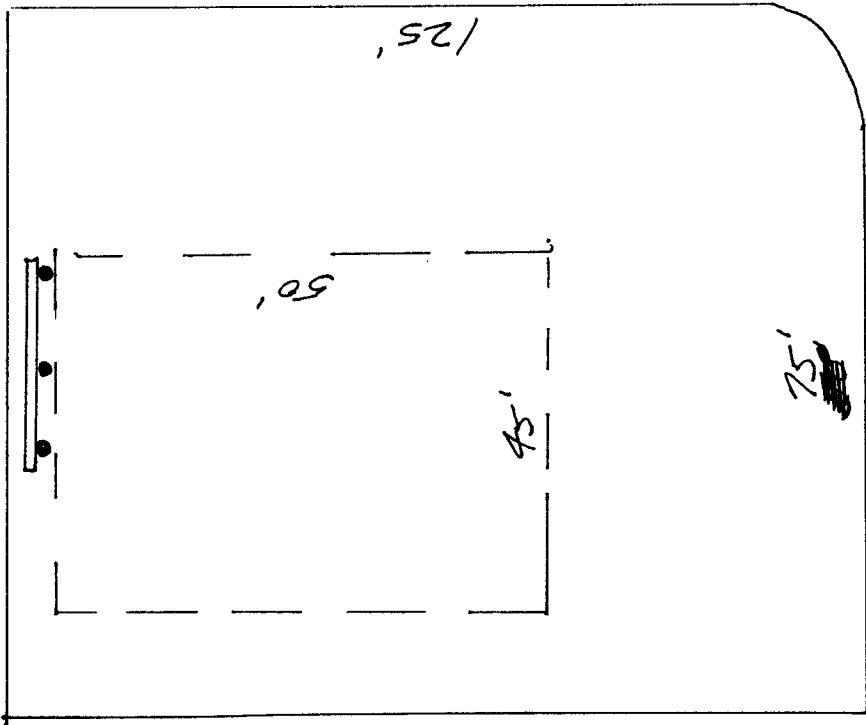

Hill Ave.

168 ft  
FACE CHANGE  
HERE

# HOBBY HUT

*Models*

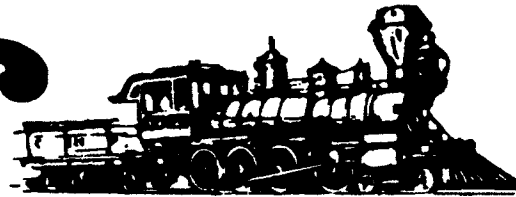
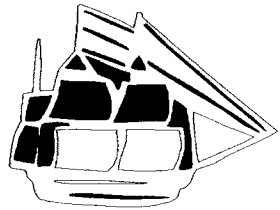

7' x 24'