



SIGN PERMIT

Community Development Department
 250 North 5th Street
 Grand Junction, CO 81501
 (970) 244-1430

Permit No. _____
 Date Submitted 4-21-98
 FEE \$ 25⁰⁰
 Tax Schedule 2945-123-00-089
 Zone C-1

BUSINESS NAME Mc DONALDS
 STREET ADDRESS 1212 NORTH AVE.
 PROPERTY OWNER KING ENTERPRISES
 OWNER ADDRESS SAME

CONTRACTOR YOUNG ELECTRIC SIGN CO.
 LICENSE NO. 2970755
 ADDRESS 2393 F 1/2 RD.
 TELEPHONE NO. 242-7880 JOHN

1. FLUSH WALL 2 Square Feet per Linear Foot of Building Facade
Face Change Only (2,3 & 4):
 2. ROOF 2 Square Feet per Linear Foot of Building Facade
 3. FREE-STANDING 2 Traffic Lanes - 0.75 Square Feet x Street Frontage
 4 or more Traffic Lanes - 1.5 Square Feet x Street Frontage
 4. PROJECTING 0.5 Square Feet per each Linear Foot of Building Facade

Existing Externally or Internally Illuminated - No Change in Electrical Service Non-Illuminated

- (1 - 4) Area of Proposed Sign 174 Square Feet
 (1,2,4) Building Facade 53' Linear Feet
 (1 - 4) Street Frontage 160' Linear Feet
 (2,4) Height to Top of Sign ~~30'~~ Feet Clearance to Grade 10.5 Feet

Existing Signage/Type:	
(A) Channel letters	+ 50 Sq. Ft.
(B) Logo	+ 10 Sq. Ft.
(C) Pole sign (TO BE REMOVED)	- 333 Sq. Ft.
Total Existing:	+ 60 Sq. Ft.

● FOR OFFICE USE ONLY ●	
Signage Allowed on Parcel: <u>NORTH AVENUE FRONTAGE</u>	
Building	106 Sq. Ft.
Free-Standing	240 Sq. Ft.
Total Allowed:	240 Sq. Ft.

COMMENTS: With new sign 234 sq ft of signage out of 240 sq ft allowed is being used.

NOTE: No sign may exceed 300 square feet. A separate sign permit is required for each sign. Attach a sketch of proposed and existing signage including types, dimensions, lettering, abutting streets, alleys, easements, property lines, and locations.

[Signature] Applicant's Signature 4/21/98 Date [Signature] Community Development Approval 4/21/98 Date

(White: Community Development) (Canary: Applicant) (Pink: Code Enforcement)

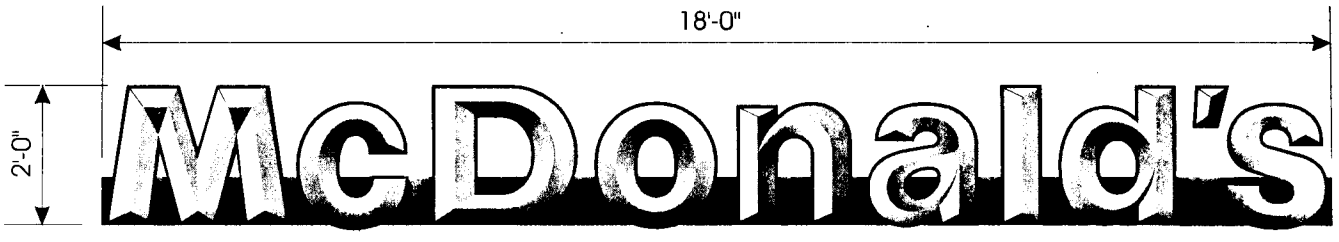

Fascia Letters

w/48" Arch

w/24" block "M"

Square Footage: 50 sq. ft..

Square Footage: 36 sq. ft..

*Illumination: Letters 15mm White Neon
Arch 15mm Clear Brite
Yellow Neon*

Illumination: Letters 15mm White Neon

Electrical: 11.6 Amps @ 120V 60Hz

Electrical: 13.6 Amps @ 120V 60Hz

*Other: Raceway Mounted Individual
Illuminated*

*Other: Raceway Mounted Individual
Illuminated
Prismatic Copy and Arch*

Prismatic Copy and Arch

A



YOUNG
ELECTRIC
SIGN
COMPANY
2001-2004-384

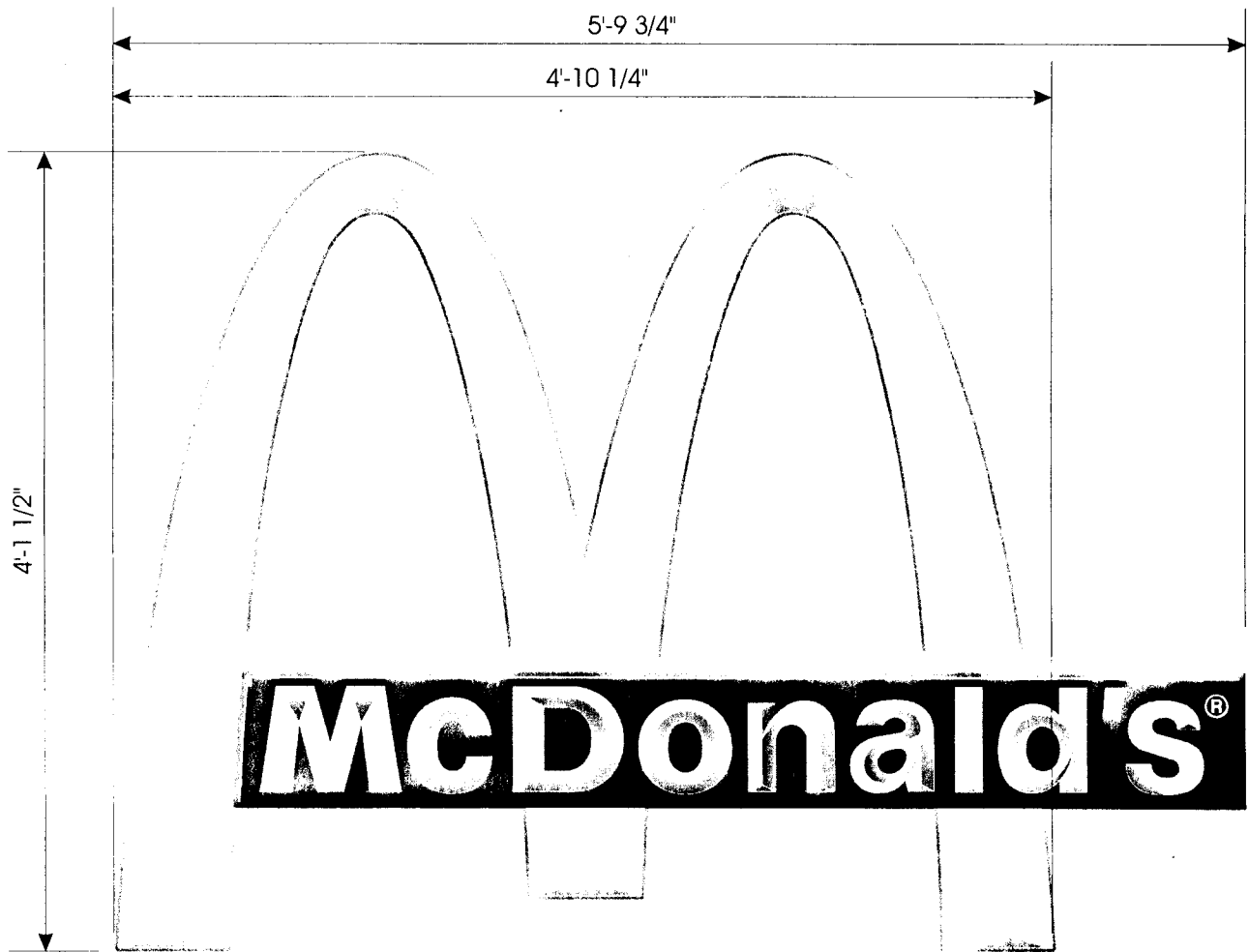

WALL LOGO

Square Footage: 10 sq.ft.

Illumination: Non-Illuminated

Other: Prismatic Copy and Arch

3

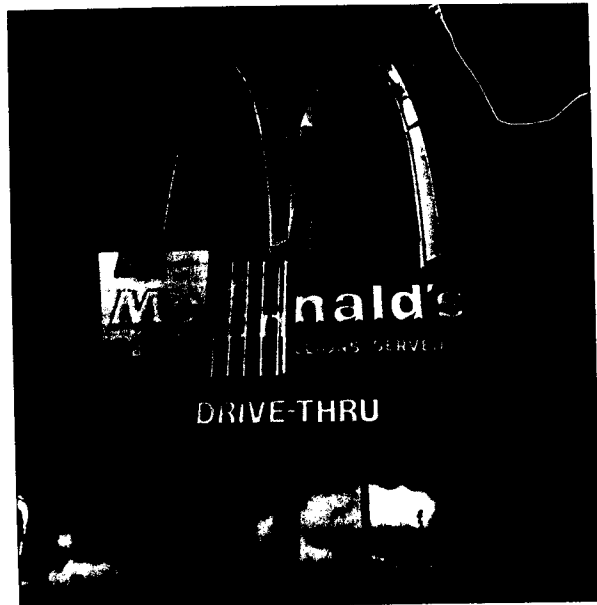

①



YOUNG
ELECTRIC
SIGN
COMPANY

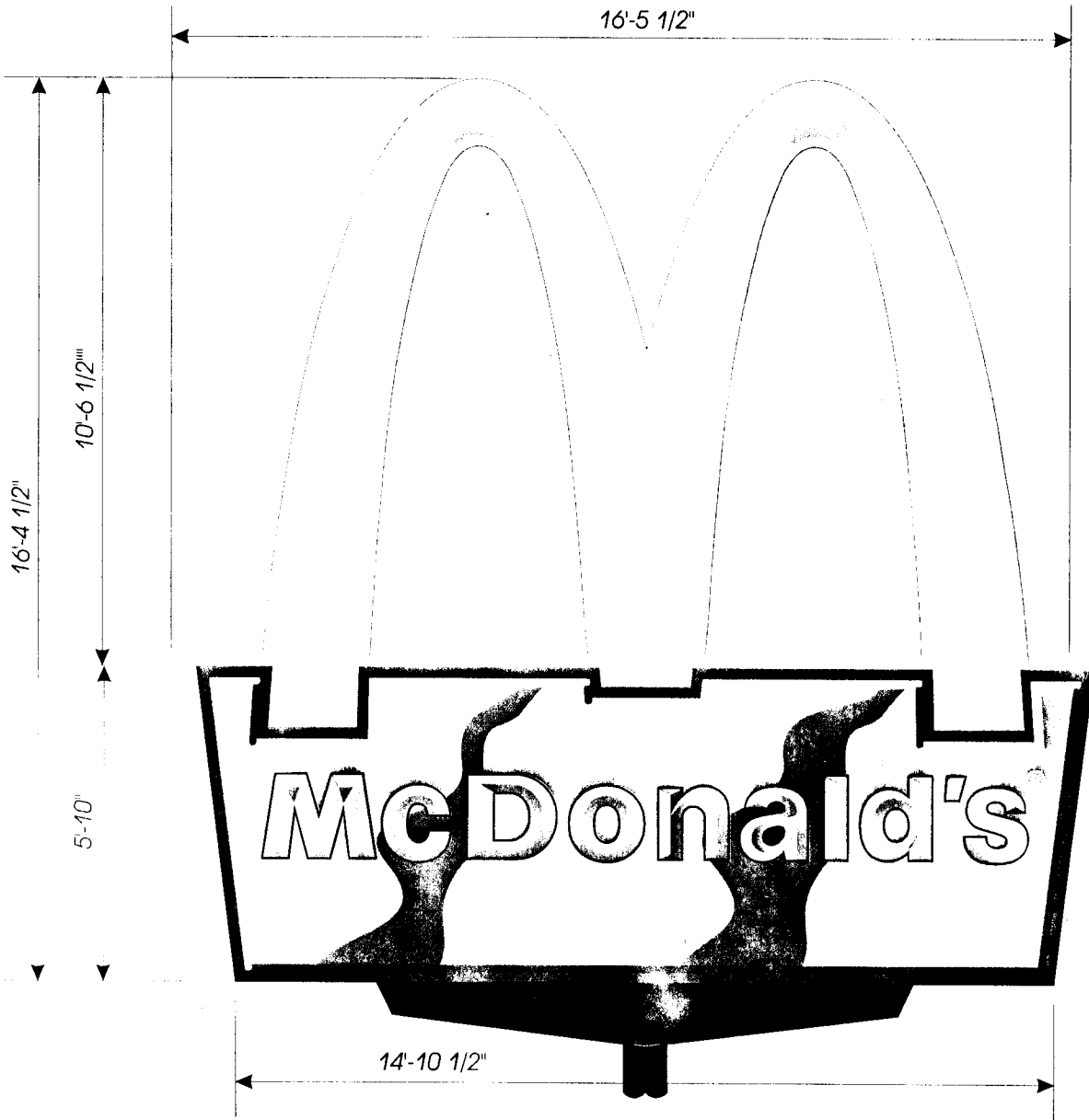

70-150 ROAD SIGN

Square Footage: 150 sq.ft.

Illumination: 2-F24 T12 CW/HO
4-F60 T12 CW/HO
10-F72 T12 CW/HO
4-F120 T12 CW/HO

3 PC.

Electrical: 15.8 Amps @ 120V 60Hz

Other: Double Face Internally Illuminated
Prismatic Copy and Arches
Engineered for 90 MPH Wind Load
Recommended Max. Height 56' OAH
Optional Prismatic Restaurant Copy

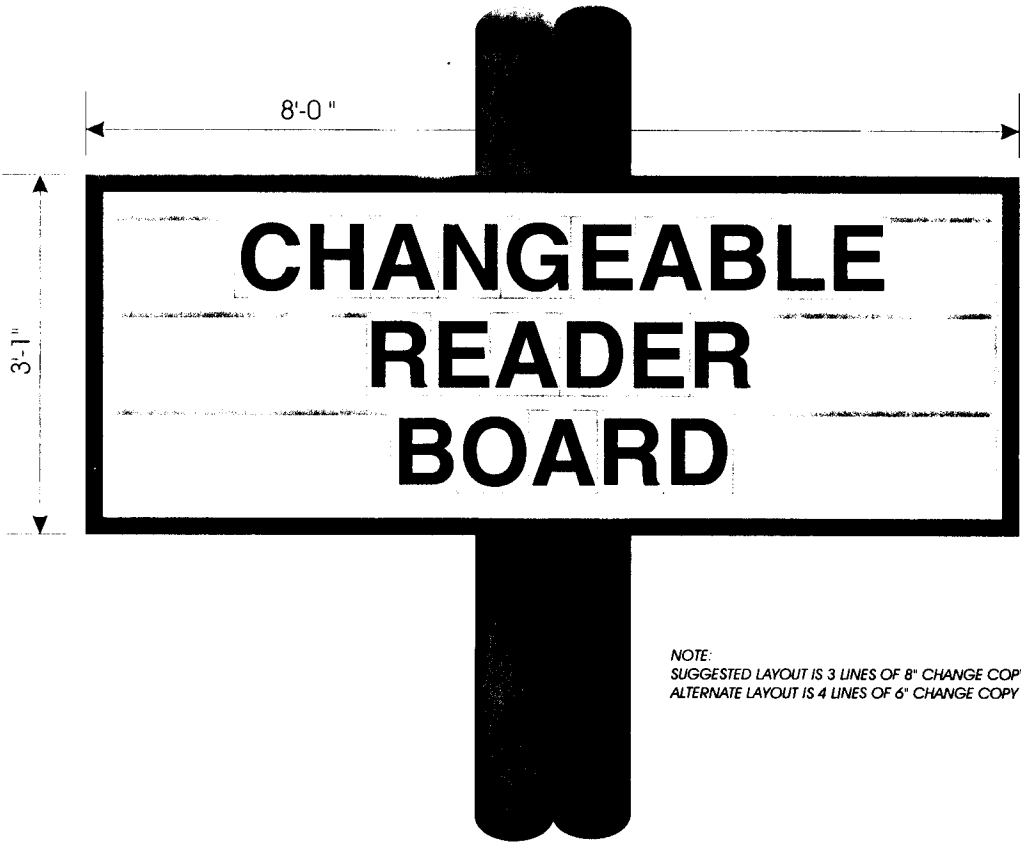

NOTE:
SUGGESTED LAYOUT IS 3 LINES OF 8" CHANGE COPY
ALTERNATE LAYOUT IS 4 LINES OF 6" CHANGE COPY

CHANGEABLE READER BOARD

Square Footage: 24 sq.ft.

Illumination: 3-F96 T12 CW/HO

Electrical: 3 Amps @ 120V 60Hz

Other: Single Face Internally Illuminated
Pan-Formed Face

NORTH →

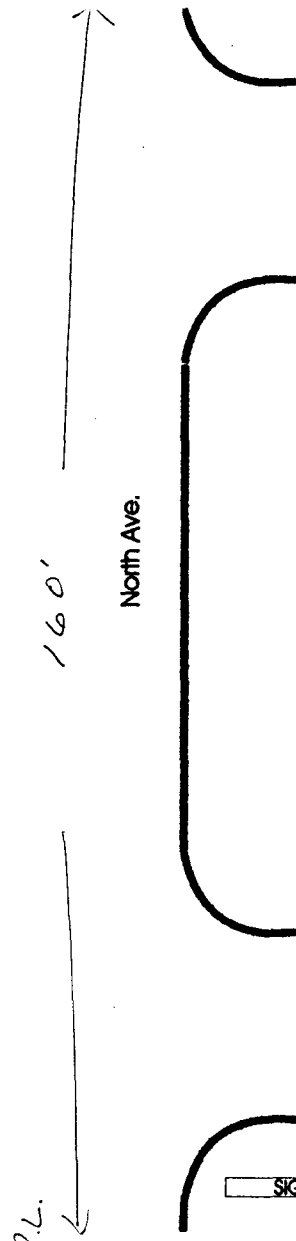

Ⓐ
existing illuminated sign
2' x 18' channel letters

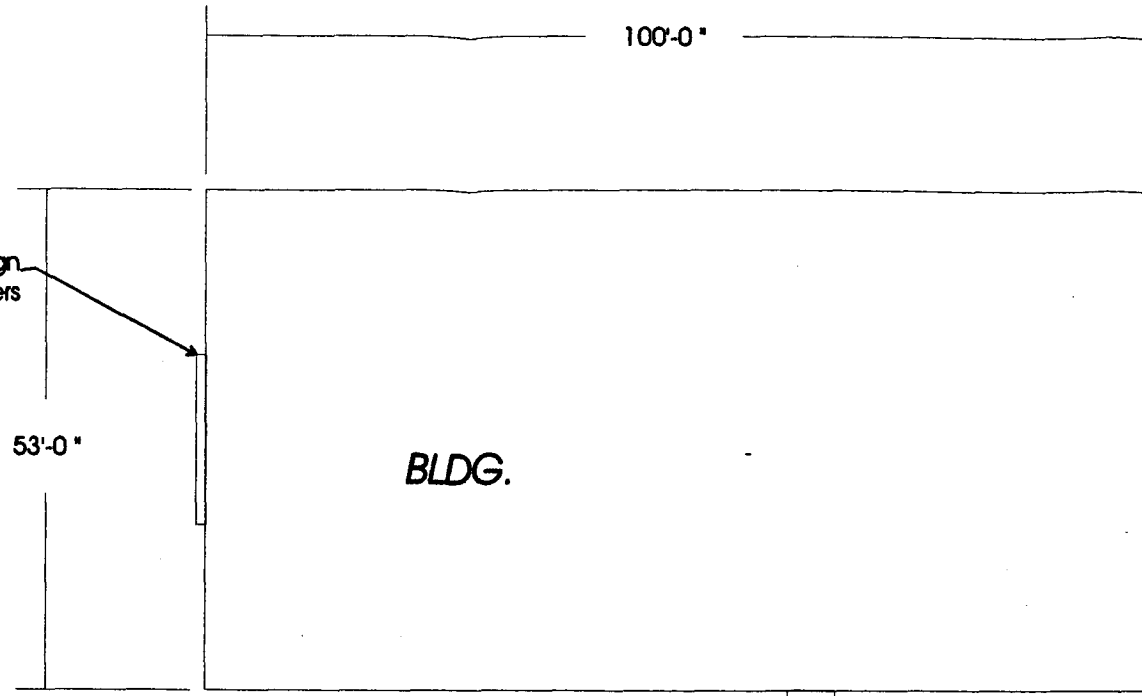

Ⓑ
existing non-illuminated wall sign 4' x 5'

Existing sign 18' x 18' x 30' tall to be removed.
+ 1.5' x 6' Drive-Thru
New sign 16.5' x 16.5' with reader board 3' x 8' to be installed on existing pole. 24' height.

Site Plan 1/16" = 1'

COLORADO CONTRACTOR LICENSE NO. 12016

	PROD. APPROVAL	DATE		SHEET NO.	SCALE	DATE	BY	FIRM NAME/LOCATION ADDRESS	FILE DESIGN NUMBER
	CLIENT					4.22.98	J.H.	McDonald's	
	SALES							1212 North Ave.	
	DESIGN							Grand Junction, CO	
	ESTIMATING								
	ENGINEERING								
EXPEDITING									
								SALES/PERSON John Heemstra	NOTE: COST FOR PROVIDING NECESSARY ELECTRICAL WIRING TO SIGN AREA IS NOT INCLUDED IN SIGN PROPOSAL.

© THIS DRAWING WAS CREATED TO ASSIST YOU IN VISUALIZING OUR PROPOSAL. THE ORIGINAL IDEAS HEREIN ARE THE PROPERTY OF YOUNG ELECTRIC SIGN COMPANY. PERMISSION TO COPY OR REUSE THIS DRAWING CAN ONLY BE OBTAINED THRU A WRITTEN AGREEMENT WITH YESCO. SEE YOUR SALES REPRESENTATIVE OR CALL THE NEAREST OFFICE OF YOUNG ELECTRIC SIGN COMPANY.

5'x20 Lexan
1'x20 black vinyl blackout Top & Bottom
3'x18' Showing - Internally Illuminated single faced sign



MAIN ID SIGN

WINDOW OR DOOR LETTERING



THIS ARTWORK WAS PREPARED BY AND IS THE PROPERTY OF PLATINUM SIGN CO. ANY UNAUTHORIZED USE OF SAME, IN WHOLE OR PART IS PROHIBITED.