



SIGN PERMIT

Community Development Department
 250 North 5th Street
 Grand Junction, CO 81501
 (970) 244-1430

Permit No. _____
 Date Submitted _____
 FEE \$ 2500
 Tax Schedule B-1 Zone
 Zone 2945-113-17-001

BUSINESS NAME Baird B. Brown, PC
 STREET ADDRESS 1250 E. Sherwood Dr.
 PROPERTY OWNER Baird B. Brown
 OWNER ADDRESS 1250 E. Sherwood

CONTRACTOR The Sign Source, Inc.
 LICENSE NO. 2980721
 ADDRESS 737 N. 12th St
 TELEPHONE NO. 257-1000

- 1. FLUSH WALL 2 Square Feet per Linear Foot of Building Facade
- Face Change Only (2,3 & 4):
- 2. ROOF 2 Square Feet per Linear Foot of Building Facade
- 3. FREE-STANDING 2 Traffic Lanes - 0.75 Square Feet x Street Frontage
4 or more Traffic Lanes - 1.5 Square Feet x Street Frontage
- 4. PROJECTING 0.5 Square Feet per each Linear Foot of Building Facade

Existing Externally or Internally Illuminated - No Change in Electrical Service Non-Illuminated

(1 - 4) Area of Proposed Sign 5.25 Square Feet
 (1,2,4) Building Facade 97.5 Linear Feet
 (1 - 4) Street Frontage 125 Linear Feet
 (2,4) Height to Top of Sign _____ Feet Clearance to Grade _____ Feet

Existing Signage/Type:	
	Sq. Ft.
	Sq. Ft.
	Sq. Ft.
Total Existing:	<u>None</u> Sq. Ft.

● FOR OFFICE USE ONLY ●		
Signage Allowed on Parcel:		
Building	<u>195</u>	Sq. Ft.
Free-Standing	<u>94</u>	Sq. Ft.
Total Allowed:	<u>195</u>	Sq. Ft.

COMMENTS: _____

NOTE: No sign may exceed 300 square feet. A separate sign permit is required for each sign. Attach a sketch of proposed and existing signage including types, dimensions, lettering, abutting streets, alleys, easements, property lines, and locations.

Terry Martin 4/13/98 Bill Nith 4-6-97
 Applicant's Signature Date Community Development Approval Date
 (White: Community Development) (Canary: Applicant) (Pink: Code Enforcement)

THE SIGN SOURCE, INC.
737 N. 12TH STREET
GRAND JUNCTION, CO
81501-3219

Final

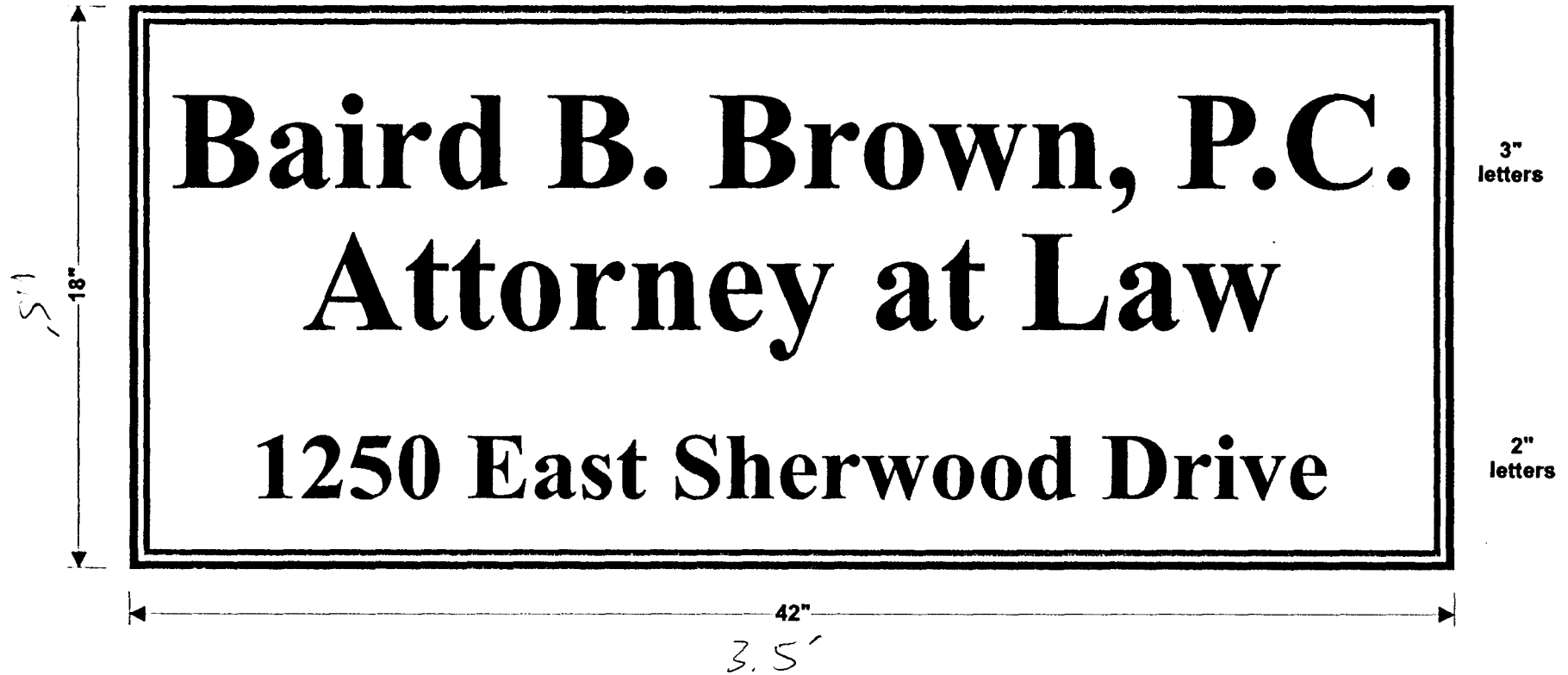

Borders are
 $\frac{1}{4}$ " on outside
 $\frac{3}{16}$ " gap
 $\frac{3}{16}$ " inside border

Dark green background
Mounting #1
Expansion bolt with rosette.

1250 Sherwood
David B. Brown

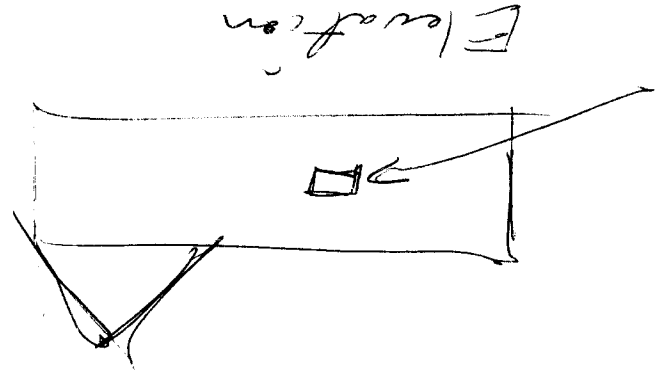
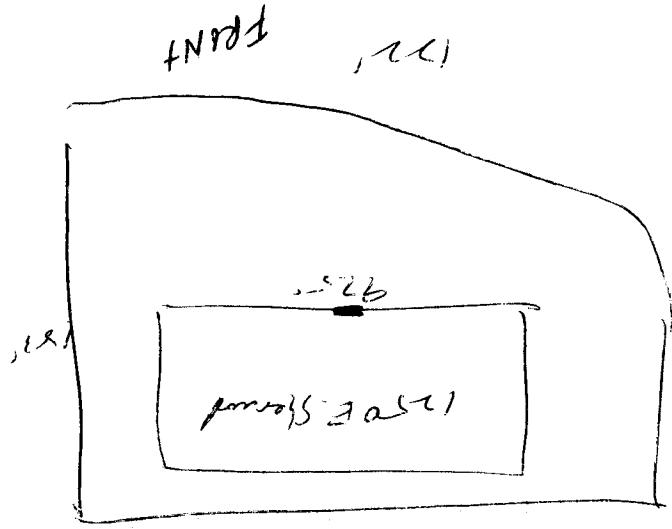

Proposed
5179