



SIGN PERMIT

Community Development Department
 250 North 5th Street
 Grand Junction, CO 81501
 (970) 244-1430

Permit No. _____
 Date Submitted 2/23/98
 FEE \$ 25⁰⁰
 Tax Schedule 2945-142-13-002
 Zone C-2

BUSINESS NAME WRW Furniture
 STREET ADDRESS 826 N. 1st Street
 PROPERTY OWNER Same
 OWNER ADDRESS Same

CONTRACTOR Bud's Signs
 LICENSE NO. 2970109
 ADDRESS 1055 UTE Ave
 TELEPHONE NO. 245-7700

1. FLUSH WALL 2 Square Feet per Linear Foot of Building Facade
- X 2. ROOF 2 Square Feet per Linear Foot of Building Facade
3. FREE-STANDING 2 Traffic Lanes - 0.75 Square Feet x Street Frontage
 4 or more Traffic Lanes - 1.5 Square Feet x Street Frontage
4. PROJECTING 0.5 Square Feet per each Linear Foot of Building Facade

Existing Externally or Internally Illuminated - No Change in Electrical Service X Non-Illuminated

- (1 - 4) Area of Proposed Sign 15.45 Square Feet
 (1,2,4) Building Facade 36 Linear Feet
 (1 - 4) Street Frontage 45 Linear Feet
 (2,4) Height to Top of Sign 12 Feet Clearance to Grade 8 Feet

Existing Signage/Type:	
48 Flushwall	48 Sq. Ft.
	Sq. Ft.
	Sq. Ft.
Total Existing:	Sq. Ft.

● FOR OFFICE USE ONLY ●		
Signage Allowed on Parcel: <u>FIRST STREET</u>		
Building	<u>72</u>	Sq. Ft.
Free-Standing	<u>67.5</u>	Sq. Ft.
Total Allowed:	<u>72</u>	Sq. Ft.

COMMENTS: Lettering on an Existing Awning

NOTE: No sign may exceed 300 square feet. A separate sign permit is required for each sign. Attach a sketch of proposed and existing signage including types, dimensions, lettering, abutting streets, alleys, easements, property lines, and locations.

Edward A. Cuneo
 Applicant's Signature

2/23/98
 Date

[Signature]
 Community Development Approval

3/2/98
 Date

(White: Community Development)

(Canary: Applicant)

(Pink: Code Enforcement)

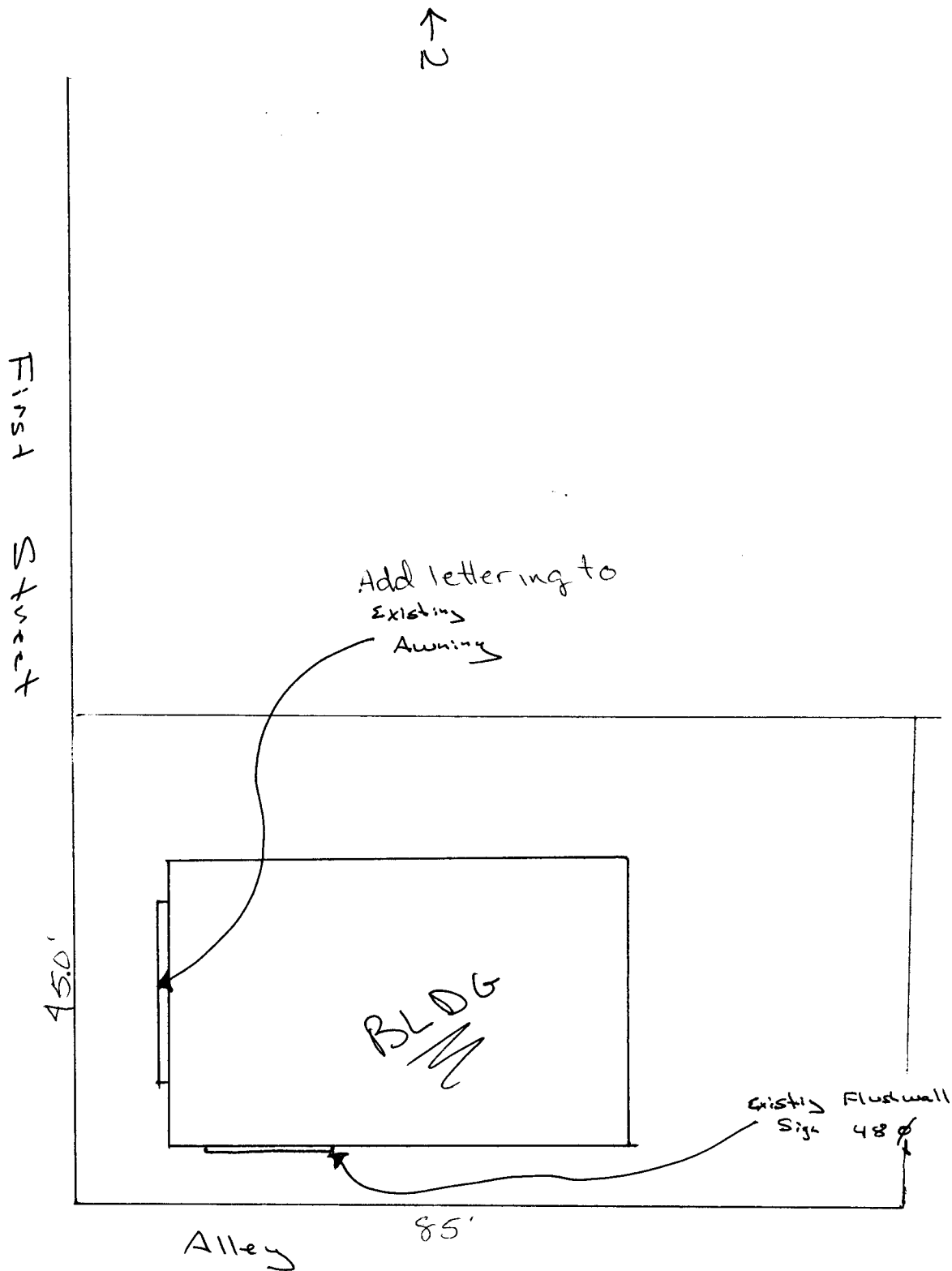

1055 Ute Avenue • Grand Junction, Colorado 81501 • 970-245-7700

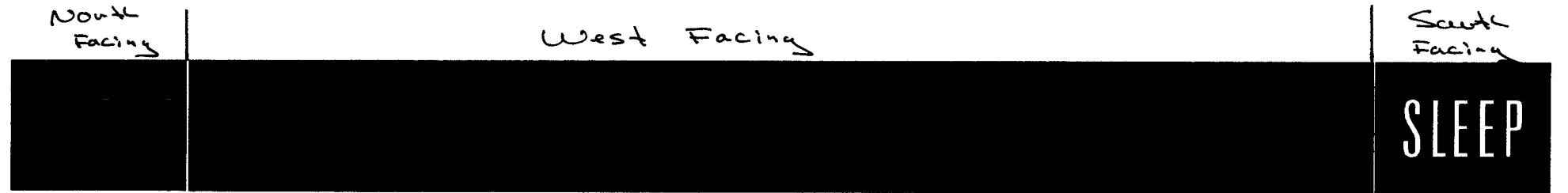

10"x28"
1.93φ

12"x145"
12φ

10"x22"
1.52φ

15.45φ total

