



SIGN PERMIT

Community Development Department
250 North 5th Street
Grand Junction, CO 81501
(970) 244-1430

Permit No. _____
Date Submitted _____
FEE \$ 25.00
Tax Schedule 2945-D91-00-083
Zone C-2

BUSINESS NAME FRUITA / GRAND SCT. BODY + PAINT CONTRACTOR ELDERADO SIGNS
STREET ADDRESS 2488 COMMERCE BLD. LICENSE NO. 2970283
PROPERTY OWNER ROBERT RAMIREZ ADDRESS 3423 FRONT ST.
OWNER ADDRESS 4183 Hwy. 50 WHITE WATER TELEPHONE NO. 245-7446

- 1. FLUSH WALL 2 Square Feet per Linear Foot of Building Facade
- Face Change Only (2,3 & 4):
- 2. ROOF 2 Square Feet per Linear Foot of Building Facade
- 3. FREE-STANDING 2 Traffic Lanes - 0.75 Square Feet x Street Frontage
4 or more Traffic Lanes - 1.5 Square Feet x Street Frontage
- 4. PROJECTING 0.5 Square Feet per each Linear Foot of Building Facade

Existing Externally or Internally Illuminated - No Change in Electrical Service Non-Illuminated

- (1 - 4) Area of Proposed Sign 40 Square Feet
- (1,2,4) Building Facade 50 Linear Feet
- (1 - 4) Street Frontage 150 Linear Feet 139
- (2,4) Height to Top of Sign 21 Feet Clearance to Grade 16 Feet

Existing Signage/Type:	
3'X10' NON/ILLUM. FLUSH MT. SIGN ON FRONT	30 Sq. Ft.
	Sq. Ft.
	Sq. Ft.
Total Existing:	30 Sq. Ft.

● FOR OFFICE USE ONLY ●	
Signage Allowed on Parcel:	Patterson
Building	100 Sq. Ft.
Free-Standing	208 Sq. Ft.
Total Allowed:	208 Sq. Ft.

COMMENTS: RE-FACE EXISTING SIGN ON BACK OF PROPERTY / FACING PATTERSON BLVD.

NOTE: No sign may exceed 300 square feet. A separate sign permit is required for each sign. Attach a sketch of proposed and existing signage including types, dimensions, lettering, abutting streets, alleys, easements, property lines, and locations.

[Signature] Applicant's Signature 1/23/98 Date Mike Pelletier Community Development Approval 1/23/98 Date

(White: Community Development) (Canary: Applicant) (Pink: Code Enforcement)

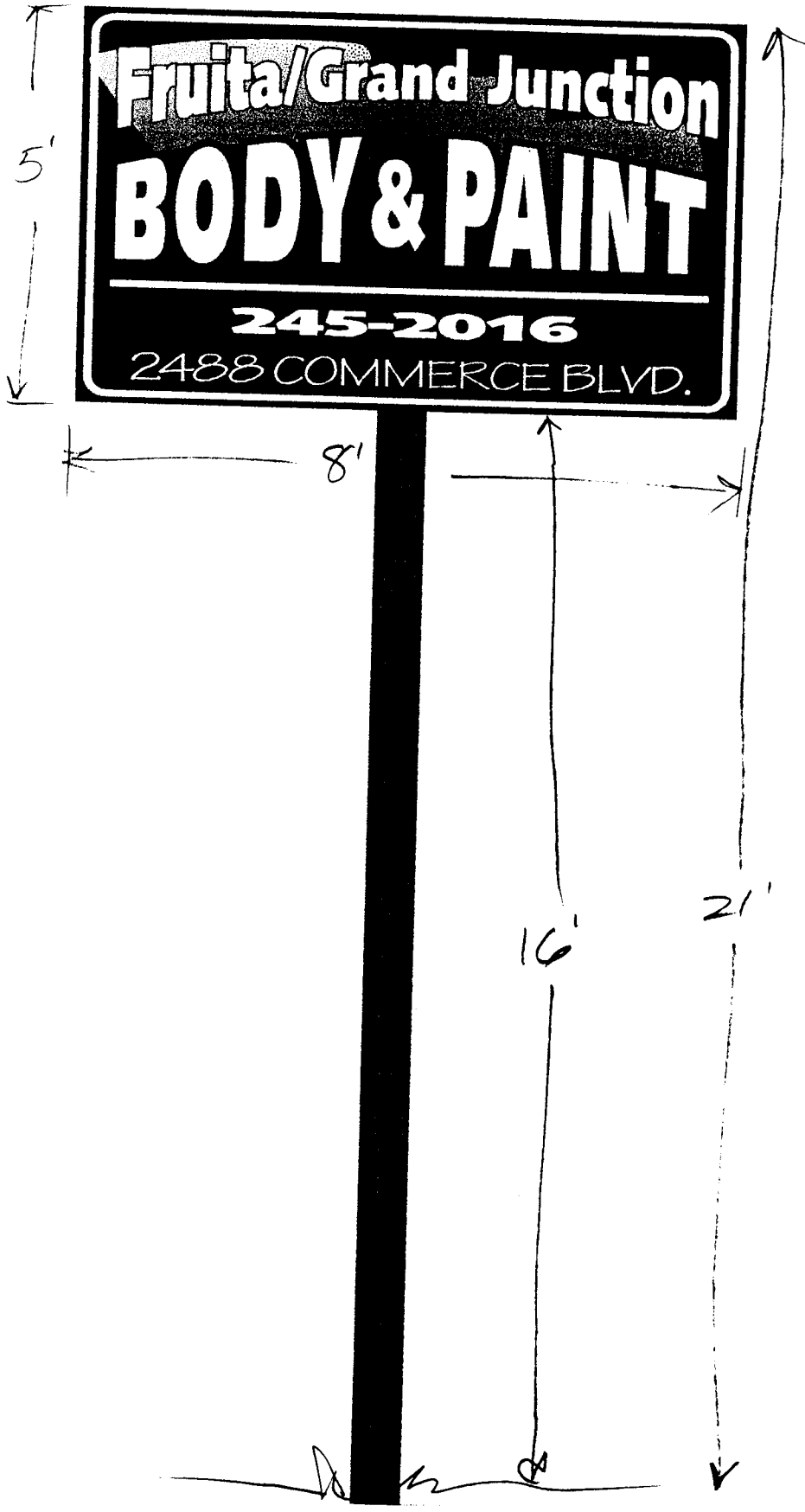

Fruita/Grand Junction

BODY & PAINT

245-2016

2488 COMMERCE BLVD.

5'

8'

16'

21'



PATTERSON BLVD.

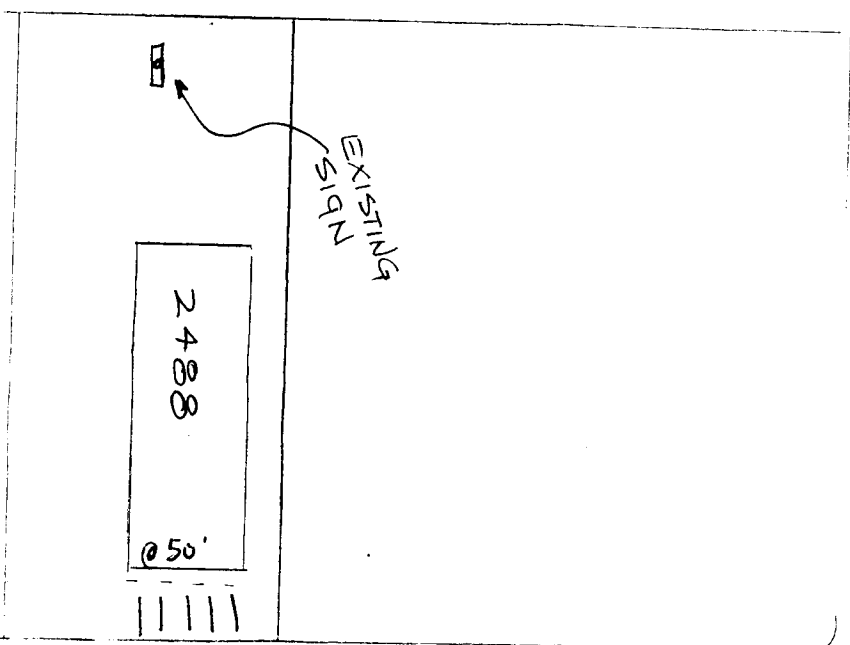

EXISTING
SIGN

2488

@ 50'

25 RD.

COMMERCE BLVD.

