

ORDINANCE NO. 1134

AN ORDINANCE DECLARING ALL PROPERTY, REAL AND PERSONAL, WITHIN THE CITY LIMITS OF THE CITY OF GRAND JUNCTION, MESA COUNTY, COLORADO, TO BE LANDS AND PROPERTY EXCLUDED FROM THE UTE WATER CONSERVANCY DISTRICT IN SAID COUNTY AND STATE:

WHEREAS, certain lands and personalty thereon, located within the limits of the City of Grand Junction, Mesa County, Colorado, are included within the Ute Water Conservancy District in said County; said lands being described as follows:

The North one-half of the Southeast Quarter and the Southwest Quarter of the Southeast Quarter Section 10, Township 1 South, Range 1 West, Ute Meridian, Mesa County, Colorado;

The Southwest Quarter of Section 7 Township 1 South, Range 1 East, Ute Meridian, Mesa County, Colorado;

Beginning at the Southeast corner of the Northeast Quarter Section 10, Township 1 South, Range 1 West, Ute Meridian, Mesa County, Colorado, thence North 89° 48' West 660 feet; thence North 200 feet thence North 29° East 159.6 feet to the center line of the Mesa County Ditch, thence South 78° 22' East along the center line of said ditch to the East line of said Section 10, thence South along said East line to the place of beginning,

and

WHEREAS, said District has not incurred bonded or other indebtedness under the election procedures set forth in Chapter Sections 149-6-34 and 149-6-37, 1953 Colorado Revised Statutes; and

WHEREAS, said District has not entered into a contract with the United States of America or any of its agencies; and

WHEREAS, no consent by the City of Grand Junction, Colorado, was obtained for the inclusion of lands of the City within the District and an express objection was made in writing to the District Court in the County of Mesa, Colorado, at the time the District was being formed, such objection being to the inclusion of lands within the District with the location and characteristics of the lands herein referred to; and

WHEREAS, it is necessary that this matter be resolved as expeditiously as possible so that the owners of the lands involved and the said District may plan on the basis of the altered relationship between them

NOW THEREFORE:

BE IT ORDAINED by the City Council of the City of Grand Junction, Colorado:

1. That all property, real and personal within the limits of the City of Grand Junction, Mesa County, Colorado, be and the same is hereby excluded from the Ute Water Conservancy District in said County and State; and, more particularly the following-described lands are so excluded; to-wit,

The North one-half of the Southeast Quarter and the Southwest Quarter of the Southeast Quarter Section 10, Township 1 South, Range 1 West, Ute Meridian, Mesa County, Colorado;

The Southwest Quarter of Section 7 Township 1 South, Range 1 East, Ute Meridian, Mesa County, Colorado;

Beginning at the Southeast corner of the Northeast Quarter Section 10, Township 1 South, Range 1 West, Ute Meridian, Mesa County, Colorado, thence North 89° 48' West 660 feet; thence North 200 feet thence North 29° East 159.6 feet to the center line of the Mesa County Ditch, thence South 78° 22' East along the center line of said ditch to the East line of said Section 10, thence South along said East line to the place of beginning,

PASSED AND ADOPTED this 19th day of July, 1961.

Charles E. McCormick

C. E. McCormick
President of the City Council

ATTEST:

Helen C. Tomlinson

City Clerk

I HEREBY CERTIFY that the foregoing ordinance, being Ordinance No. 1134, was introduced, read and ordered published by the City Council of the City of Grand Junction, Colorado, at a regular meeting of said body held on the 5th day of July, 1961, and that the same was published in The Daily Sentinel, a newspaper published and in general circulation in said City at least ten days before its final passage.

IN WITNESS WHEREOF, I have hereunto set my hand and affixed the official seal of said City, this 20th day of July, 1961.

Helen C. Tomlinson

City Clerk

First on July 8, 1961

Final July 21, 1961

ANNEXATION MAP

The Southeast Quarter Section 7 Township 1 South Range 1 East, Ute Principal Meridian, Mesa County, Colorado.
 That part of the Northeast Quarter Section 18, T1S, R1E U.P.M., lying North of U.S. Highway 6 and 24
 The Northeast Quarter Northwest Quarter Section 18, T1S, R1E U.P.M.
 The Southwest Quarter Northeast Quarter Section 7, T1S, R1E U.P.M. except that part which lies East of Indian Waste.
 That part of North Half Southeast Quarter Northeast Quarter Section 7, T1S R1E U.P.M. which lies North of the Grand Valley Canal and West of Indian Waste.
 All in Mesa County, Colorado.

ANNEXED BY COURT ORDER NO. 16298
 DECEMBER 7, 1961

Total Area to be Annexed 350 acres

Present City Limits 

Proposed City Limits 

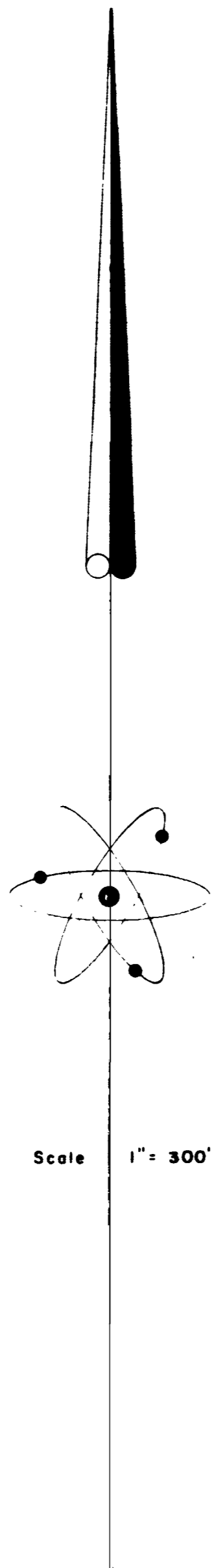

Scale 1" = 300'

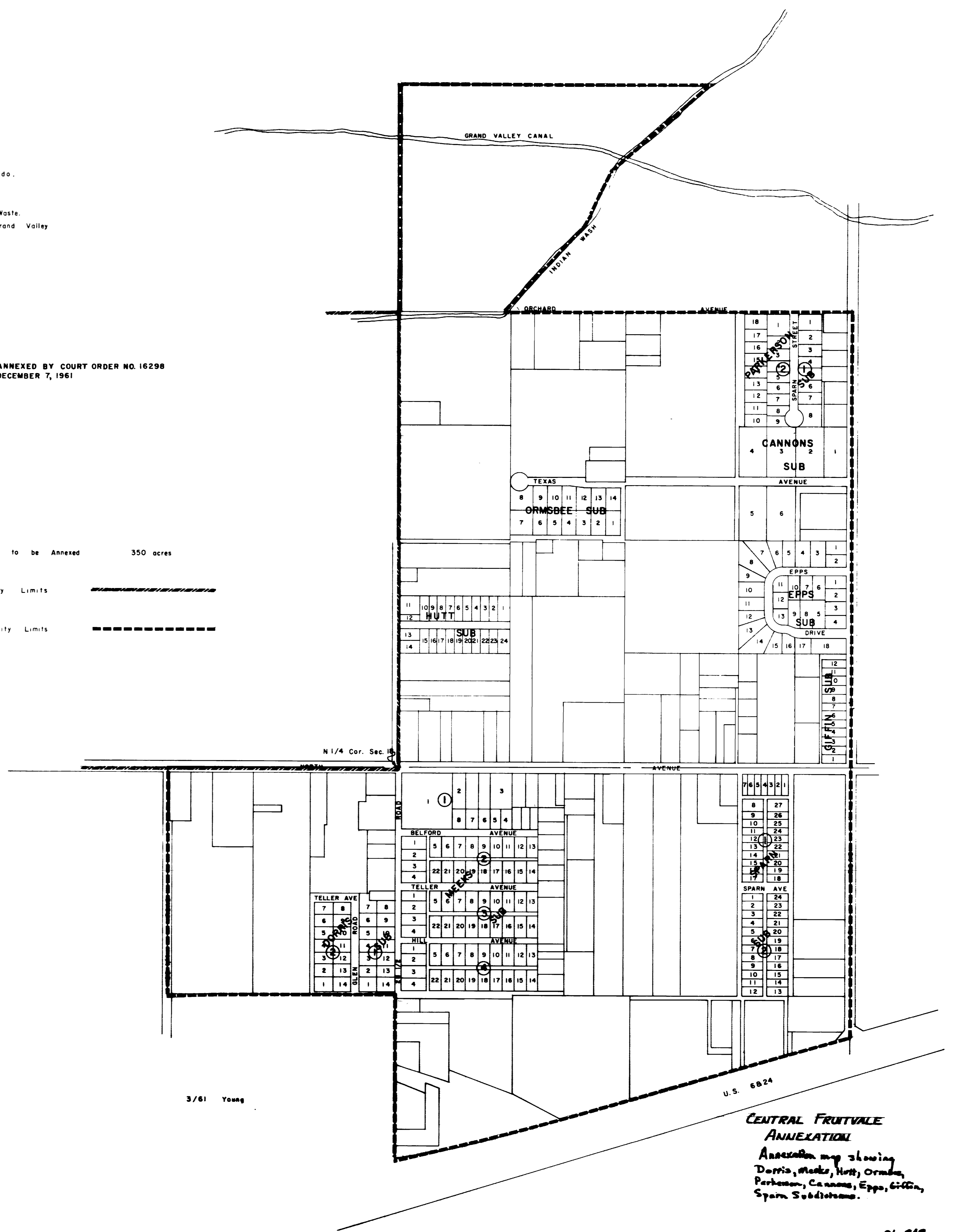

CENTRAL FRUITVALE ANNEXATION
 Assessor map showing
 Dorris, Meade, Hill, Ormsbee,
 Parkman, Cannons, Epps, Giffin,
 Sporn Subdivisions.

01-845

13005301.tif

ANNEXATION MAP

The NE 1/4 NW 1/4, Section 18 T1S R1E UM County of
 Mesa, State of Colorado.

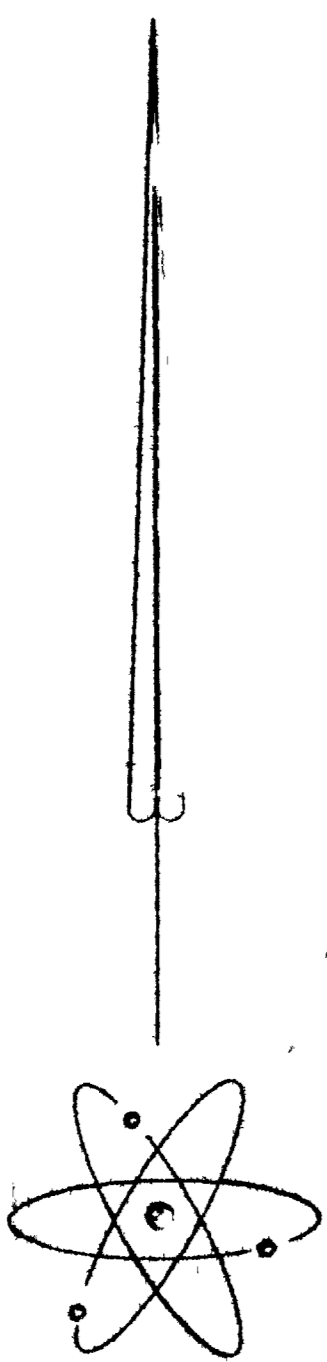

Scale 1" = 60'

Present City Limits 

Proposed City Limits 

Area to be Annexed 40 Acres



13005301.tif