



# SIGN PERMIT

Community Development Department  
 250 North 5th Street  
 Grand Junction, CO 81501  
 (970) 244-1430

Permit No. \_\_\_\_\_  
 Date Submitted 11-12-99  
 FEE \$ 25.00  
 Tax Schedule 2945-143-05-016  
 Zone B-3

BUSINESS NAME Hirons + Associates, Inc  
 STREET ADDRESS 519 Grand Ave  
 PROPERTY OWNER Jack Wisley  
 OWNER ADDRESS 519 Grand Ave Suites

CONTRACTOR Canvas Products Co  
 LICENSE NO. 2990162  
 ADDRESS 580 25 Road  
 TELEPHONE NO. 242-1953

1. FLUSH WALL 2 Square Feet per Linear Foot of Building Facade  
*Face Change Only (2,3 & 4):*  
 2. ROOF 2 Square Feet per Linear Foot of Building Facade  
 3. FREE-STANDING 2 Traffic Lanes - 0.75 Square Feet x Street Frontage  
 4 or more Traffic Lanes - 1.5 Square Feet x Street Frontage  
 4. PROJECTING 0.5 Square Feet per each Linear Foot of Building Facade

Existing Externally or Internally Illuminated - No Change in Electrical Service  Non-Illuminated

(1 - 4) Area of Proposed Sign 6 Square Feet  
 (1,2,4) Building Facade 68 Linear Feet on Grand Ave - 60 linear ft on 5th Street  
 (1 - 4) Street Frontage 100 Linear Feet  
 (2,3,4) Height to Top of Sign \_\_\_\_\_ Feet Clearance to Grade \_\_\_\_\_ Feet

Existing Signage/Type:	
Pole Sign - Grand Ave	41 Sq. Ft.
Flush wall - 5th Street	13 Sq. Ft.
	Sq. Ft.
Total Existing:	54 Sq. Ft.

● FOR OFFICE USE ONLY ●	
Signage Allowed on Parcel:	
Building	136 Sq. Ft.
Free-Standing	75 Sq. Ft.
Total Allowed:	136 Sq. Ft.

COMMENTS: New Balance on Existing Awning  
"HIRONS + ASSOCIATES" 6" Letters

NOTE: No sign may exceed 300 square feet. A separate sign permit is required for each sign. Attach a sketch of proposed and existing signage including types, dimensions, lettering, abutting streets, alleys, easements, property lines, and locations. Roof signs shall be manufactured such that no guy wires, braces or supports shall be visible.

[Signature] 11-12-99 [Signature] 11-15-99  
 Applicant's Signature Date Community Development Approval Date

(White: Community Development) (Canary: Applicant) (Pink: Code Enforcement)

Lots 5-8

W/ Steve Morgan 11/12

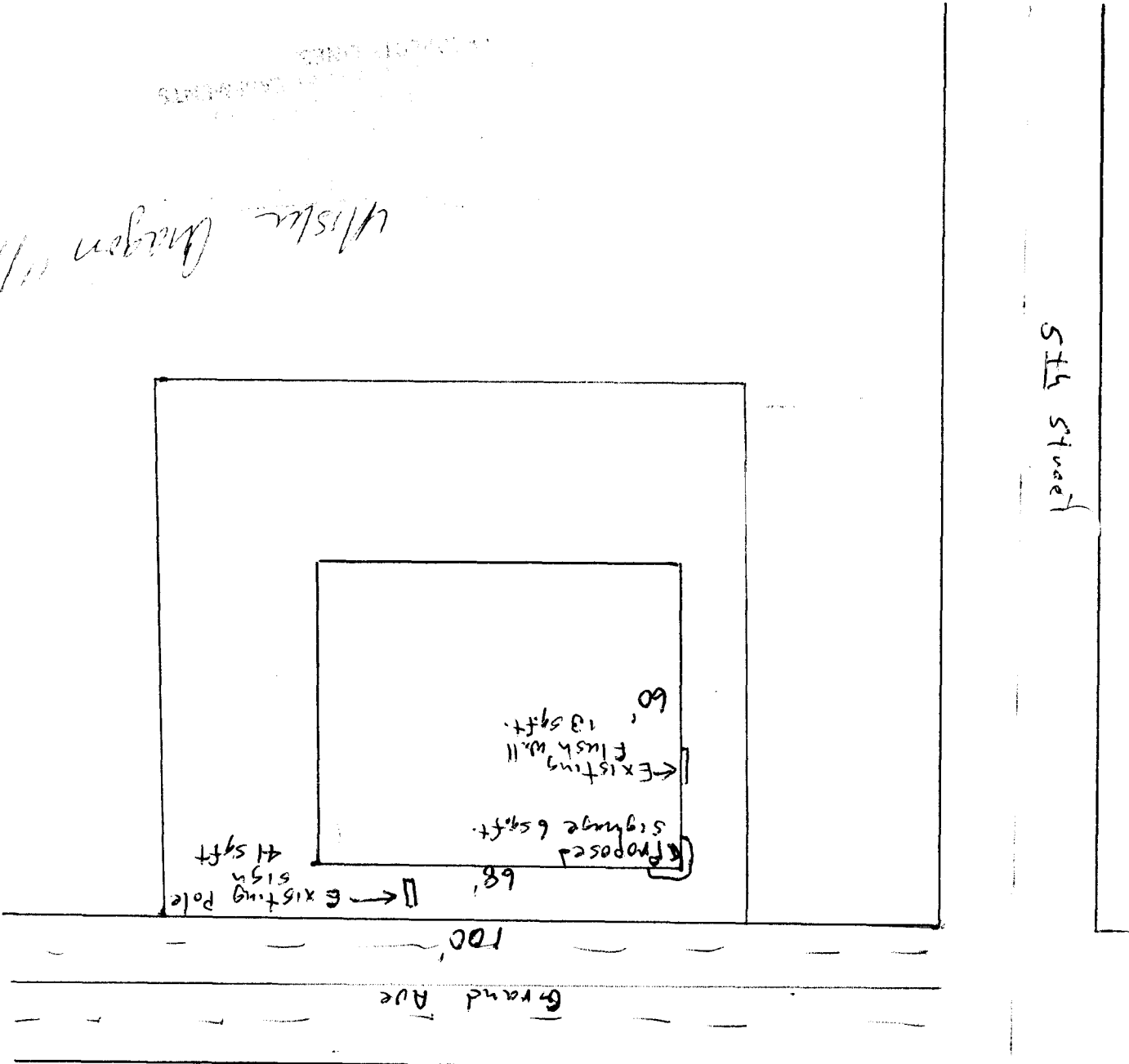

CANDAS PRODUCTS CO  
 580 25 Road  
 Tom Dykstra  
 242-1453

Site Plan

HIVENS + ASSOCIATES  
 519 Grand Ave  
 Bob Hivens  
 245-0310