



# SIGN PERMIT

2 4\*

Community Development Department  
250 North 5th Street  
Grand Junction, CO 81501  
(970) 244-1430

Permit No. \_\_\_\_\_  
Date Submitted 2/26/99  
FEE \$ 25.00  
Tax Schedule 2945-113-00-004  
Zone C-2

BUSINESS NAME Navstar Mortgage  
STREET ADDRESS 216 N. Ave  
PROPERTY OWNER Noah White  
OWNER ADDRESS n/a

CONTRACTOR Buds Signs  
LICENSE NO. 2990100  
ADDRESS 1055 UTE Ave  
TELEPHONE NO. 245-7700

- 1. FLUSH WALL 2 Square Feet per Linear Foot of Building Facade
- Face Change Only (2,3 & 4):
- 2. ROOF 2 Square Feet per Linear Foot of Building Facade
- 3. FREE-STANDING 2 Traffic Lanes - 0.75 Square Feet x Street Frontage  
4 or more Traffic Lanes - 1.5 Square Feet x Street Frontage
- 4. PROJECTING 0.5 Square Feet per each Linear Foot of Building Facade

Existing Externally or Internally Illuminated - No Change in Electrical Service  Non-Illuminated

- (1 - 4) Area of Proposed Sign 16 Square Feet
- (1,2,4) Building Facade 50 Linear Feet
- (1 - 4) Street Frontage 50 Linear Feet
- (2,4) Height to Top of Sign 10 Feet Clearance to Grade 6 Feet

Existing Signage/Type: <u>See Inventory</u>		
<u>Flushwall</u>	<u>24</u>	Sq. Ft.
<u>Roof</u>	<u>77</u>	Sq. Ft.
<u>Free-standing</u>	<u>64</u>	Sq. Ft.
Total Existing:	<u>165</u>	Sq. Ft.

● FOR OFFICE USE ONLY ●	
Signage Allowed on Parcel:	
Building	<u>ALLOWED</u> 380 Sq. Ft.
Free-Standing	<u>ALLOWED</u> 75 Sq. Ft.
Total Allowed:	380 <del>ALLOWED</del> Sq. Ft.

COMMENTS: \_\_\_\_\_

NOTE: No sign may exceed 300 square feet. A separate sign permit is required for each sign. Attach a sketch of proposed and existing signage including types, dimensions, lettering, abutting streets, alleys, easements, property lines, and locations.

Edward A. Canary 2/26/99 Mike Pelletier 2/26/99  
 Applicant's Signature Date Community Development Approval Date  
 (White: Community Development) (Canary: Applicant) (Pink: Code Enforcement)

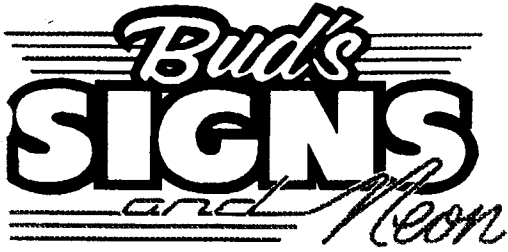

We Do Signs RIGHT!



See Sign Inventory For (A - E)

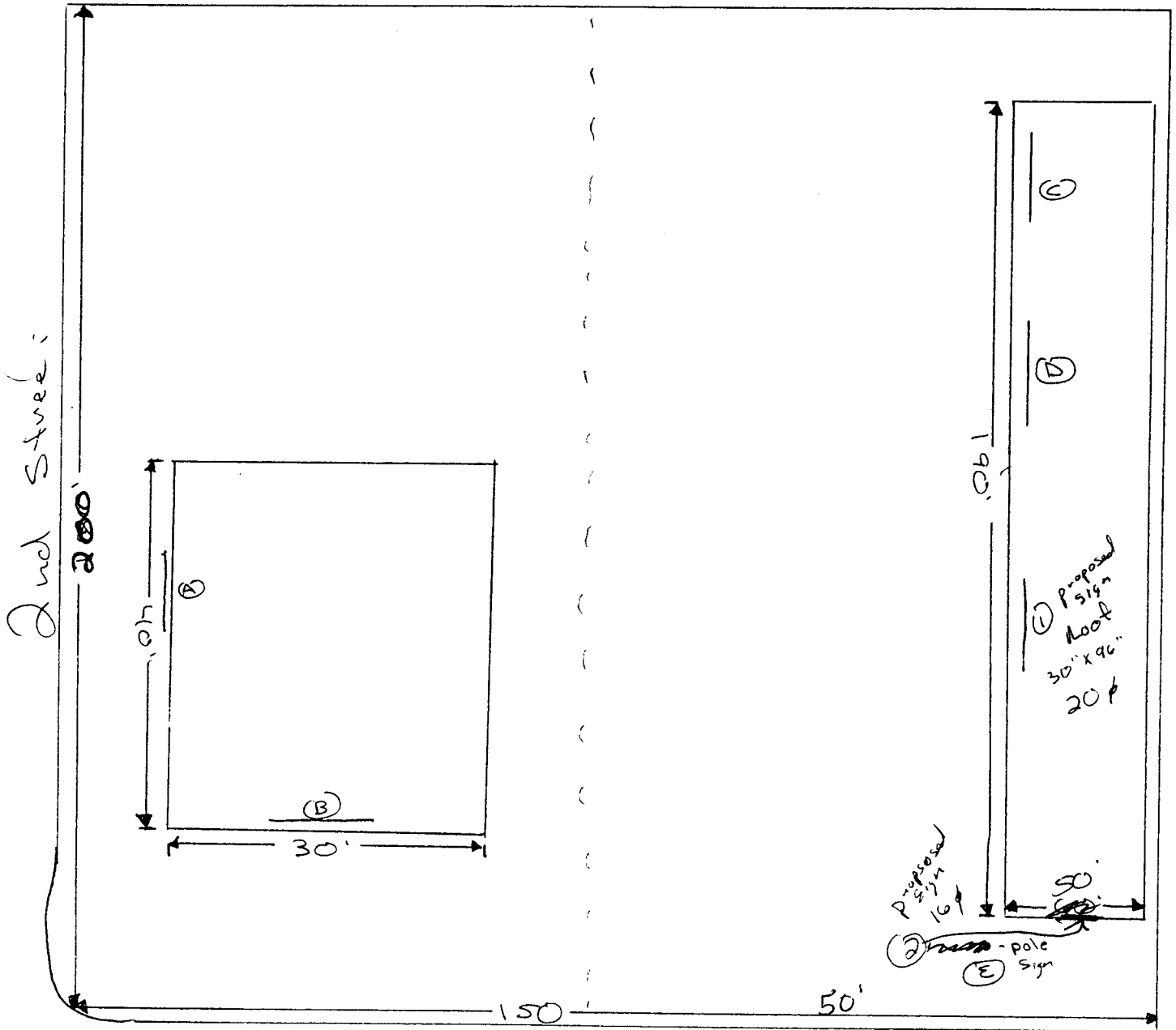

North Ave

1055 Ute Avenue • Grand Junction, Colorado 81501 • 970-245-7700

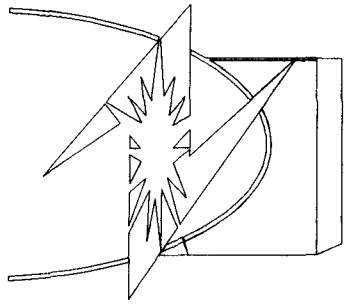

# NavStar

## MORTGAGE

---

### TODAY'S RATES

---

---

8.5% 15 YR.

---

---

10.9% 30 YR.

---