



SIGN CLEARANCE

EX

#72657

Community Development Department
250 North 5th Street
Grand Junction, CO 81501
(970) 244-1430

Clearance No. _____
Date Submitted 10-29-99
FEE \$ 15.00
Tax Schedule # 2945-154-01013
Zone C-2

BUSINESS NAME GAY Johnsons
STREET ADDRESS 333 N. 1st ST
PROPERTY OWNER GAY Johnsons INC
OWNER ADDRESS 333 N. 1st ST

CONTRACTOR Western Neon Sign
LICENSE NO. # 2990370
ADDRESS 3183 HALL AVE
TELEPHONE NO. 970 523-4045

- 1. FLUSH WALL 2 Square Feet per Linear Foot of Building Facade
- 2. ROOF 2 Square Feet per Linear Foot of Building Facade
- 3. FREE-STANDING 2 Traffic Lanes - 0.75 Square Feet x Street Frontage
4 or more Traffic Lanes - 1.5 Square Feet x Street Frontage
- 4. PROJECTING 0.5 Square Feet per each Linear Foot of Building Facade
- 5. OFF-PREMISE See #3 Spacing Requirements; Not > 300 Square Feet or < 15 Square Feet

Externally Illuminated Internally Illuminated Non-Illuminated

- (1-5) Area of Proposed Sign ~~160~~ 192 Square Feet
- (1,2,4) Building Facade 125 Linear Feet
- (1-4) Street Frontage ~~300~~ 220' Linear Feet Grand Ave
- (2-5) Height to Top of Sign 30 Feet Clearance to Grade 8+ Feet
- (5) Distance from all Existing Off-Premise Signs within 600 Feet _____ Feet

Existing Signage/Type:		
PS (A) 10' x 5' 12' x 4'	160	Sq. Ft.
FW (B) 1.5' x 9'	13.5	Sq. Ft.
ROOF (C) Grand 3' x 15'	<u>45</u>	Sq. Ft.
Total Existing:		173.5

● FOR OFFICE USE ONLY ●	
Signage Allowed on Parcel: <u>Grand Ave</u>	
Building	<u>250</u> Sq. Ft.
Free-Standing	<u>405</u> Sq. Ft.
Total Allowed:	<u>405</u> Sq. Ft.

Grand Ave only
COMMENTS: _____

NOTE: No sign may exceed 300 square feet. A separate sign clearance is required for each sign. Attach a sketch of proposed and existing signage including types, dimensions, lettering, abutting streets, alleys, easements, property lines, and locations. **A SEPARATE PERMIT FROM THE BUILDING DEPARTMENT IS REQUIRED.**

Phil Gann _____ *Patricia Pick* _____ 10-29-99
Applicant's Signature Date Community Development Approval Date

(White: Community Development) (Canary: Applicant) (Pink: Building Dept) (Goldenrod: Code Enforcement)

SPECIFICATIONS:

SIGN SIZE:

- TOTAL SIGN AREA ... 192 SQ FT
- CONOCO I.D. SIGN WEIGHT ... 300 LBS
- JOE'S MART SIGN WEIGHT ... 288 LBS
- BLIMPIES SIGN WEIGHT ... 192 LBS
- PRICE SIGN WEIGHT ... 288 LBS
- DIESEL SIGN WEIGHT ... 128 LBS
- CAR WASH SIGN WEIGHT ... 128 LBS
- READERBOARD SIGN WEIGHT ... 192 LBS
- SUPPORT POLE WEIGHT ... 1342 LBS EACH
- DESIGNED WINDLASS ... 30 PSF

ELECTRICAL:

- TOTAL AMPS ... 23.2 AMPS
- CONOCO I.D. SIGN AMPS ... 8.2 AMPS
- JOE'S MART SIGN AMPS ... 3.5 AMPS
- BLIMPIES SIGN AMPS ... 2.0 AMPS
- PRICE SIGN AMPS ... 3.5 AMPS
- DIESEL SIGN AMPS ... 2.0 AMPS
- CAR WASH SIGN AMPS ... 2.0 AMPS
- READERBOARD SIGN AMPS ... 2.0 AMPS
- CIRCUITS ... (2) 20
- VOLTS ... 120

COLORS:

- SUPPORT POLES ... KHAKI
- CABINET ... CONOCO RED, SPRAYLAT 20-3639
- POLE STRIPE & BAND ... CONOCO RED, SPRAYLAT 20-3639

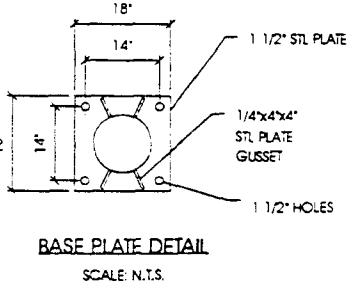
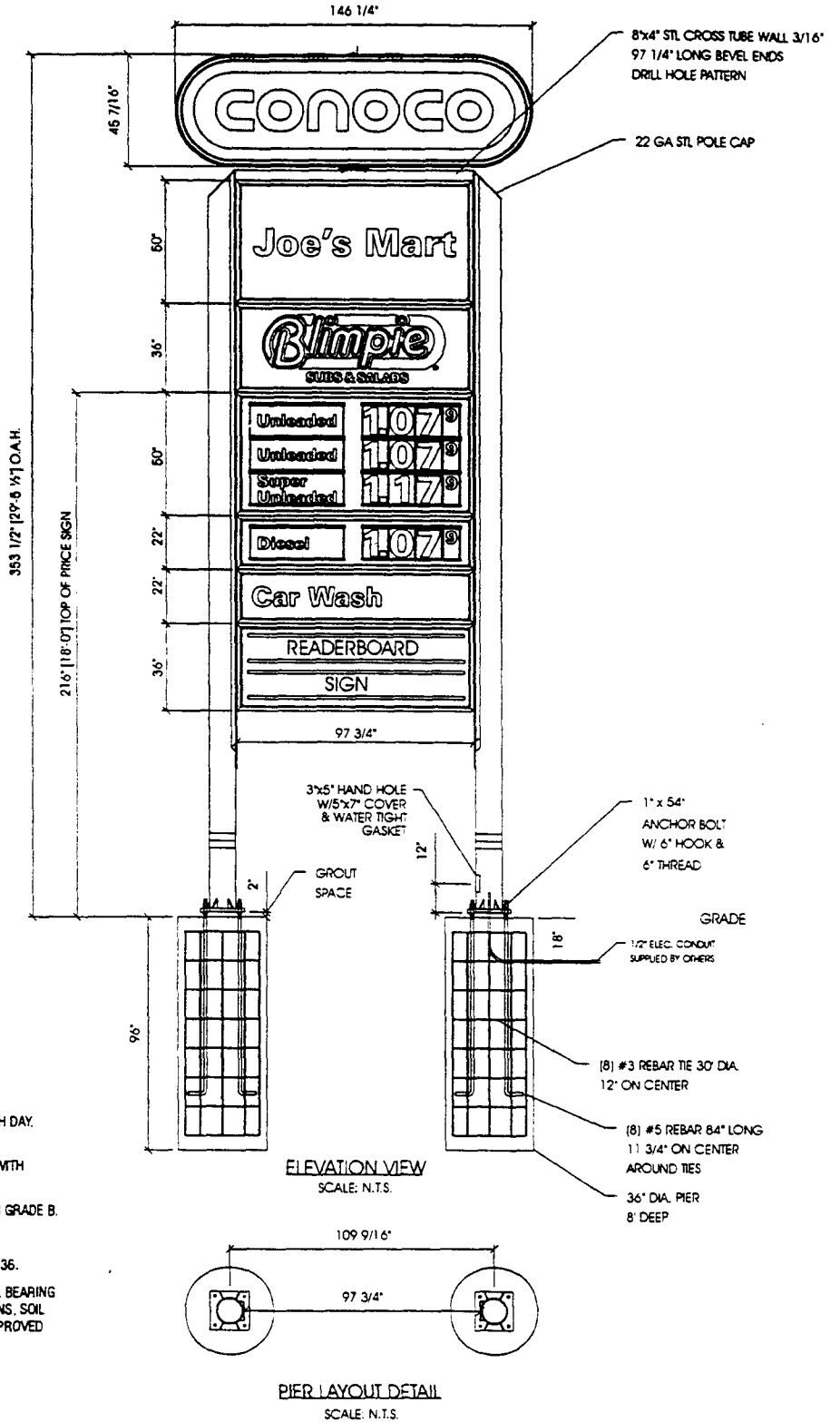

GENERAL NOTES:

1. ALL CONCRETE TO DEVELOP 3000 PSI COMPRESSIVE STRENGTH AT 28TH DAY.
2. ALL REINFORCING BARS SHALL HAVE A MINIMUM YIELD STRENGTH OF 600,000 PSI. REINFORCING BARS SHALL BE PLACED IN ACCORDANCE WITH THE LATEST VERSION OF THE ACI 318 CODE.
3. ALL PIPE SHALL MEET THE STRUCTURAL REQUIREMENTS OF ASTM A-53 GRADE B.
4. ALL STEEL TUBE SHALL BE ASTM A-500 GRADE B.
5. ALL OTHER STEEL STRUCTURAL SHAPES AND PLATE SHALL BE ASTM A-36.
6. THIS IS ONLY A SUGGESTED TYPICAL SUPPORT PIER FOR 2,500 PSF SOIL BEARING LOCATIONS. PLEASE CHECK LOCAL CODES FOR APPROVED FOUNDATIONS, SOIL BEARING AND FRDST LINE INFORMATION. FINAL DESIGN SHOULD BE APPROVED BY LOCAL ENGINEER.

DRAWING #C0971114 PAGE 3 OF 13 SALESMAN: TOM FRY DESIGNER: TMS DATE: 6-1-97	<h2 style="margin: 0;">12' SYSTEM INSTALLATION</h2>
<small>THIS DRAWING AND ALL INFORMATION CONTAINED HEREIN IS THE PROPERTY OF CONOCO AND SHALL NOT BE COPIED OR USED IN ANY WAY EXCEPT TO FULFILL THAT WHICH IT IS INTENDED. ANY MISUSE OF THIS DRAWING OR INFORMATION HEREIN MAY RESULT IN LEGAL ACTION.</small>	Zimmerman Sign Company

II. PLEASE SKETCH IN THE SPACE BELOW:

- Proposed sign dimensions (length, width, height, depth)
- Location on parcel (dimensions from streets, structures, and property lines)
- Any other signs on parcel.

Gary Johnson's
 333 N. 1st
 243-2421
 TX 2945-154-01813

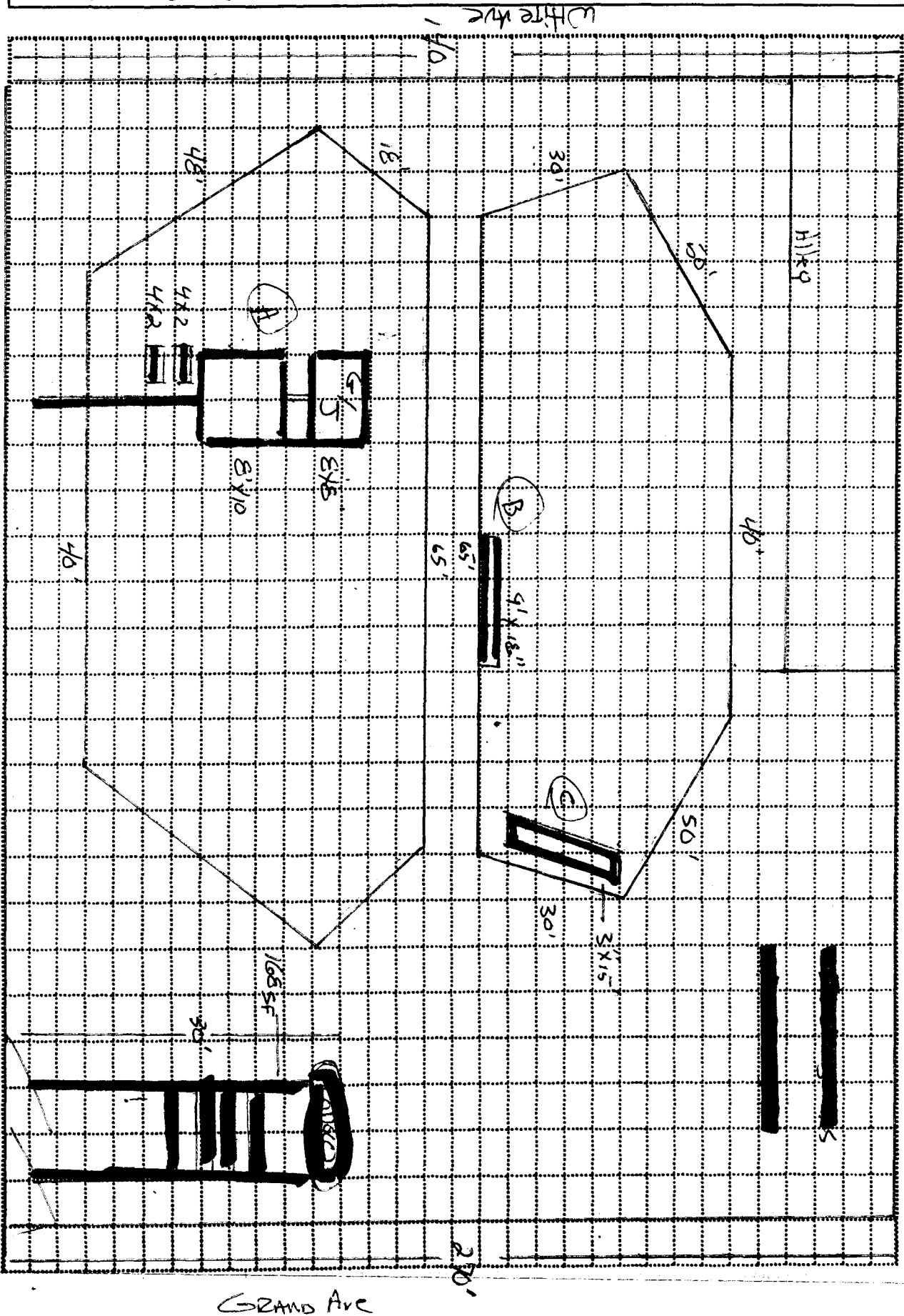

1st St

Grand Ave

