



SIGN CLEARANCE

EX

71782

Community Development Department
250 North 5th Street
Grand Junction, CO 81501
(970) 244-1430

Clearance No. _____
Date Submitted 1-6-98
FEE \$ 25.00
Tax Schedule 2945-144-07-002
Zone B-3

BUSINESS NAME K-STAR
STREET ADDRESS 660 ROAD
PROPERTY OWNER BRAD LEGGETT
OWNER ADDRESS SAME

CONTRACTOR Bud's SIGNS
LICENSE NO. 2980109
ADDRESS 1055 UTE AVE.
TELEPHONE NO. 245-7700

- 1. FLUSH WALL 2 Square Feet per Linear Foot of Building Facade
- 2. ROOF 2 Square Feet per Linear Foot of Building Facade
- 3. FREE-STANDING 2 Traffic Lanes - 0.75 Square Feet x Street Frontage
4 or more Traffic Lanes - 1.5 Square Feet x Street Frontage
- 4. PROJECTING 0.5 Square Feet per each Linear Foot of Building Facade
- 5. OFF-PREMISE See #3 Spacing Requirements; Not > 300 Square Feet or < 15 Square Feet

Externally Illuminated Internally Illuminated Non-Illuminated

- (1 - 5) Area of Proposed Sign 83 Square Feet
- (1,2,4) Building Facade 50 Linear Feet
- (1 - 4) Street Frontage 135 Linear Feet
- (2,4,5) Height to Top of Sign 18 Feet Clearance to Grade 10 Feet
- (5) Distance from all Existing Off-Premise Signs within 600 Feet Feet

| Existing Signage/Type: | |
|------------------------|-------------------|
| <u>1 FLUSH WALL</u> | <u>24</u> Sq. Ft. |
| | <u>1</u> Sq. Ft. |
| | <u>1</u> Sq. Ft. |
| Total Existing: | <u>24</u> Sq. Ft. |

| ● FOR OFFICE USE ONLY ● | |
|--|----------------------|
| Signage Allowed on Parcel: <u>7th Street</u> | |
| Building | <u>100</u> Sq. Ft. |
| Free-Standing | <u>202.5</u> Sq. Ft. |
| Total Allowed: | <u>202.5</u> Sq. Ft. |

COMMENTS: Replace existing freestanding sign.

NOTE: No sign may exceed 300 square feet. A separate sign clearance is required for each sign. Attach a sketch of proposed and existing signage including types, dimensions, lettering, abutting streets, alleys, easements, property lines, and locations. **A SEPARATE PERMIT FROM THE BUILDING DEPARTMENT IS REQUIRED.**

[Signature] 1/6/99 [Signature] 1-6-99
 Applicant's Signature Date Community Development Approval Date

(White: Community Development) (Canary: Applicant) (Pink: Building Dept) (Goldenrod: Code Enforcement)



18'-0" OVER AIR

10'-0"

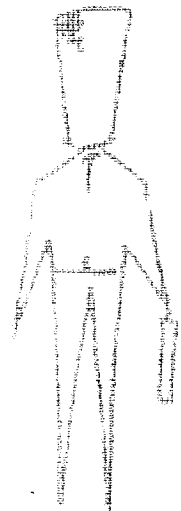
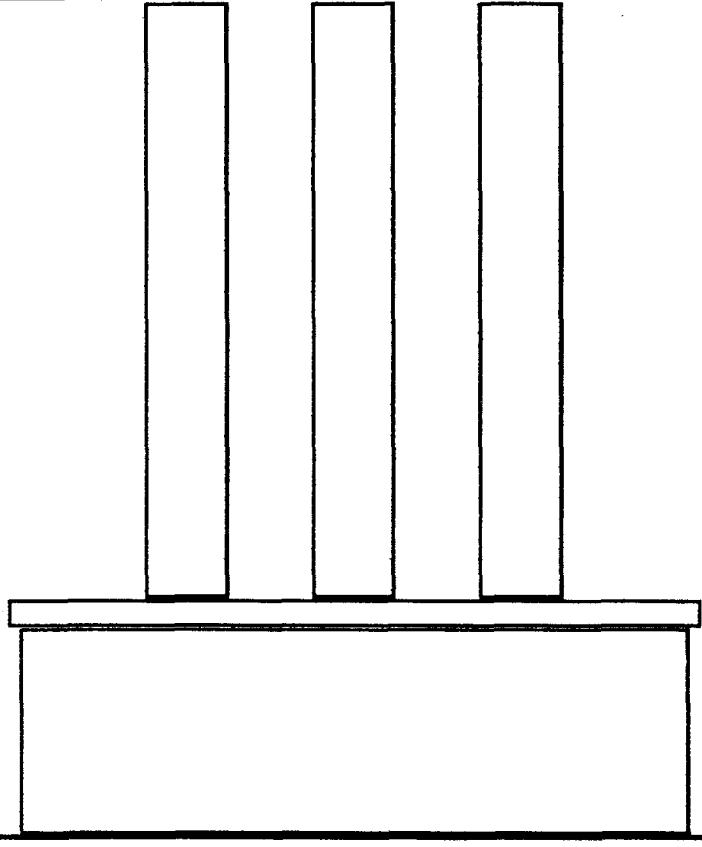

SIGN / MARQUE DISPLAY
8'-3" X 10'-0"



DESIGN PROPERTY OF
Bud's
SIGNS
970-245-7700

Bud's SIGNS and Neon

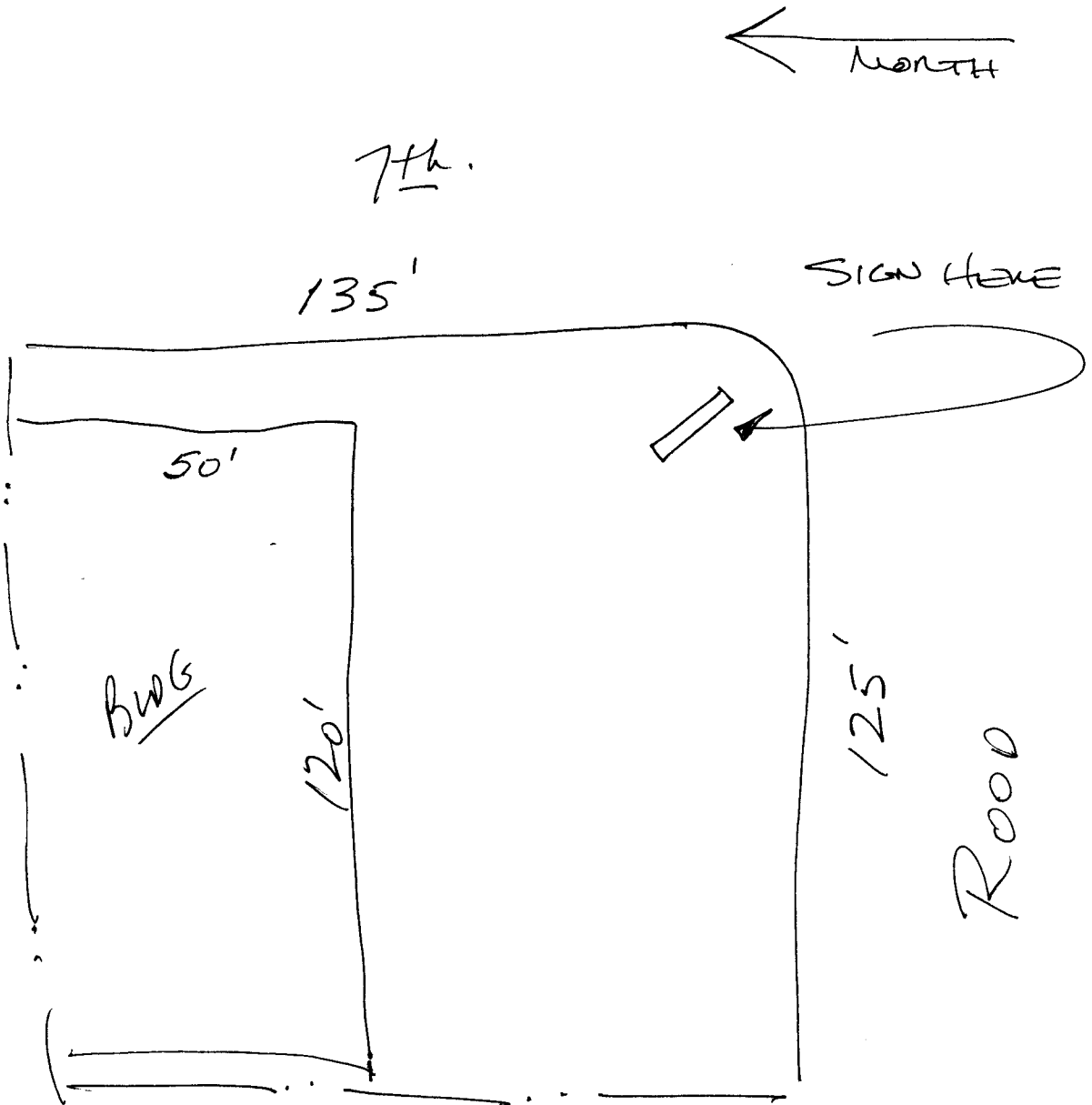

1055 UTE AVE. GRAND JUNCTION COLORADO 81501 970-245-7700